



City of Tampa

Jane Castor, Mayor

Contract Administration
Michael W. Chucran, Director

306 East Jackson Street, 4N
Tampa, FL 33602

Office (813) 274-8116

Fax: (813) 274-7368

ADDENDUM 2

Via E-Mail

DATE: October 30, 2020

Contract 20-C-00039; ARMENIA AVE AT BUSCH BLVD INTERSECTION IMPROVEMENTS

Bidders on the above referenced project are hereby notified that the following addendum is made to the Contract Documents. BIDS TO BE SUBMITTED SHALL CONFORM TO THIS NOTICE.

Item 1: Add the attached Signalization plans and the Signing and Pavement Marking plans to the Roadway plans set. The signalization plans and the Signing & Pavement Marking Plans were missing from the originally posted bid documents

All other provisions of the Contract Documents and Specifications not in conflict with this Addendum shall remain in full force and effect. Questions are to be e-mailed to Contract Administration@tampagov.net.

Jim Greiner

Jim Greiner, P.E., Contract Management Supervisor

**CITY OF TAMPA
TRANSPORTATION DIVISION**

CONTRACT PLANS

CITY OF TAMPA PROJECT NO. 0000005
CONTRACT NO. 12-D-00057
FINANCIAL PROJECT ID 437044-1-58-01
ARMENIA AVENUE AT BUSCH BOULEVARD

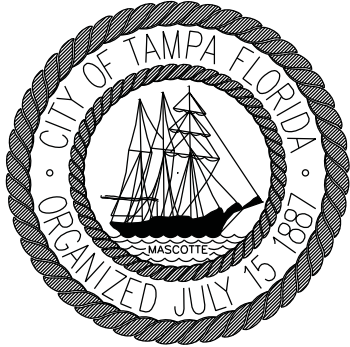

INDEX OF SIGNALIZATION PLANS

SHEET NO.	SHEET DESCRIPTION
T-1	KEY SHEET
T-2	SIGNATURE SHEET
T-3	TABULATION OF QUANTITIES
T-4	GENERAL NOTES
T-5 TO T-6	SIGNALIZATION PLANS
T-7	CONCRETE STRAIN POLE SCHEDULE
T-8	SOIL BORINGS FOR SIGNAL POLES

SIGNAL SHOP DRAWINGS
TO BE SUBMITTED TO:

PHUC H. DUONG, P.E.
GANNETT FLEMING, INC.
9119 CORPORATE LAKE DR., SUITE 150
TAMPA, FL 33634

SIGNALIZATION PLANS PREPARED BY:

Gannett Fleming

9119 CORPORATE LAKE DR, SUITE 150
TAMPA, FL 33634
TEL: (813) 882-4366
Certificate of Authorization: No. 5564

NOTE: THE SCALE OF THESE PLANS MAY
HAVE CHANGED DUE TO REPRODUCTION.

KEY SHEET REVISIONS	
DATE	DESCRIPTION

SIGNALIZATION PLANS
ENGINEER OF RECORD: PHUC H. DUONG

P.E. NO.: 63835

FISCAL YEAR	SHEET NO.
21	T-1

CITY OF TAMPA PROJECT MANAGER: NINA MABILLEAU, E.I.

THE OFFICIAL RECORD OF THIS SHEET IS THE ELECTRONIC FILE DIGITALLY SIGNED AND SEALED UNDER RULE 61G15-23.004, F.A.C.

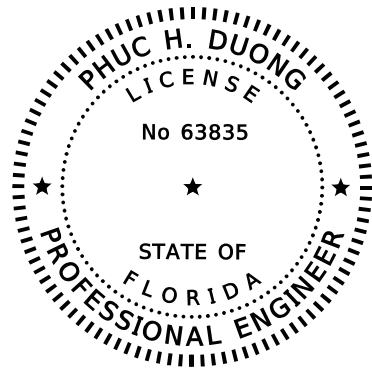

THIS ITEM HAS BEEN DIGITALLY
SIGNED AND SEALED BY
Phuc H Duong
2020.08.03 18:02:28 -04'00'

ON THE DATE ADJACENT TO THE SEAL.

PRINTED COPIES OF THIS DOCUMENT ARE
NOT CONSIDERED SIGNED AND SEALED
AND THE SIGNATURE MUST BE VERIFIED
ON ANY ELECTRONIC COPIES.

GANNETT FLEMING, INC.
9119 CORPORATE LAKES DR., SUITE 150
TAMPA, FL 33634
CERTIFICATE OF AUTHORIZATION 5564
PHUC H. DUONG, P.E., NO. 63835

THE ABOVE NAMED PROFESSIONAL ENGINEER SHALL BE RESPONSIBLE FOR THE
FOLLOWING SHEETS IN ACCORDANCE WITH RULE 61G15-23.004, F.A.C.

SIGNALIZATION PLANS

SHEET NO.	SHEET DESCRIPTION
T-1	KEY SHEET
T-2	SIGNATURE SHEET
T-3	TABULATION OF QUANTITIES
T-4	GENERAL NOTES
T-5	SIGNALIZATION PLAN
T-6	SIGNALIZATION PLAN

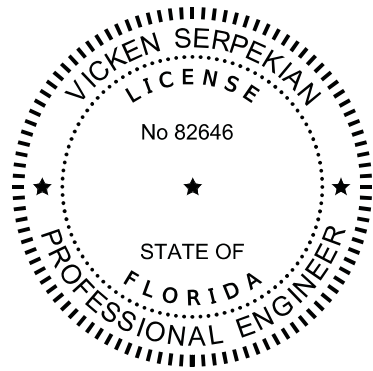

THIS ITEM HAS BEEN DIGITALLY
SIGNED AND SEALED BY
Vicken Serpekian
2020.09.14 14:32:15-04'00'

ON THE DATE ADJACENT TO THE SEAL.

PRINTED COPIES OF THIS DOCUMENT ARE
NOT CONSIDERED SIGNED AND SEALED
AND THE SIGNATURE MUST BE VERIFIED
ON ANY ELECTRONIC COPIES.

ELEMENT ENGINEERING GROUP
1713 E. 9TH AVENUE
TAMPA, FL 33605
CERTIFICATE OF AUTHORIZATION 26921
VICKEN SERPEKIAN, P.E., NO. 82646

THE ABOVE NAMED PROFESSIONAL ENGINEER SHALL BE RESPONSIBLE FOR THE
FOLLOWING SHEETS IN ACCORDANCE WITH RULE 61G15-23.004, F.A.C.

STRUCTURES PLANS

SHEET NO.	SHEET DESCRIPTION
T-2	SIGNATURE SHEET
T-7	CONCRETE STRAIN POLE SCHEDULE

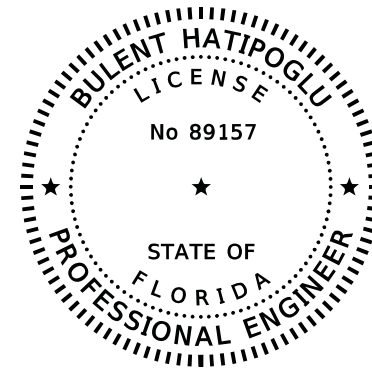

THIS ITEM HAS BEEN DIGITALLY
SIGNED AND SEALED BY
Bulent Hatipoglu
2020.09.14
10:38:59 -04'00'

ON THE DATE ADJACENT TO THE SEAL.

PRINTED COPIES OF THIS DOCUMENT ARE
NOT CONSIDERED SIGNED AND SEALED
AND THE SIGNATURE MUST BE VERIFIED
ON ANY ELECTRONIC COPIES.

MC SQUARED, INC.
5808-A BRECKENRIDGE PARKWAY
TAMPA, FLORIDA 33610
CERTIFICATE OF AUTHORIZATION 9191
BULENT HATIPOGLU, P.E., NO. 89157

THE ABOVE NAMED PROFESSIONAL ENGINEER SHALL BE RESPONSIBLE FOR THE
FOLLOWING SHEETS IN ACCORDANCE WITH RULE 61G15-23.004, F.A.C.

GEOTECHNICAL PLANS

SHEET NO.	SHEET DESCRIPTION
T-2	SIGNATURE SHEET
T-8	SOIL BORINGS FOR SIGNAL POLES

REVISIONS				Gannett Fleming 9119 CORPORATE LAKE DR, SUITE 150 TAMPA, FL 33634 TEL: 813-882-4366 Certificate of Authorization: No. 5564 Phuc H Duong, P.E. No. 63835	CITY OF TAMPA TRANSPORTATION DIVISION CONTRACT NO: 12-D-00057 ARMENIA AVENUE INTERSECTION PROJECT AT SR 580/BUSCH BLVD.	SHEET NO. SIGNATURE SHEET T-2
DATE	DESCRIPTION	DATE	DESCRIPTION			

TABULATION OF QUANTITIES

PAY ITEM NO.	DESCRIPTION	UNIT	SHEET NUMBERS														TOTAL THIS SHEET		GRAND TOTAL	
			T-5																	
			PLAN	FINAL	PLAN	FINAL	PLAN	FINAL	PLAN	FINAL	PLAN	FINAL	PLAN	FINAL	PLAN	FINAL	PLAN	FINAL	PLAN	FINAL
630-2-11	CONDUIT / F&I (OPEN TRENCH-UNDERGROUND) - 1-2" CONDUITS	LF	81														81		81	
630-2-11	CONDUIT / F&I (OPEN TRENCH-UNDERGROUND) - 2-2" CONDUITS	LF	255														255		255	
630-2-12	CONDUIT / F&I (DIRECTIONAL BORE) 4-2" CONDUITS	LF	215														215		215	
630-2-12	CONDUIT / F&I (DIRECTIONAL BORE) 5-2" CONDUITS	LF	120														120		120	
630-2-14	CONDUIT / F&I (ABOVE GROUND) 1-2" RISER (10' SECTION)	LF	20														20		20	
632-7-1	SINGLE CABLE / F&I	PI	1														1		1	
632-7-6	SIGNAL CABLE REMOVAL	PI	1														1		1	
633-8-1	MULTI-CONDUCTOR COMMUNICATIONS CABLE	LF	199														199		199	
634-4-153	SPAN WIRE ASSEMBLY / F&I (TWO POINT) (BOX SPAN)	PI	1														1		1	
634-5-1	FIBERGLASS INSULATOR	LF	48														48		48	
635-2-11	PULL & SPLICE BOX / F&I (13X24)	EA	12														12		12	
635-2-12	PULL & SPLICE BOX / F&I (24X36)	EA	2														2		2	
639-1-122	ELECTRICAL POWER SERVICE (UNDERGROUND- PURCHASED BY CONTRACTOR) / F&I	AS	1														1		1	
639-2-1	ELECTRICAL SERVICE WIRE / F&I	LF	35														35		35	
639-3-11	ELECTRICAL SERVICE DISCONNECT / F&I (POLE)	EA	1														1		1	
641-2-11	PRESTRESSED CONCRETE POLE / F&I (TYPE P-11 PEDESTAL)	EA	1														1		1	
641-2-16	PRESTRESSED CONCRETE POLE / F&I (TYPE P-V1)	EA	4														4		4	
641-2-70	PRESTRESSED CONCRETE POLE REMOVAL -(SHALLOW)	EA	2														2		2	
646-1-11	ALUMINUM SIGNAL POLE / F&I (PEDESTAL)	EA	8														8		8	
646-1-60	ALUMINUM SIGNAL PEDESTAL REMOVAL	EA	8														8		8	
650-1-14	VEHICULAR TRAFFIC SIGNAL / F&I-ALUMINUM (3 SECTION, 1 WAY)	AS	8														8		8	
650-1-14	VEHICULAR TRAFFIC SIGNAL / F&I-ALUMINUM (3 SECTION, 1 WAY, ARROW)	AS	2														2		2	
650-1-16	VEHICULAR TRAFFIC SIGNAL / F&I-ALUMINUM (4 SECTION, 1 WAY, ARROW)	AS	2														2		2	
653-1-11	PEDESTRIAN SIGNAL / F&I LED COUNTDOWN (1 WAY)	AS	8														8		8	
660-3-11	VEHICLE DETECTION SYSTEM - MICROWAVE (CABINET EQUIPMENT) /F&I	EA	4														4		4	
660-3-12	VEHICLE DETECTION SYSTEM - MICROWAVE (ABOVE GROUND EQUIPMENT) /F&I	EA	4														4		4	
665-1-12	PEDESTRIAN DETECTOR / F&I (ACCESSIBLE)	EA	8														8		8	
670-5-112	TRAFFIC CONTROLLER ASSEMBLY / F&I (NEMA) (2 PREEMPTION PLAN)	AS	1														1		1	
670-5-600	TRAFFIC CONTROLLER ASSEMBLY REMOVAL	AS	1														1		1	
685-1-13	UPS -(LINE INTERACTIVE INCLUDE SEPARATE CABINET)/ F&I	EA	1														1		1	
700-5-50	INTERNALLY ILLUM. SIGN (RELOCATE)	EA	4														4		4	
700-11-391	ELECTRONIC DISPLAY SIGN / F&I (OVERHEAD) (BLANK-OUT) (UP TO 12 SQFT)	AS	1														1		1	

REVISIONS			
DATE	DESCRIPTION	DATE	DESCRIPTION

Gannett Fleming
 9119 CORPORATE LAKE DR, SUITE 150
 TAMPA, FL 33634
 TEL: 813-882-4366
 Certificate of Authorization: No. 5564
 Phuc H Duong, P.E. No. 63835

CITY OF TAMPA
 TRANSPORTATION DIVISION
 CONTRACT NO: 12-D-00057
 ARMENIA AVENUE INTERSECTION PROJECT
 AT SR 580/BUSCH BLVD.

TABULATION OF QUANTITIES

SHEET NO.
 T-3

THE OFFICIAL RECORD OF THIS SHEET IS THE ELECTRONIC FILE DIGITALLY SIGNED AND SEALED UNDER RULE 61G15-23.004, F.A.C.

SIGNALIZATION

1. TRAFFIC SIGNAL OPERATIONS:
THE MAJOR STREET IS BUSCH BOULEVARD MOVEMENTS 2 AND 6.
THE MINOR STREET IS ARMENIA AVENUE MOVEMENTS 4 AND 8.

CONCURRENT/ACTUATED PEDESTRIANS FOR MOVEMENT 2 (P2) AND 6 (P6).

FLASHING OPERATION IS RED ALONG BUSCH BOULEVARD
AND RED ALONG ARMENIA AVENUE.

2. SIGNAL TIMINGS SHALL BE FURNISHED BY THE CITY OF TAMPA.

3. ALL TRAFFIC SIGNAL HEADS MUST BE FDOT CERTIFIED, CAST ALUMINUM RED SECTION WITH POLYCARBONATE AMBER AND GREEN SECTIONS, WITH STAINLESS STEEL HARDWARE, GLASS LENSES, BACK PLATES AND TUNNEL VISORS. ALL SIGNAL INDICATIONS SHALL BE AN L.E.D. INDICATION. ALL LED SIGNAL HEADS SHALL MEET CITY SPECIFICATIONS.

4. CONTRACTOR TO CONTACT CITY OF TAMPA TRAFFIC SIGNAL SUPERINTENDENT FOR CABLE SPECIFICATIONS BEFORE ORDERING CABLE FOR THE PROJECT. 813-951-2915.

5. ALL PEDESTRIAN SIGNAL HEADS MUST BE FDOT CERTIFIED COUNT DOWN HEADS, WITH CAST ALUMINUM HOUSING, USING LED INTERNATIONAL SYMBOLS, MEETING CITY OF TAMPA SPECIFICATIONS AND ALL PUSH BUTTONS SHALL BE WIRED SEPARATELY USING LOW VOLTAGE BELDON WIRE PLACED IN SEPARATE LOW VOLTAGE CONDUIT OR LOW VOLTAGE PULL BOX. LATCHING PUSH BUTTON [CITY PROJECTS ONLY: INCIDENTAL EQUIPMENT FOR THIS UNIT AND COST WILL BE INCLUDED UNDER THIS PAY ITEM NUMBER] MUST INCLUDE VISUAL INDICATION OF ACTUATION AND SHALL REMAIN ILLUMINATED UNTIL THE PEDESTRIAN WALK INDICATION IS DISPLAYED. PUSH BUTTON SHALL HAVE A TACTILE ARROW. MUST HAVE AN EXACT COUNT OF LEFT, RIGHT OR UPWARD TACTILE ARROW BUTTONS AND ALL MUST BE ALIGNED WITH AND POINTING AT THE DESIGNATED PEDESTRIAN RAMP. BUTTON MUST BE MOUNTED SO SPEAKER IS FACING DOWN. INCIDENTAL EQUIPMENT AND COST FOR THIS UNIT SHALL BE INCLUDED IN PAY ITEM 665-1-12.

6. VERTICAL CLEARANCE ON TRAFFIC SIGNAL HEADS SHALL MEET FDOT STANDARDS, 17'-6" TO 19'-0".

7. CONTRACTOR SHALL CONTACT THE CITY TO REQUEST A GENERAL CONTRACTORS PACKAGE FOR SPECIFICS ON WIRING AND OTHER GENERAL INFORMATION.

8. THE CONTRACTOR SHALL NOTIFY THE CITY OF TAMPA TRAFFIC SIGNAL SUPERINTENDENT AT LEAST 24 HOURS IN ADVANCE OF ANY SIGNAL RELATED WORK. FAILURE TO PROVIDE THIS NOTICE MAY RESULT IN REJECTION OF ALL UNINSPECTED WORK.

9. THE CONTRACTOR SHALL NOTIFY TAMPA ELECTRIC COMPANY (CONTACT TECO FOR REQUIRED TIME FRAME) IN ADVANCE OF SETTING ANY POLE WHERE CONFLICT WITH AN OVERHEAD ELECTRICAL CONDUCTOR EXISTS AND IN ALL CASES WHERE JOINT USE POLES ARE CALLED FOR ON THE PLANS.

IN AREAS OF LIMITED OVERHEAD CLEARANCE CONTRACTOR IS TO USE A LOW PROFILE DRILL RIG.

10. CONTACT THE CITY OF TAMPA SIGNAL SHOP FOR THE TYPE AND MAKE OF METER RING CAN AND SERVICE DISCONNECT BREAKER BOX TO USE.

11. TRAFFIC SIGNAL CABLE PROVIDING POWER TO VEHICULAR SIGNAL HEADS SHALL NOT BE INSTALLED IN THE SAME CONDUIT CONTAINING DETECTOR CABLES.

12. THE VEHICULAR DETECTION SYSTEM SHALL UTILIZE WAVETRONIX SMART SENSOR MATRIX RADAR PRESENCE DETECTORS (RPD). CONTACT RICHARD ALLEN WITH WAVETRONIX 407-520-0708 FOR GUIDANCE REGARDING OPTIMUM UNIT MOUNTING LOCATIONS THROUGHOUT THE INTERSECTION.

13. DISCONNECT HANGARS OR ASTRO BRACKETS SHALL BE FDOT CERTIFIED AND MEET CITY OF TAMPA SPECIFICATIONS. DISCONNECT WIRING SHALL MEET CITY STANDARDS. CONTACT TRAFFIC SIGNAL SUPERINTENDENT FOR DISCONNECT WIRING STANDARDS AT 813-951-2915.

14. THE CONTRACTOR IS TO DE-WATER FOUNDATION EXCAVATION IF THE ELEVATION OF GROUND WATER IS HIGHER THAN THE ELEVATION OF THE FOUNDATION BASE.

15. ELECTRICAL SERVICE AUTHORIZATION AND SERVICE RELEASE MUST BE COORDINATED IN ADVANCE THROUGH THE TRAFFIC OPERATIONS CHIEF. CONTACT THE TRAFFIC SIGNAL SUPERINTENDENT FOR INSTRUCTIONS AT 813-951-2915. ALL TECO ELECTRICAL SERVICE FEES SHALL BE INCLUDED AS PART OF THE SIGNAL COST. NO ADDITIONAL COMPENSATION WILL BE PROVIDED.

SIGNALIZATION

16. WHEN A CONTRACTOR IS DOING SIGNAL WORK IN AN INTERSECTION WHERE A LANE IS CLOSED, THE PROJECT ENGINEER MAY REQUIRE AN OFF-DUTY LAW ENFORCEMENT OFFICER TO DIRECT TRAFFIC. THE HOURLY RATE OF PAY FOR AN OFF-DUTY LAW ENFORCEMENT OFFICER CAN BE OBTAINED FROM THE OFFICE OF THE LAW ENFORCEMENT OFFICER. THIS IS IN ADDITION TO PROPER MAINTENANCE OF TRAFFIC.

17. THE PROPOSED CONTROLLER SHALL BE COBALT AND SHALL BE COMPATIBLE WITH ECONOLITE CENTRACS CENTRAL CONTROL SOFTWARE .

SIGNAL PLANS SET

1. THE CONTRACTOR SHALL SUBMIT MARKED-UP AS-BUILT PLANS IN ELECTRONIC FORMAT TO THE ENGINEER FOR FINAL ACCEPTANCE.

2. THE HORIZONTAL DATUM IS ON THE NORTH AMERICAN DATUM OF 1983/2011 ADJUSTMENT. BENCHMARK ELEVATIONS SHOWN ON THE PLANS ARE NORTH AMERICAN VERTICAL DATUM OF 1988 (NAVD 88).

3. EXISTING DRAINAGE STRUCTURES WITHIN CONSTRUCTION LIMITS SHALL REMAIN UNLESS OTHERWISE NOTED.

4. EXISTING UTILITIES ARE TO REMAIN IN PLACE UNLESS OTHERWISE NOTED.

5. THE CONTRACTOR SHALL COORDINATE WITH TAMPA AIRPORT PIPELINE CORPORATION WHEN WORKING IN THE VICINITY OF THEIR LINE.

CONTROLLER

1. PAY ITEM 670-5-112 SHALL INCLUDE ALL COSTS ASSOCIATED WITH FURNISHING AND INSTALLING A FULLY LOADED TS2 TYPE-1, SIZE P-44 CONTROLLER CABINET ASSEMBLY WITH:

- AN EIGHT PHASE BACKPLANE
- MINIMUM SIXTEEN LOAD BAY POSITIONS
- NO PAINT OUTSIDE, WHITE PAINT INSIDE
- GPS CLOCK SYNC
- TWO QUAD OUTLETS
- ONE DUPLEX GFI
- WALL-MOUNT PATCH PANEL (12X SINGLE MODE WITH SC-CONNECTORS)
- ETHERNET EDGE SWITCH
- CONTROLLER WITH CENTRAL 51SOFTWARE LICENSE COMPATIBLE WITH THE CITY'S CENTRACS TRAFFIC CONTROL SYSTEM AND MMU.

THE CONTRACTOR SHALL NOTIFY THE CITY OF TAMPA SIGNAL SHOP AND FDOT DISTRICT SEVEN TRAFFIC OPERATIONS AT LEAST 48 HOURS IN ADVANCE OF TURNING ON A NEW OR MODIFIED CONTROLLER CABINET ASSEMBLY.

2. THE CONTROLLER DOOR SHALL OPEN AWAY FROM THE STREET.

3. THE TECHNICIAN SLAB SHALL BE A MAXIMUM OF 4" BELOW THE TOP OF THE CONCRETE PAD, THIS MUST INCLUDE ADDITIONAL COST OF LABOR, CONCRETE AND OTHER MATERIALS FOR CONTROLLER BASE, PAD AND STEPS AS ONE UNIT. CONSTRUCT CONCRETE BASE FOR THE TYPE 5 CABINET PER INDEX 17841 WITH THE FOLLOWING EXCEPTIONS:

- A. THE REQUIRED BASE DIMENSIONS ARE 30"D X 48"W X 36"H.
- B. CONDUITS AND PULL BOXES, IN ADDITION TO THOSE SHOWN IN THE PLANS, ARE NOT REQUIRED.
- C. THE DESIGN REQUIRES 1' OF THE BASE BE ABOVE THE FINISHED GRADE AND 2' OF THE BASE BELOW THE FINISHED GRADE.
- D. THE TOP OF CONTROLLER BASE FOUNDATION ELEVATION SHALL BE LEVEL WITH THE CROWN OF THE ROAD.

4. THE UPS ASSEMBLY SHALL BE MOUNTED ON SEPARATE GROUND MOUNT TYPE IV CABINET ADJACENT TO THE TRAFFIC CONTROLLER CABINET. CONCRETE BASE IS INCLUDED IN COST OF UPS ASSEMBLY. UPS CONTROLLER SHALL HAVE SNMP CAPABILITY, GEL-CORE BATTERIES, TRANSFER SWITCH AND GENERATOR PLUG.

CONDUIT

1. CONDUIT SHALL BE INSTALLED, BACKFILLED, AND RESTORED IN ACCORDANCE WITH APPLICABLE STANDARDS AND/OR AS INSTRUCTED BY THE GOVERNING/PERMITTING AGENCY. MINIMUM DEPTH OF CONDUIT SHALL BE 36".

2. TS-2 TYPE 1 CONTROLLER BASE SHALL CONTAIN A MIN. OF FOUR CONDUITS AND BE AN OPEN TYPE TO ALLOW FOR ADDING CONDUITS. UNUSED CONDUITS ARE TO BE CAPPED IN THE CABINET AND STUBBED INTO NEAREST SIGNAL PULLBOX.

3. ALL CONDUIT SHALL BE 2" PVC MIN., UNLESS OTHERWISE SPECIFIED.

4. THE TERMINATION ENDS OF ALL POLYVINYL CHLORIDE (PVC) PLASTIC CONDUIT ENTERING ALL PULLBOXES AND CABINET BASES SHALL BE FITTED WITH AN END BELL DUCT FITTING PRIOR TO ANY PULL-LINE OR CABLE INSTALLATION.

5. NEPT INC. MULE TAPE # 1250 P3 MF 11.75 FX 9.5 1250 LB AND A 14 GAUGE XHHW WIRE FOR TRACING OR APPROVED EQUAL SHALL BE INSTALLED IN ALL CONDUITS WHICH ARE TO RECEIVE CABLE AT A FUTURE TIME. AT LEAST THREE FEET OF PULL-LINE SHALL BE ACCESSIBLE AT EACH CONDUIT TERMINATION AND SECURED WITHIN THE PULLBOX OR PLACE OF TERMINATION.

6. DETECTABLE LOCATING TAPE SHALL BE PLACED OVER THE CENTERLINE OF ALL PVC PIPES AT ONE FOOT BELOW GRADE. PAYMENT FOR DETECTABLE TAPE IS INCLUDED IN THE PAY ITEM FOR CONDUIT.

7. IT SHOULD BE NOTED THAT NO TEST BORINGS WERE MADE WHERE CONDUIT RUNS ARE TO BE INSTALLED BY JACKING OR TRENCHING.

8. ALL CONDUIT WITH PULL-LINE INSTALLED SHALL BE SEALED AND CAPPED TO AVOID DEBRIS AND SOIL FROM ENTERING DURING CONSTRUCTION.

9. CONDUIT TRENCH UNDER PAVEMENT SHALL BE STABILIZED WITH 12" OF TYPE "C" STABILIZATION. PAYMENT SHALL BE INCLUDED IN PAY ITEM "CONDUIT (UNDER PAVEMENT)" AND NO OTHER ADDITIONAL COMPENSATION WILL BE PROVIDED.

10. PULLBOXES SHALL BE "CHRISTY FIBERLITE" AND SHALL BE OF A PRODUCT SERIES EQUIVALENT FOR PULLING COPPER OR FIBER OPTIC CABLE. GROUNDING FOR PULLBOXES SHALL BE INCLUDED IN THIS PAY ITEM.

11. ALL CONDUITS ARE TO HAVE BELL FITTINGS.

12. LENGTHS FOR CONDUITS DO NOT INCLUDE VERTICAL LENGTHS ALONG POLES.

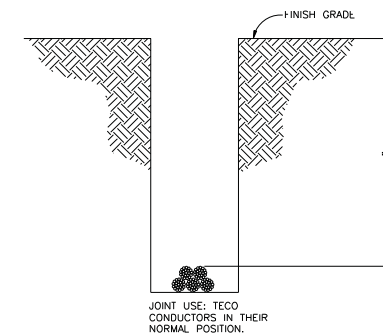

TRENCHING DETAIL FOR CONDUIT
NOT TO SCALE

REVISIONS				Gannett Fleming 9119 CORPORATE LAKE DR, SUITE 150 TAMPA, FL 33634 TEL: 813-882-4366 Certificate of Authorization: No. 5564 Phuc H Duong, P.E. No. 63835	CITY OF TAMPA TRANSPORTATION DIVISION CONTRACT NO: 12-D-00057 ARMENIA AVENUE INTERSECTION PROJECT AT SR 580/BUSCH BLVD.		SHEET NO. T-4
DATE	DESCRIPTION	DATE	DESCRIPTION		GENERAL NOTES		

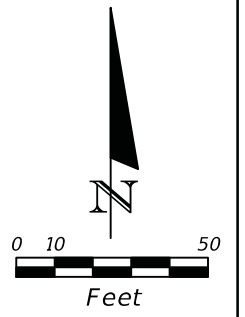
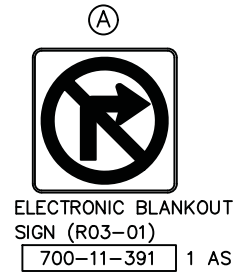
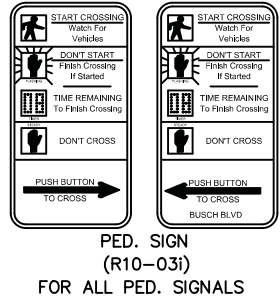
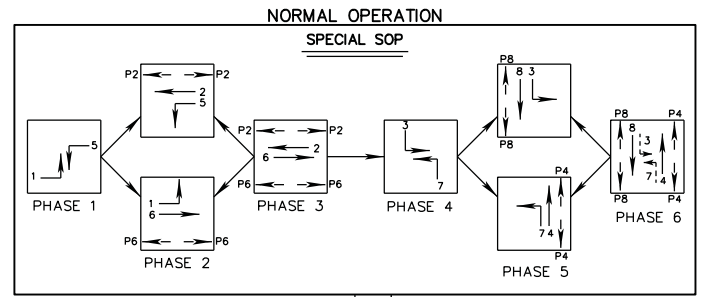
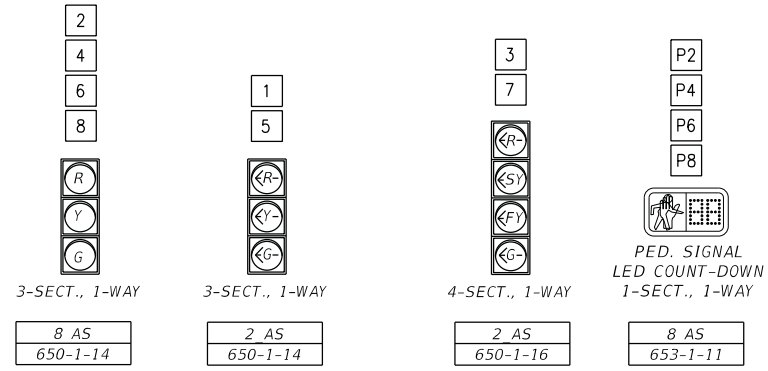

REMOVAL ITEMS	QTY
632-7-6	1 PI
641-2-70	2 EA
646-1-60	8 EA
670-5-600	1 AS

CONTROLLER NOTES:

- MAJOR STREET IS SR 580 (BUSCH BLVD), PHASE 3 (MOVEMENT 2 AND 6).
- MINOR STREET IS N ARMENIA AVE, PHASE 6 (MOVEMENTS 4 AND 8).
- SPECIAL OPERATION PLAN WITH THE FOLLOWING:
 - CONCURRENT PEDESTRIANS FOR MOVEMENTS 2 (P2), AND 6 (P6).
 - ACTUATED PEDESTRIANS FOR MOVEMENTS 4 (P4), AND 8 (P8).
- REDIRECT EXISTING RAILROAD PRE-EMPTION CABLE FROM EXISTING TO NEW CABINET VIA OVERHEAD RUN.
- THE CONTRACTOR SHALL INCLUDE THE NECESSARY MOUNTING HARDWARE FOR RELOCATION OF EXISTING SIGNS.

ZONE	NO. OF ZONE	DELAY TIME (SEC)
DZ-1	1	
DZ-3	1	
DZ-4	2	
DZ-5	1	
DZ-7	1	
DZ-8	2	

TIMING FUNCTION NO.	1	2	3	4	5	6	7	8
MOVEMENT NO.	1	2	4	6	8			
MINIMUM GREEN								
EXTENSION								
MAXIMUM GREEN 1								
MAXIMUM GREEN 2								
YELLOW CLEARANCE		4.3	3.2	3.0	4.3	3.2		
ALL RED		1.7	2.7	1.7	2	3.2		
PED. WALK		7	7	7	7	7		
PED. CLEARANCE		17	30	17	30			
RECALL								

TIMINGS ARE INITIAL. CONTRACTOR TO COORDINATE WITH CITY OF TAMPA FOR ANY TIMING ADJUSTMENT REQUIRED.



W. Busch BLVD
2100 2500
RELOCATE EXISTING STREET NAME SIGN
700-5-50 1 EA



W. Busch BLVD
2500 2100
RELOCATE EXISTING STREET NAME SIGN
700-5-50 1 EA



N. Armenia AVE
8900 9300
RELOCATE EXISTING STREET NAME SIGN
700-5-50 1 EA



N. Armenia AVE
9300 8900
RELOCATE EXISTING STREET NAME SIGN
700-5-50 1 EA

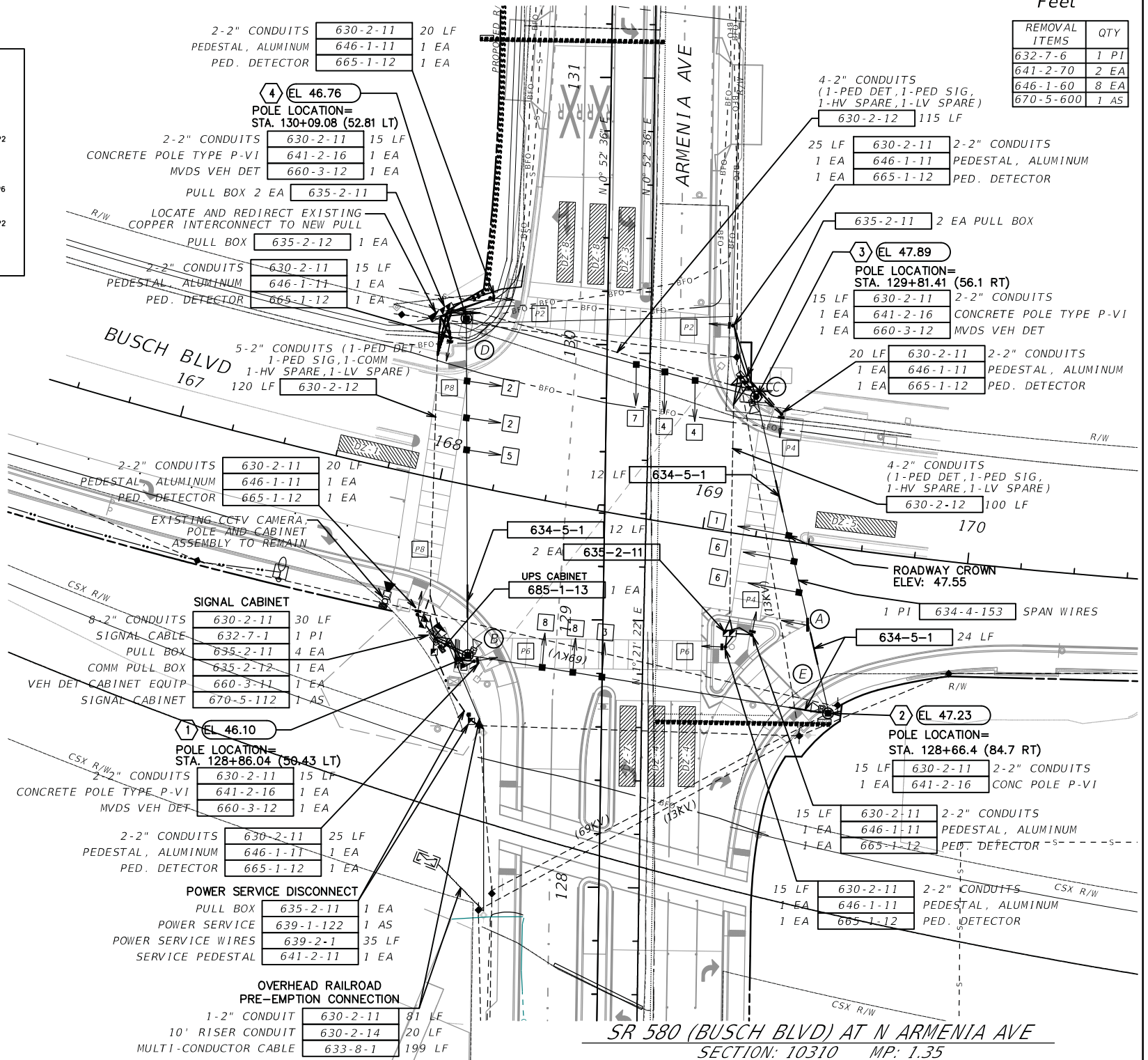

SR 580 (BUSCH BLVD) AT N ARMENIA AVE
SECTION: 10310 MP: 1.35

REVISIONS			
DATE	DESCRIPTION	DATE	DESCRIPTION

Gannett Fleming
9119 CORPORATE LAKE DR, SUITE 150
TAMPA, FL 33634
TEL: 813-882-4366
Certificate of Authorization: No. 5564
Phuc H Duong, P.E. No. 63835

CITY OF TAMPA
TRANSPORTATION DIVISION
CONTRACT NO: 12-D-00057
ARMENIA AVENUE INTERSECTION PROJECT
AT SR 580/BUSCH BLVD.

SIGNALIZATION PLAN
SHEET NO. T-5

THE OFFICIAL RECORD OF THIS SHEET IS THE ELECTRONIC FILE DIGITALLY SIGNED AND SEALED UNDER RULE 61G15-23.004, F.A.C.

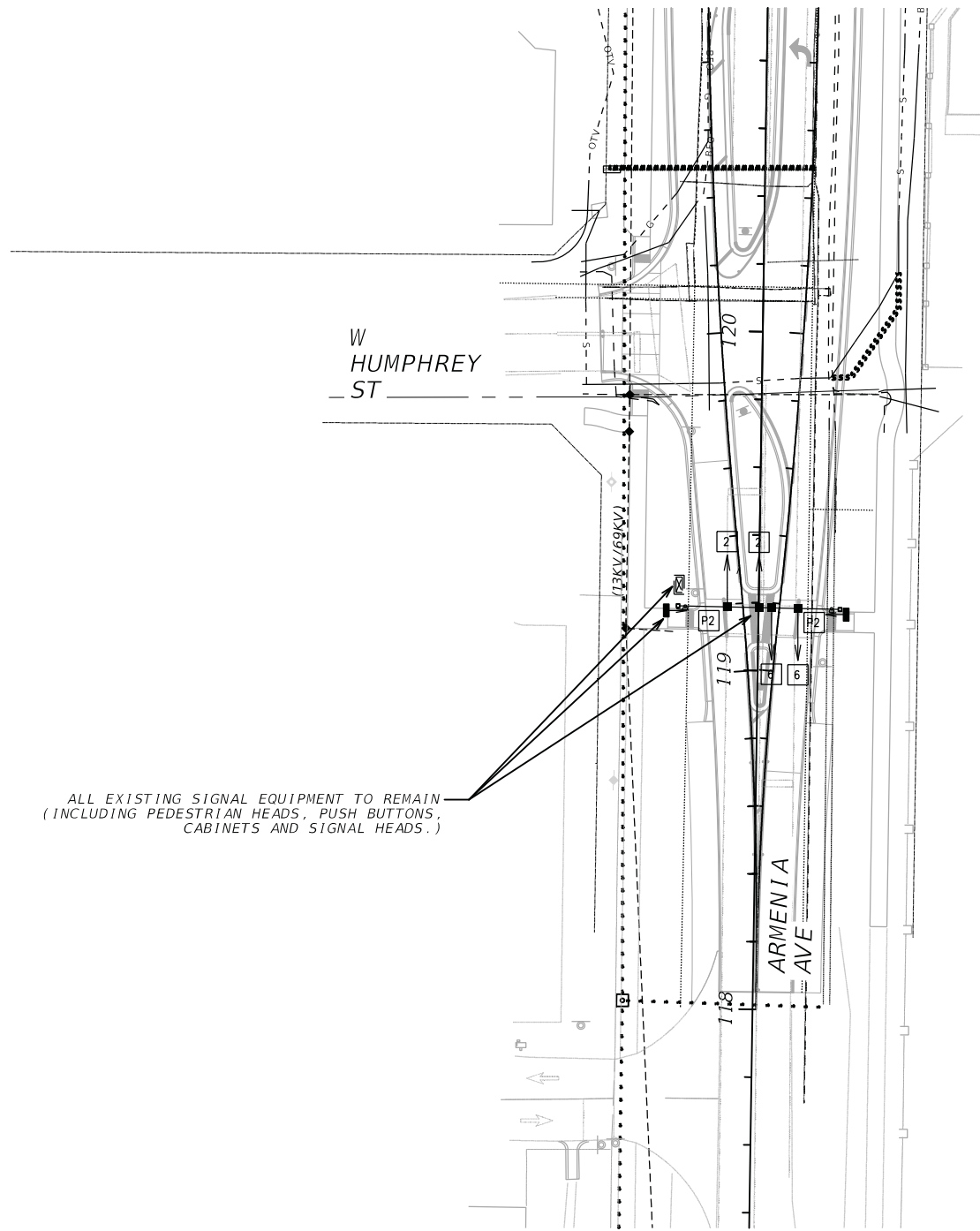
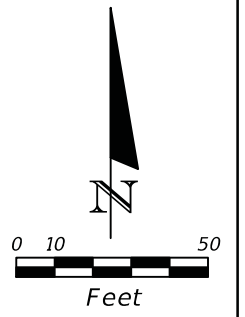

MID-BLOCK PEDESTRIAN CROSSWALK
N ARMENIA AVE SOUTH OF W HUMPHREY ST

REVISIONS			
DATE	DESCRIPTION	DATE	DESCRIPTION

Gannett Fleming
 9119 CORPORATE LAKE DR, SUITE 150
 TAMPA, FL 33634
 TEL: 813-882-4366
 Certificate of Authorization: No. 5564
 Phuc H Duong, P.E. No. 63835

CITY OF TAMPA
 TRANSPORTATION DIVISION
 CONTRACT NO: 12-D-00057
 ARMENIA AVENUE INTERSECTION PROJECT
 AT SR 580/BUSCH BLVD.

SIGNALIZATION PLAN

SHEET NO.
 T-6

THE OFFICIAL RECORD OF THIS SHEET IS THE ELECTRONIC FILE DIGITALLY SIGNED AND SEALED UNDER RULE 61G15-23.004, F.A.C.

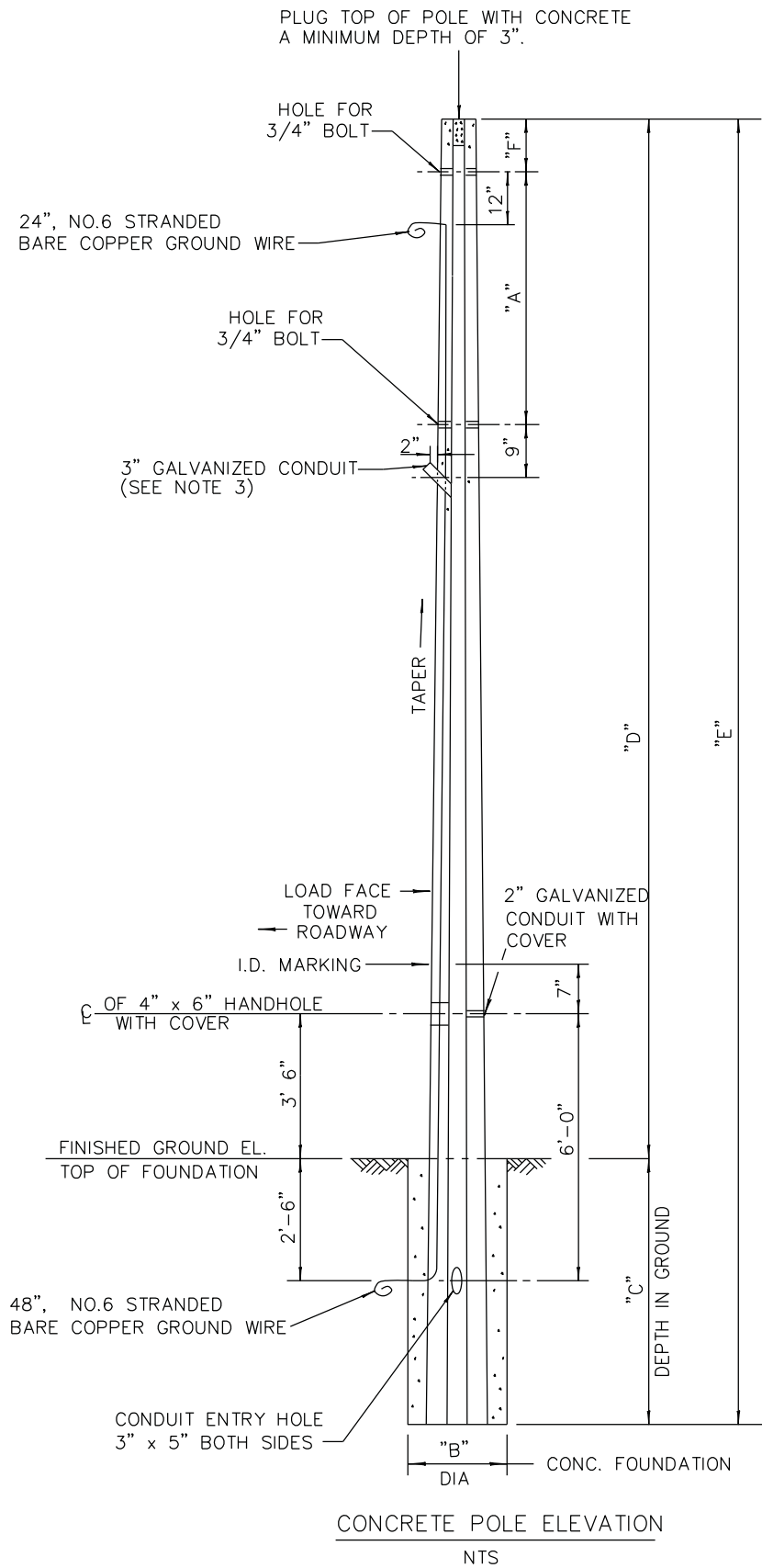

SHEET NUMBER	POLE NO.	POLE TYPE	FINISHED GROUND EL. AT POLE	PAVEMENT EL. UNDER CRITICAL HEAD	DIM. A (FT)	DIM. B (FT)	DIM. C (FT)	DIM. D (FT)	DIM. E (FT)	DIM. F (FT)	CATENARY WIRE DIA. (IN.)/GRADE	MESSENGER WIRE DIA. (IN.)/GRADE	FOUNDATION DESIGN ASSUMPTIONS	
													EFFECTIVE SOIL UNIT WT.(PCF)	ANGLE OF INTERNAL FRICTION (DEG.)
T-5	1	P-VI	46.10	47.55	7.83	4.00	14.00	35.00	49.00	1.39	0.438\"/>			

NOTES:

- FOR ADDITIONAL DETAILS NOT SHOWN ON THIS SHEET, REFER TO DESIGN STANDARD INDEX 641-010.
- DESIGN WIND SPEED: 140 MPH.
- A PROPERLY SIZED SERVICE HEAD, (WEATHERHEAD) SHALL BE INSTALLED AND FASTENED SECURELY ONTO CONDUIT FOR EACH POLE LOCATION. AT LOCATIONS OTHER THAN SERVICE ENTRANCE, THE SERVICE HEAD FACE IS TO BE LEFT CLOSED TO OUTSIDE ATMOSPHERE. SERVICE ENTRANCE INSTALLATION PER INDEX 634-001.
- FOR REPORT OF CORE BORINGS, SEE SHEET T-8.
- SPANS 2 AND 4 CAPACITY AND WIRE HEIGHTS ARE DESIGNED FOR FUTURE 4-SECTION HEAD CONFIGURATION FOR MOVEMENTS 1 AND 5.

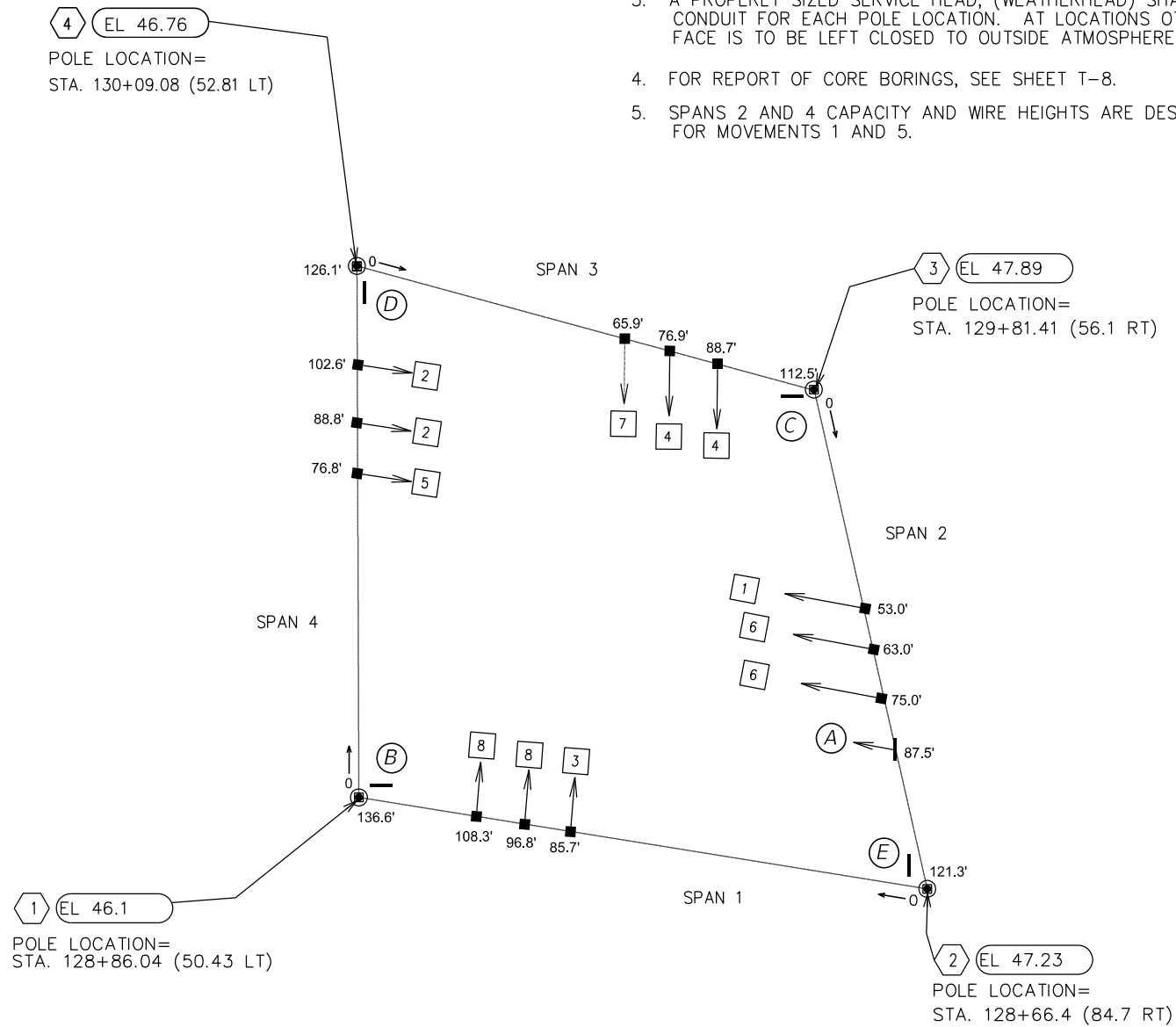

REVISIONS			
DATE	DESCRIPTION	DATE	DESCRIPTION

ELEMENT
 ENGINEERING GROUP
 1713 E. 9th AVENUE | TAMPA, FL 33605
 P 813.386.2101 | TF 888.603.1942 | F 813.386.2106
 EOR | VICKEN SERPEKIAN, PE 82646

CITY OF TAMPA
 TRANSPORTATION DIVISION
 CONTRACT NO: 12-D-00057
 ARMENIA AVENUE INTERSECTION PROJECT
 AT SR 580/BUSCH BLVD.

CONCRETE STRAIN POLE SCHEDULE

SHEET NO.
T-7

NOTICE: THE OFFICIAL RECORD OF THIS SHEET IS THE ELECTRONIC FILE SIGNED AND SEALED UNDER RULE 61G15-23.004, F.A.C.

SPT-01, SPT-02
SPT-03, SPT-04

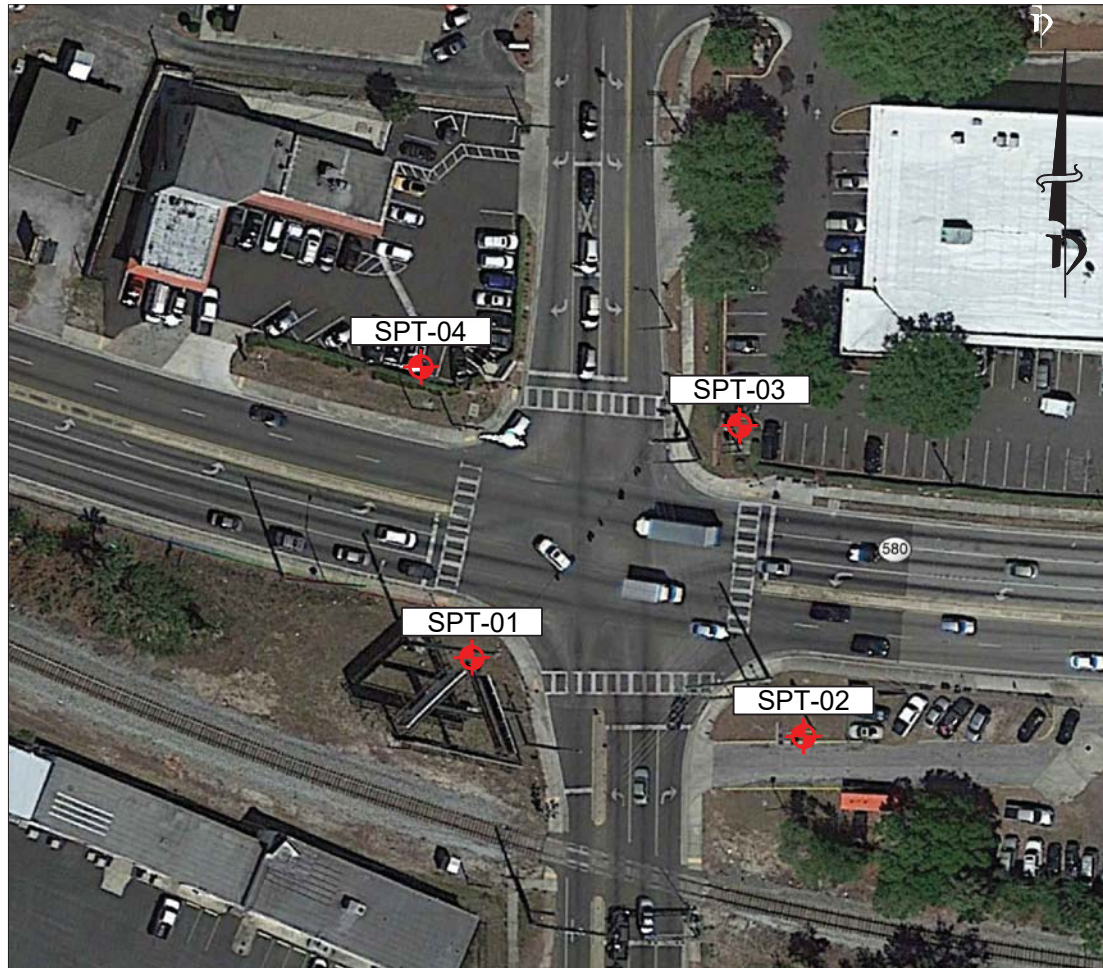

Source: Google Earth
Image Date: 3/15/18

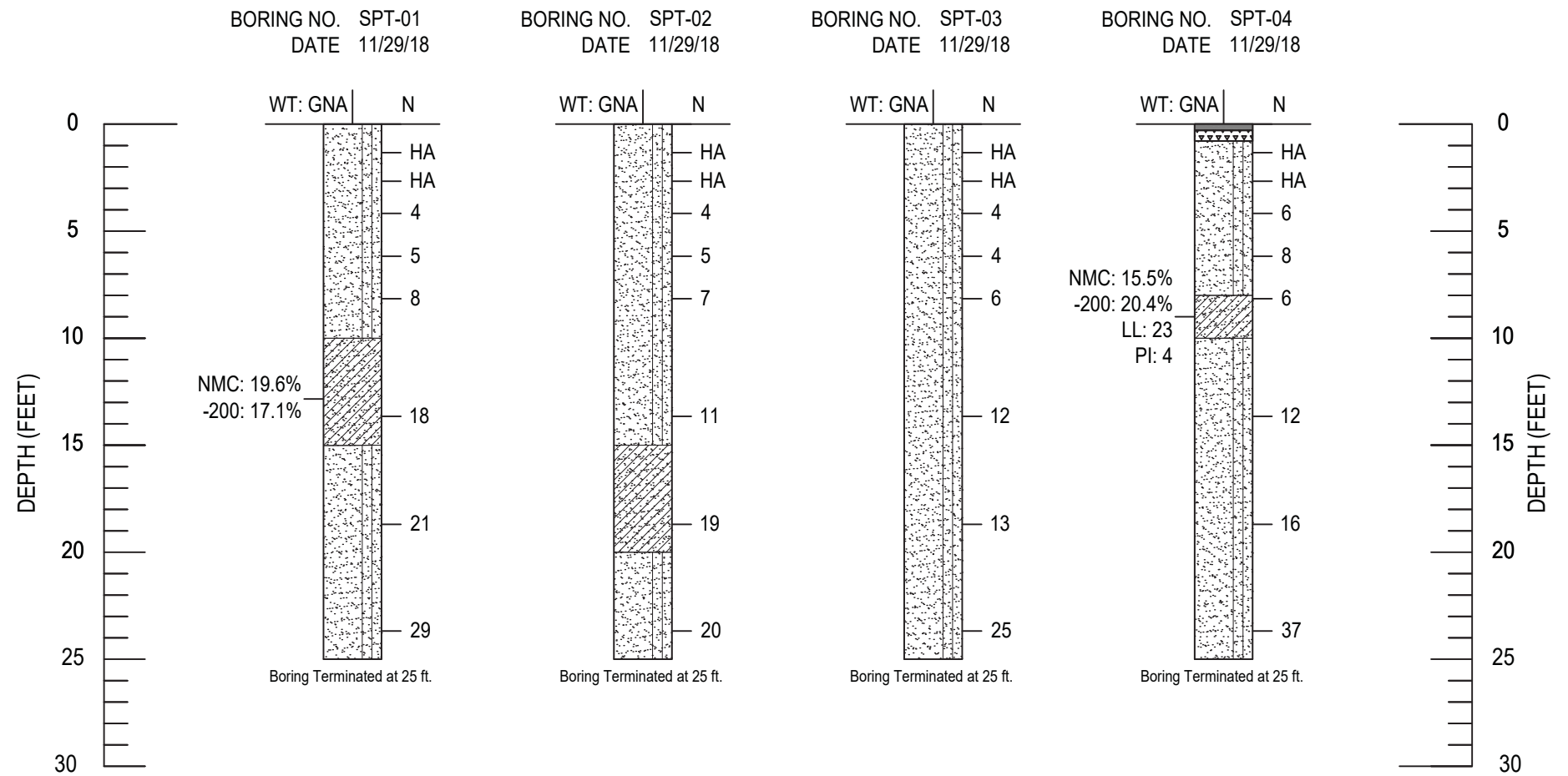

LEGEND

- (SP, SP-SM) Poorly-graded fine SAND to fine SAND with silt
- (SC) Clayey Sand
- Asphalt
- Limerock Base

NOTES:

- WATER TABLE
- N SPT N-VALUE
- HA HAND AUGER BORING
- NMC NATURAL MOISTURE CONTENT (%)
- 200 FINES PASSING A NO. 200 SIEVE (%)
- GNA GROUNDWATER NOT APPARENT
- LL LIQUID LIMIT
- PI PLASTICITY INDEX

GRANULAR MATERIALS- RELATIVE DENSITY	SPT (BLOWS/FT)
VERY LOOSE	≤ 4
LOOSE	4-10
MEDIUM	10-30
DENSE	30-50
VERY DENSE	GREATER THAN 50
SILTS AND CLAYS CONSISTENCY	SPT (BLOWS/FT)
VERY SOFT	≤ 2
SOFT	2-4
FIRM	4-8
STIFF	8-15
VERY STIFF	15-30
HARD	30-50
VERY HARD	GREATER THAN 50

DATE	NAME	REVISION	APPROVED BY:		NAME	DATE	Report of Core Borings	MC ² PROJ. NO.	SHEET NO.
					DESIGNED BY:	TC 12/4/2018	N. Armenia Avenue at W. Busch Boulevard Intersection Improvements City of Tampa, Hillsborough County, FL	T071207.158	T-8
				MC SQUARED, INC. Geotechnical Consultants 5808-A Breckenridge Parkway Tampa, FL 33610 Ph:813-623-3399 Fax:813-623-6636	DRAWN BY:	OM 12/4/2018			
				FLORIDA ENGINEERING CERTIFICATE OF AUTHORIZATION No. 9191 Bulent Hatipoglu, P.E. FLORIDA LICENSE No. 89157	CHECKED BY:	JH 12/5/2018			
					SUPERVISED BY:	BH			

*CITY OF TAMPA
TRANSPORTATION DIVISION*

CONTRACT PLANS

CITY OF TAMPA PROJECT NO. 0000005
CONTRACT NO: 12-D-00057
FINANCIAL PROJECT ID 437044-1-54-01
ARMENIA AVENUE AT BUSCH BOULEVARD



INDEX OF SIGNING AND PAVEMENT MARKING PLANS

<i>SHEET NO.</i>	<i>SHEET DESCRIPTION</i>
S-1	KEY SHEET
S-2	TABULATION OF QUANTITIES
S-3	GENERAL NOTES
S-4 - S-9	SIGNING AND PAVEMENT MARKING PLAN

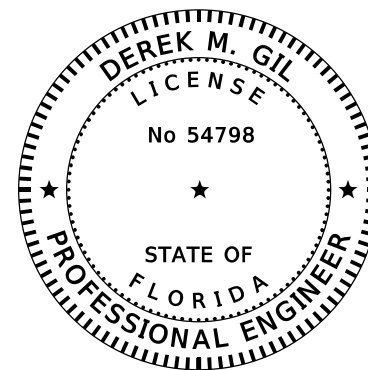

THIS DOCUMENT HAS BEEN DIGITALLY
SIGNED AND SEALED BY:

ON THE DATE ADJACENT TO THE SEAL

PRINTED COPIES OF THIS DOCUMENT ARE
NOT CONSIDERED SIGNED AND SEALED
AND THE SIGNATURE MUST BE VERIFIED
ON ANY ELECTRONIC COPIES.

PLANS PREPARED BY:



1713 E. 9th AVENUE | TAMPA, FL 33605
P 813.386.2101 | TF 888.603.1942 | F 813.386.2106
CERTIFICATE OF AUTHORIZATION NUMBER | 26921
EOR | DEREK M. GIL, PE 54798

NOTE: THE SCALE OF THESE PLANS MAY
HAVE CHANGED DUE TO REPRODUCTION.

SIGNING AND PAVEMENT MARKING PLANS
ENGINEER OF RECORD: DEREK M. GIL

P.E. NO.: 54798

FISCAL YEAR	SHEET NO.
21	S-1

CITY PROJECT MANAGER: NINA MABILLEAU, E.I.

THE OFFICIAL RECORD OF THIS SHEET IS THE ELECTRONIC FILE DIGITALLY SIGNED AND SEALED UNDER RULE 61G15-23.004, F.A.C.

TABULATION OF QUANTITIES

PAY ITEM NO.	DESCRIPTION	UNIT	SHEET NUMBERS														TOTAL THIS SHEET		GRAND TOTAL	
			S-4		S-5		S-6		S-7		S-8		S-9		PLAN	FINAL	PLAN	FINAL		
			PLAN	FINAL	PLAN	FINAL	PLAN	FINAL	PLAN	FINAL	PLAN	FINAL	PLAN	FINAL						
0700 1 11	Single Post Sign, F&I Ground Mount, Up To 12 SF	AS	5		11		19		7				1				43	43		
0700 1 12	Single Post Sign, F&I Ground Mount, 12-20 SF	AS			1				2								3	3		
0700 1 50	Single Post Sign, Relocate	AS	1		3		5		4		1		1				15	15		
0700 1 60	Single Post Sign, Remove	AS	3		7		6		7				1				24	24		
0700 2 60	Multi-Post Sign, Remove	AS									1						1	1		
0700 3 601	Sign Panel, Remove, Up To 12 SF	EA			2				2								4	4		
0700 13 15	Retroreflective Sign Strip- Furnish and Install, 5'	EA	2														2	2		
0705 11 1	Delineator, Flexible Tubular	EA	3		2		2		1								8	8		
0710 11190	Painted Pavement Markings, Standard, White, Island Nose	SF					7										7	7		
0710 11290	Painted Pavement Markings, Standard, Yellow, Island Nose	SF	34		33		21		6								94	94		
710 90	Painted Pavement Markings - Final Surface	LS	1														1	1		
*	Retro-Reflective Pavement Marker (W/R)	EA	1		52		69		36		8						166	166		
*	Retro-Reflective Pavement Marker (Y/R)	EA	1		5												6	6		
*	Retro-Reflective Pavement Marker (Y/Y)	EA	13		8				42								63	63		
*	Painted Pavement Markings, Standard, White, Solid, 6"	GM	0.092		0.234		0.255		0.204		0.078		0.038				0.901	0.901		
*	Painted Pavement Markings, Standard, White, Solid, 8" For Urban Island	GM					0.031										0.031	0.031		
*	Painted Pavement Markings, Standard, White, Solid, 12" For Drop Lane	GM			0.046				0.041								0.087	0.087		
*	Painted Pavement Markings, Standard, White, Solid, 12" For Crosswalk	LF	108		188		611		278								1185	1185		
*	Painted Pavement Markings, Standard, White, Solid, 24" for Stop Line	LF	33		38		296		42								409	409		
*	Painted Pavement Markings, Standard, White, (10/30) Skip, 6"	GM			0.084		0.023										0.107	0.107		
*	Painted Pavement Markings, Standard, White, (3/9) Skip, 12"	GM			0.035		0.064		0.023								0.122	0.122		
*	Painted Pavement Markings, Standard, White, (2/4) Dotted Guide Line/(6/10) Gap Extension, 6"	GM	0.018		0.091		0.069		0.050								0.228	0.228		
*	Painted Pavement Markings, Standard, Message or Symbol (ONLY)	EA			3		1		4								8	8		
*	Painted Pavement Markings, Standard, Message or Symbol (RR)	EA					5										5	5		
*	Painted Pavement Markings, Standard, Arrows (LEFT)	EA			8		4		7								19	19		
*	Painted Pavement Markings, Standard, Arrows (RIGHT)	EA					2				3						5	5		
*	Painted Pavement Markings, Standard, Arrows (THRU-RIGHT)	EA					1		3								4	4		
*	Painted Pavement Markings, Standard, Yellow, Solid, 6"	GM	0.101		0.209		0.124		0.235								0.669	0.669		
*	Painted Pavement Markings, Standard, Yellow, Solid, 18" for Diagonals	LF	19		52				70								141	141		
*	Painted Pavement Markings, Standard, Yellow, (2/4) Dotted Guide Line/(6/10) Gap Extension, 6"	GM	0.008				0.040										0.048	0.048		
0711 11102	Thermoplastic, Standard, White, Solid, 8" For Urban Island	GM					0.031										0.031	0.031		
0711 11103	Thermoplastic, Standard, White, Solid, 12" For Drop Lane	GM			0.046				0.041								0.087	0.087		
0711 11123	Thermoplastic, Standard, White, Solid, 12" For Crosswalk	LF	108		188		611		278								1185	1185		
0711 11125	Thermoplastic, Standard, White, Solid, 24" for Stop Line	LF	33		38		296		42								409	409		
0711 11141	Thermoplastic, Standard, White, (2/4) Dotted Guide Line/(6/10) Gap Extension, 6"	GM	0.018		0.091		0.069		0.050								0.228	0.228		
0711 11160	Thermoplastic, Standard, White, Message or Symbol	EA															13	13		
	Thermoplastic, Standard, White, Message or Symbol (ONLY)	EA			3		1		4											
	Thermoplastic, Standard, White, Message or Symbol (RR)	EA					5													
0711 11170	Thermoplastic, Standard, White, Arrows	EA															28	28		
	Thermoplastic, Standard, White, Arrows (LEFT)	EA			8		4		7											
	Thermoplastic, Standard, White, Arrows (RIGHT)	EA					2				3									
	Thermoplastic, Standard, White, Arrows (THRU-RIGHT)	EA					1		3											
0711 11224	Thermoplastic, Standard, Yellow, Solid, 18" for Diagonals	LF	19		52				70								141	141		
0711 11241	Thermoplastic, Standard, Yellow, (2/4) Dotted Guide Line/(6/10) Gap Extension, 6"	GM	0.008				0.040										0.048	0.048		
0711 14125	Thermoplastic, Preformed, White, Solid, 24" For Crosswalk	LF	124		157		602		241								1124	1124		
0711 16101	Thermoplastic, Std - Other Surfaces, White, Solid, 6"	GM	0.092		0.234		0.255		0.204		0.078		0.038				0.901	0.901		
0711 16131	Thermoplastic, Std - Other Surfaces, White, (10/30) Skip, 6"	GM			0.084		0.023										0.107	0.107		
0711 16133	Thermoplastic, Std - Other Surfaces, White, (3/9) Skip, 12" For Drop Lane	GM			0.035		0.064		0.023								0.122	0.122		
0711 16201	Thermoplastic, Std - Other Surfaces, Yellow, Solid, 6"	GM	0.101		0.209		0.124		0.235								0.669	0.669		
0711 17 1	Thermoplastic, Remove Existing Thermoplastic Pavement Markings- Surface To Remain	SF	85														85	85		

* These quantities are paid for under Painted Pavement Markings (Final Surface), Lump Sum - Item No. 710-90. The quantities shown are for one application; see Specification 710 for the number of applications required.

REVISIONS			
DATE	DESCRIPTION	DATE	DESCRIPTION



CITY OF TAMPA
TRANSPORTATION DIVISION

CONTRACT NO: 12-D-00057
ARMENIA AVENUE INTERSECTION PROJECT
AT SR 580/BUSCH BLVD.

TABULATION OF QUANTITIES

SHEET NO.

S-2

THE OFFICIAL RECORD OF THIS SHEET IS THE ELECTRONIC FILE DIGITALLY SIGNED AND SEALED UNDER RULE 61G15-23.004, F.A.C.

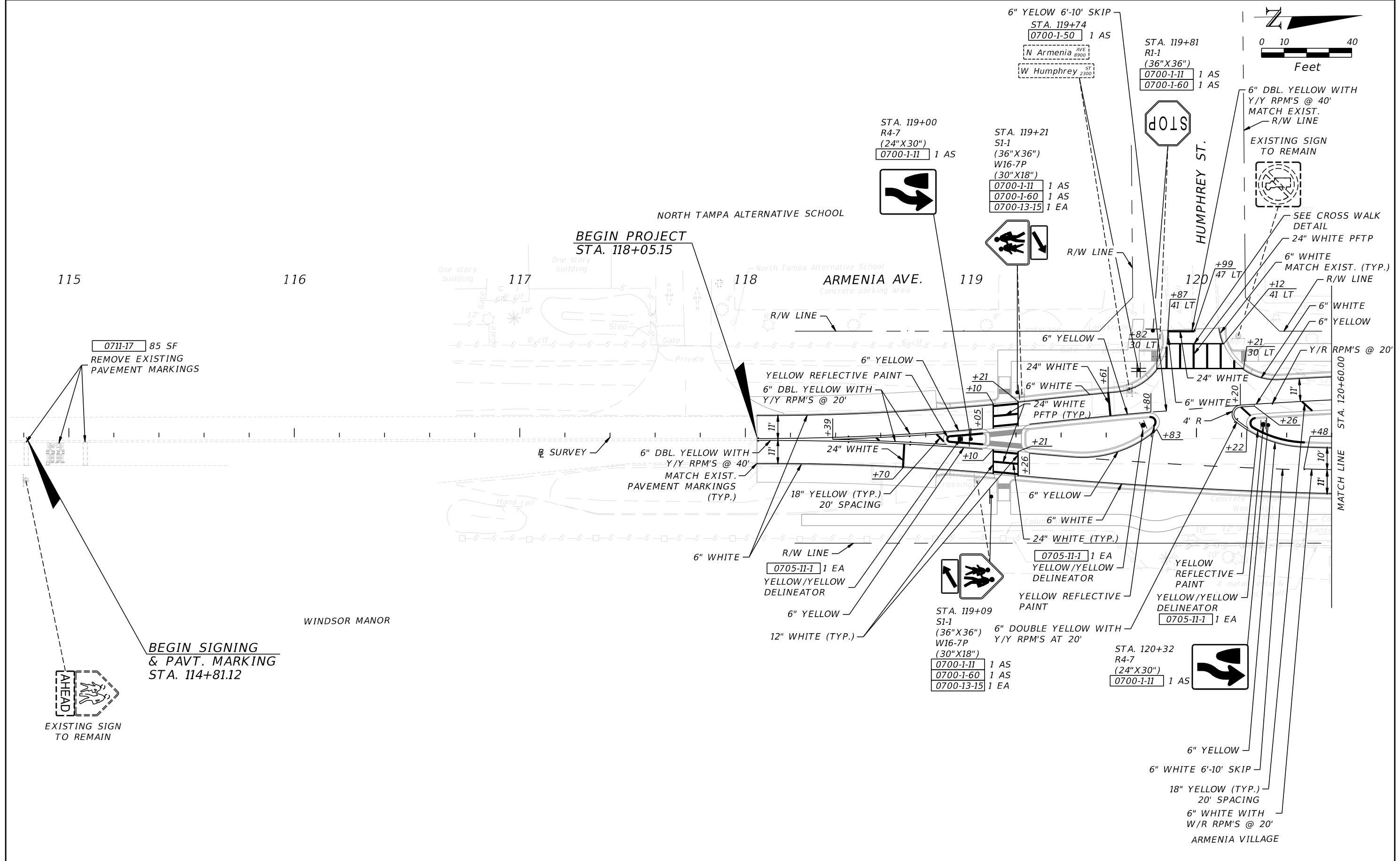
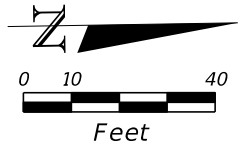

REVISIONS			
DATE	DESCRIPTION	DATE	DESCRIPTION

ELEMENT
 ENGINEERING GROUP
 1713 E. 9th AVENUE | TAMPA, FL 33605
 P 813.386.2101 | TF 888.603.1942 | F 813.386.2106
 EOR | DEREK M. GIL, PE 54798

CITY OF TAMPA
 TRANSPORTATION DIVISION
 CONTRACT NO: 12-D-00057
 ARMENIA AVENUE INTERSECTION PROJECT
 AT SR 580/BUSCH BLVD.

SIGNING AND PAVEMENT MARKING PLAN

SHEET NO.
S-4

THE OFFICIAL RECORD OF THIS SHEET IS THE ELECTRONIC FILE DIGITALLY SIGNED AND SEALED UNDER RULE 61G15-23.004, F.A.C.

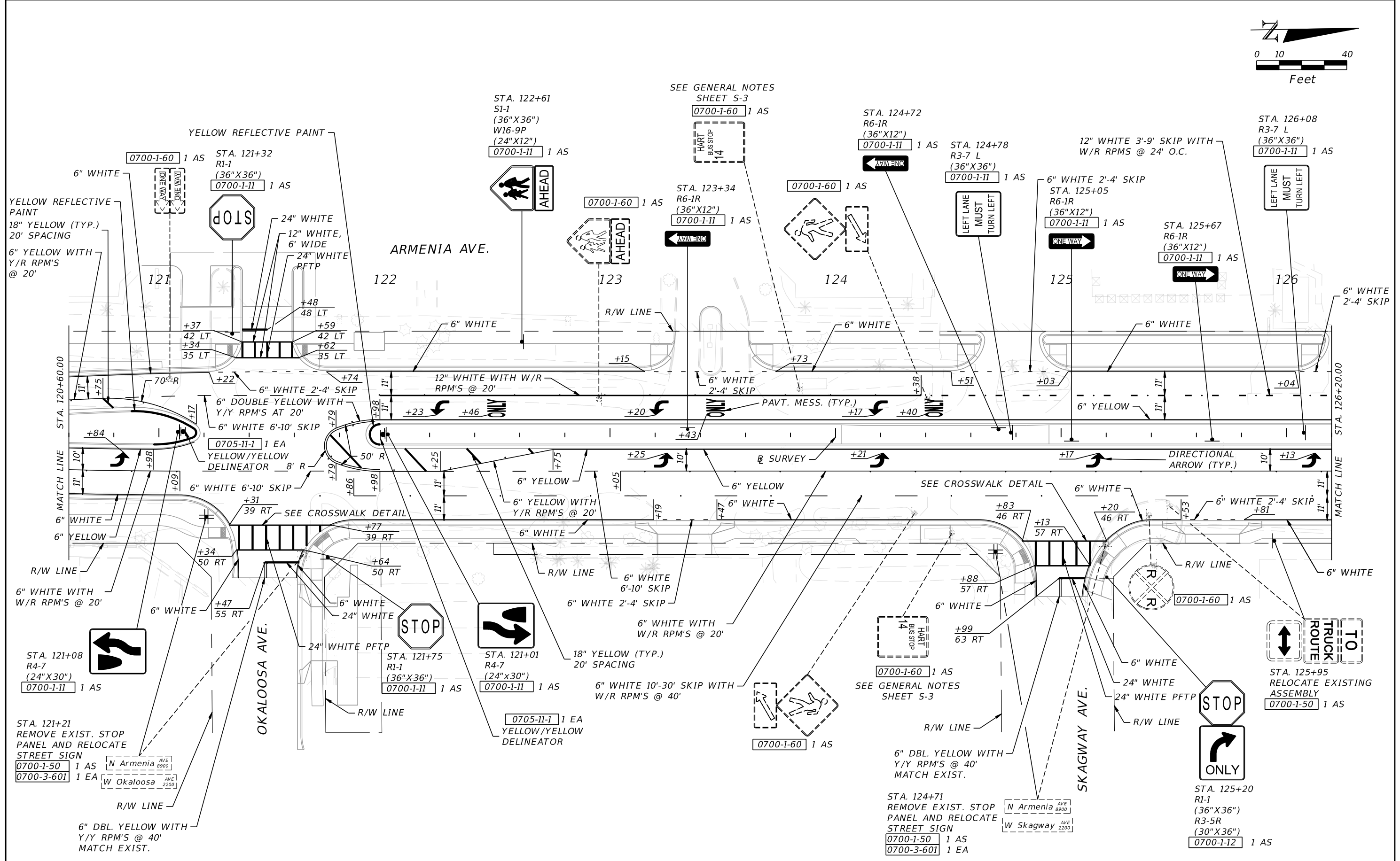
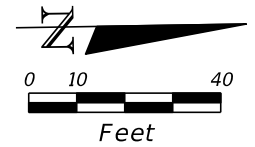

REVISIONS			
DATE	DESCRIPTION	DATE	DESCRIPTION

ELEMENT
 ENGINEERING GROUP
 1713 E. 9th AVENUE | TAMPA, FL 33605
 P 813.386.2101 | TF 888.603.1942 | F 813.386.2106
 EOR | DEREK M. GIL, PE 54798

CITY OF TAMPA
 TRANSPORTATION DIVISION
 CONTRACT NO: 12-D-00057
 ARMENIA AVENUE INTERSECTION PROJECT
 AT SR 580/BUSCH BLVD.

SIGNING AND PAVEMENT MARKING PLAN

SHEET NO. S-5

THE OFFICIAL RECORD OF THIS SHEET IS THE ELECTRONIC FILE DIGITALLY SIGNED AND SEALED UNDER RULE 61G15-23.004, F.A.C.

EQUATION:
 Sta 129+40.70 BK =
 Sta 129+37.70 AH

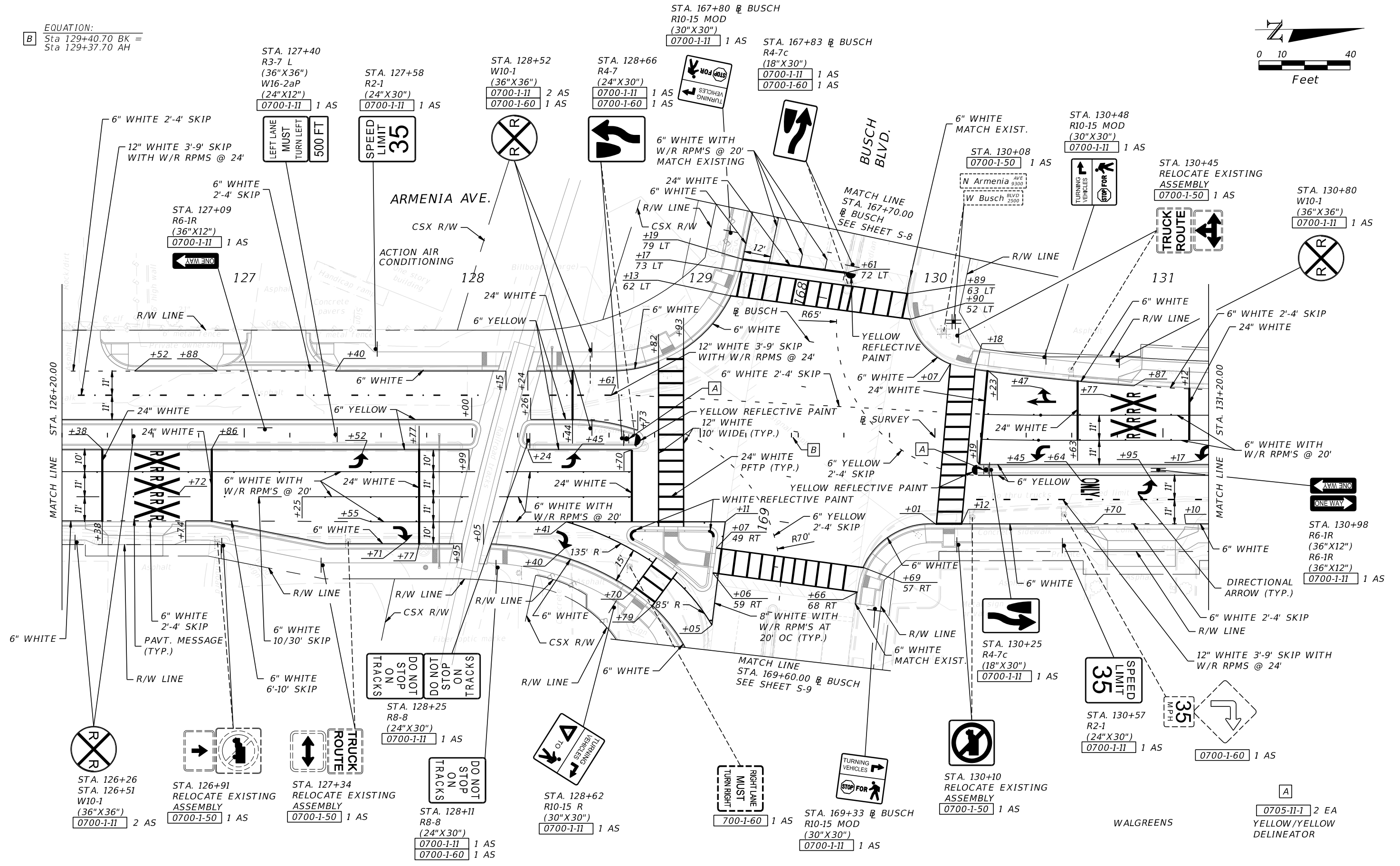
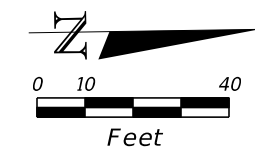

REVISIONS			
DATE	DESCRIPTION	DATE	DESCRIPTION

ELEMENT
 ENGINEERING GROUP
 1713 E. 9th AVENUE | TAMPA, FL 33605
 P 813.386.2101 | TF 888.603.1942 | F 813.386.2106
 EOR | DEREK M. GIL, PE 54798

CITY OF TAMPA
 TRANSPORTATION DIVISION
 CONTRACT NO: 12-D-00057
 ARMENIA AVENUE INTERSECTION PROJECT
 AT SR 580/BUSCH BLVD.

SIGNING AND PAVEMENT MARKING PLAN

SHEET NO.
 5-6

THE OFFICIAL RECORD OF THIS SHEET IS THE ELECTRONIC FILE DIGITALLY SIGNED AND SEALED UNDER RULE 61G15-23.004, F.A.C.

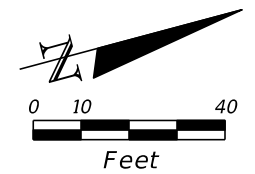

STA. 132+24
ASSEMBLY
RELOCATE EXISTING
ASSEMBLY
0700-1-50 1 AS

SEE GENERAL NOTES
SHEET S-3
0700-1-60 1 AS

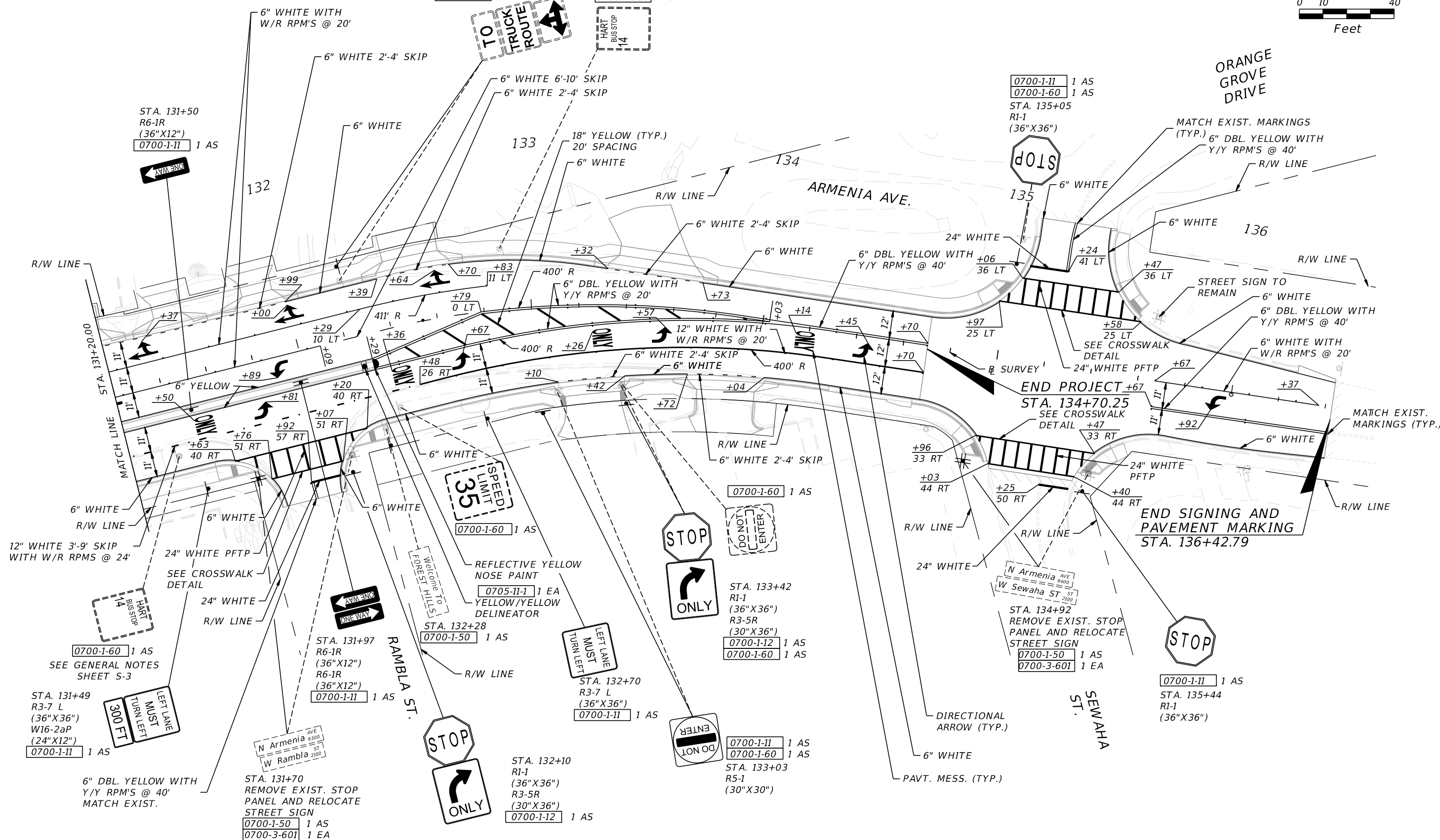

REVISIONS			
DATE	DESCRIPTION	DATE	DESCRIPTION

ELEMENT
ENGINEERING GROUP
1713 E. 9th AVENUE | TAMPA, FL 33605
P 813.386.2101 | TF 888.603.1942 | F 813.386.2106
EOR | DEREK M. GIL, PE 54798

CITY OF TAMPA
TRANSPORTATION DIVISION
CONTRACT NO: 12-D-00057
ARMENIA AVENUE INTERSECTION PROJECT
AT SR 580/BUSCH BLVD.

**SIGNING AND PAVEMENT
MARKING PLAN**

SHEET NO.
S-7

THE OFFICIAL RECORD OF THIS SHEET IS THE ELECTRONIC FILE DIGITALLY SIGNED AND SEALED UNDER RULE 61G15-23.004, F.A.C.

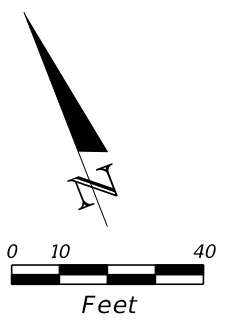

BEGIN SIGNING
& PAVT. MARKING
STA. 165+25.00

SR580
BUSCH BLVD.

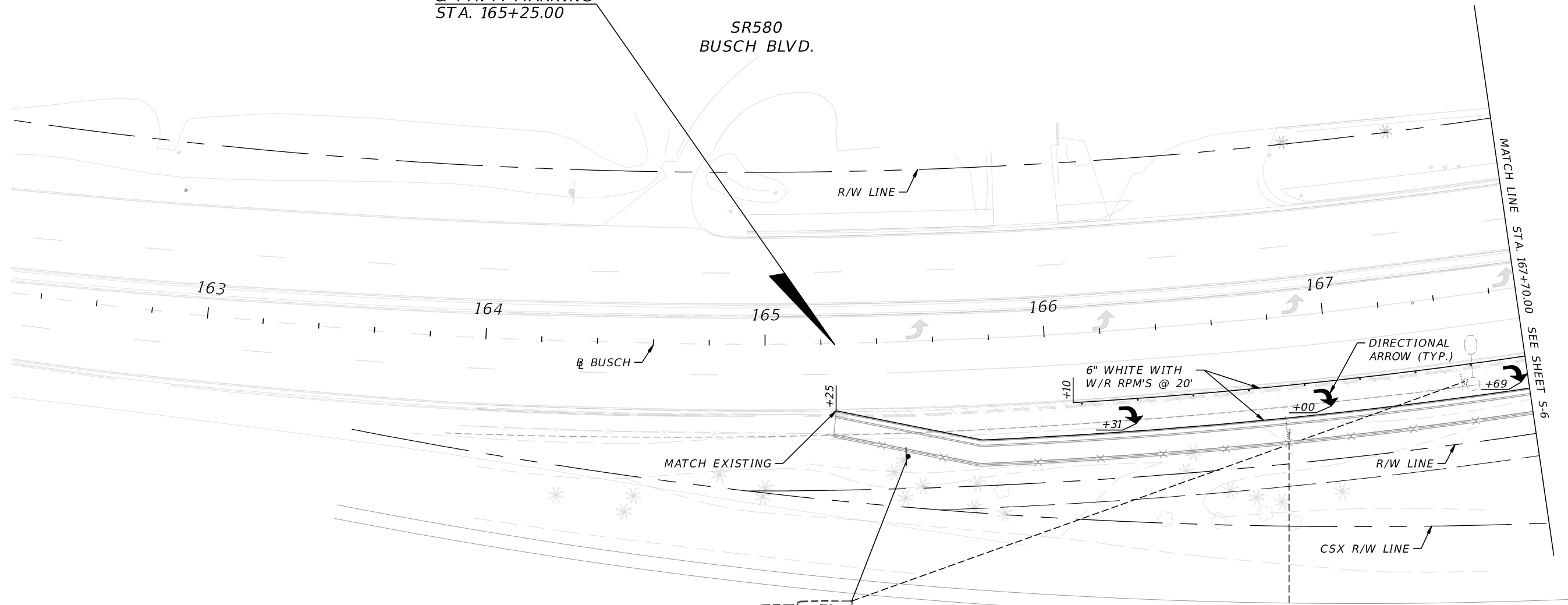

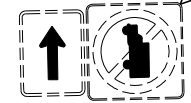
STA. 165+50
RELOCATE EXISTING
ASSEMBLY
0700-1-50 1 AS

REMOVE EXISTING MULTI-POST SIGN
AND DELIVER TO THE CITY OF TAMPA

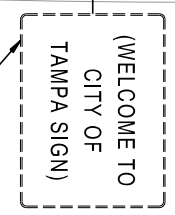
(WELCOME TO
CITY OF
TAMPA SIGN)
0700-2-60 1 AS

REVISIONS			
DATE	DESCRIPTION	DATE	DESCRIPTION

ELEMENT
ENGINEERING GROUP
1713 E. 9th AVENUE | TAMPA, FL 33605
P 813.386.2101 | TF 888.603.1942 | F 813.386.2106
EOR | DEREK M. GIL, PE 54798

CITY OF TAMPA
TRANSPORTATION DIVISION
CONTRACT NO: 12-D-00057
ARMENIA AVENUE INTERSECTION PROJECT
AT SR 580/BUSCH BLVD.

**SIGNING AND PAVEMENT
MARKING PLAN**

SHEET NO.
S-8

THE OFFICIAL RECORD OF THIS SHEET IS THE ELECTRONIC FILE DIGITALLY SIGNED AND SEALED UNDER RULE 61G15-23.004, F.A.C.

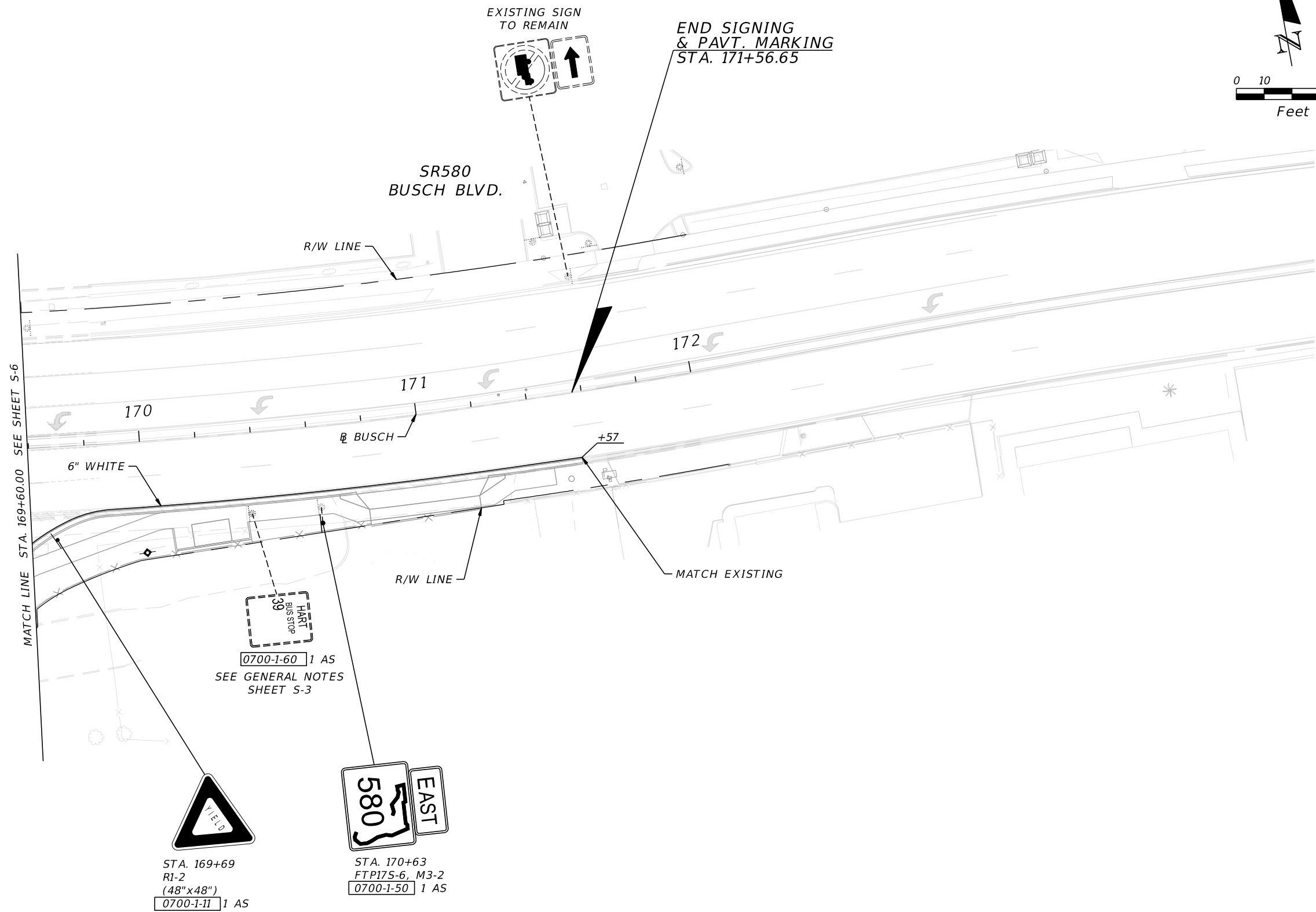
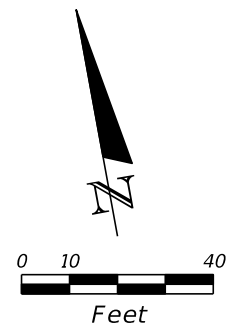

STA. 169+69
R1-2
(48"x48")
0700-1-11 1 AS

0700-1-60 1 AS
SEE GENERAL NOTES
SHEET S-3

STA. 170+63
FTP17S-6, M3-2
0700-1-50 1 AS

END SIGNING
& PAVT. MARKING
STA. 171+56.65

REVISIONS			
DATE	DESCRIPTION	DATE	DESCRIPTION

ELEMENT
ENGINEERING GROUP
1713 E. 9th AVENUE | TAMPA, FL 33605
P 813.386.2101 | TF 888.603.1942 | F 813.386.2106
EOR | DEREK M. GIL, PE 54798

CITY OF TAMPA
TRANSPORTATION DIVISION
CONTRACT NO: 12-D-00057
ARMENIA AVENUE INTERSECTION PROJECT
AT SR 580/BUSCH BLVD.

**SIGNING AND PAVEMENT
MARKING PLAN**

SHEET NO.
S-9

THE OFFICIAL RECORD OF THIS SHEET IS THE ELECTRONIC FILE DIGITALLY SIGNED AND SEALED UNDER RULE 61G15-23.004, F.A.C.