

**CITY OF TAMPA
MOBILITY DEPARTMENT**

CONTRACT PLANS

FINANCIAL PROJECT ID 439476-3-58-01
(FEDERAL FUNDS)

E/W GREEN SPINE CYCLE TRACK -
PH. 3B FROM 7TH AVE. TO 13TH AVE.

LOCATION OF PROJECT

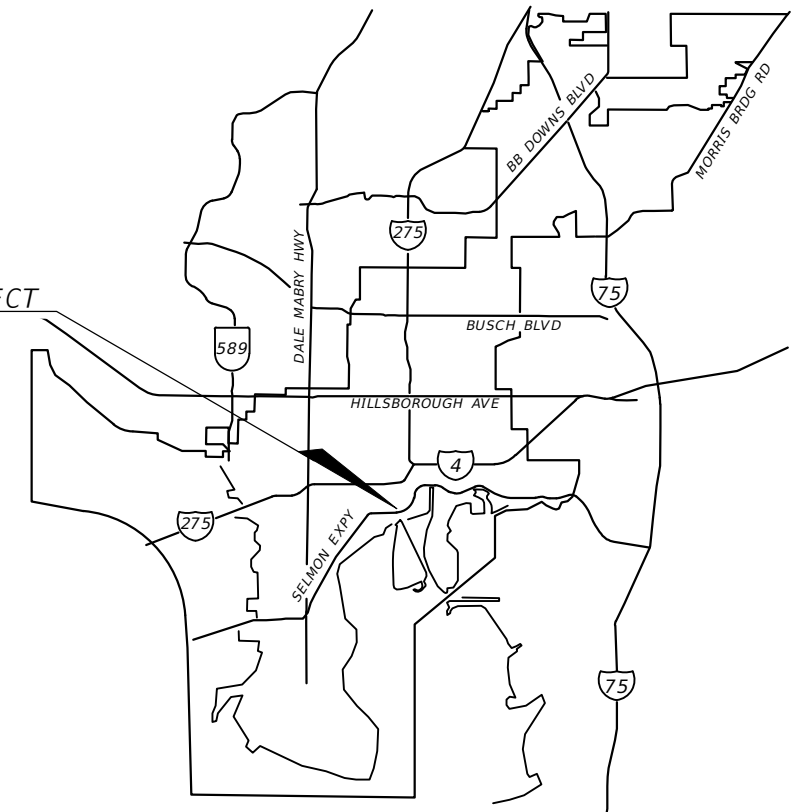

INDEX OF SIGNING AND PAVEMENT MARKING PLANS

SHEET NO.	SHEET DESCRIPTION
S-1	KEY SHEET
S-2	TABULATION OF QUANTITIES
S-3	SIGNING AND PAVEMENT MARKING DETAILS
S-4	GENERAL NOTES
S-5 THRU S-9	SIGNING AND MARKING PLANS

SIGNING AND PAVEMENT MARKING PLANS

FINAL SUBMITTAL
SEPTEMBER 24, 2021

THIS ITEM HAS BEEN DIGITALLY SIGNED AND SEALED BY

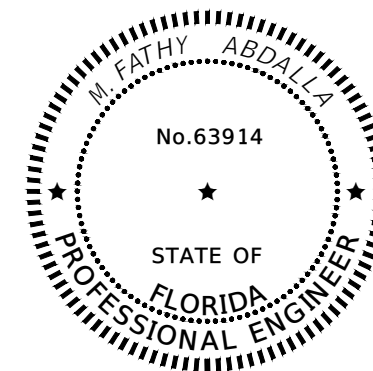

ON THE DATE ADJACENT TO THE SEAL

PRINTED COPIES OF THIS DOCUMENT ARE NOT CONSIDERED SIGNED AND SEALED AND THE SIGNATURE MUST BE VERIFIED ON ANY ELECTRONIC COPIES.

KISINGER CAMPO & ASSOCIATES CORP.
201 N FRANKLIN ST, SUITE 400,
TAMPA, FL 33602

FATHY ABDALLA, P.E. NO. 63914

CITY OF TAMPA PROJECT MANAGER:

NINA S MABILLEAU E.I.

CONSTRUCTION CONTRACT NO.	FISCAL YEAR	SHEET NO.
21-C-00022	2021	S-1

THE OFFICIAL RECORD OF THIS SHEET IS THE ELECTRONIC FILE DIGITALLY SIGNED AND SEALED UNDER RULE 61G15-23.004, F.A.C.

TABULATION OF QUANTITIES

PAY ITEM NO.	DESCRIPTION	UNIT	SHEET NUMBERS														TOTAL THIS SHEET		GRAND TOTAL	
			NUCCIO PARKWAY/12th AVE/15th St from 7th AVE to 13th AVE																	
			S-5		S-6		S-7		S-8		S-9						PLAN	FINAL	PLAN	FINAL
			PLAN	FINAL	PLAN	FINAL	PLAN	FINAL	PLAN	FINAL	PLAN	FINAL	PLAN	FINAL	PLAN	FINAL				
523-1-3	PATTERNED PAVEMENT, INCLUDING GREEN BIKE LANES	SY	44		84							22						150		
700-1-11	SINGLE POST SIGN, F&I GROUND MOUNT, UP TO 12 SF	AS	1		2							2						5		
700-1-18	SINGLE POST SIGN, F&I GROUND MOUNT, IN-STREET FLEXIBLE POST SIGN	AS	3		4							1						8		
700-1-50	SINGLE POST SIGN, RELOCATE	AS	1															1		
700-1-60	SINGLE POST SIGN, REMOVE	AS										1						1		
705-11-3	DELINEATOR, FLEXIBLE HIGH VISABILITY MEDIAN	EA	5		5							1						11		
710-90	PAINTED PAVEMENT MARKINGS, FINAL SURFACE	LS																		
*	RAISED PAVEMENT MARKER, TYPE B	EA			5							20						25		
*	PAINTED PAVEMENT MARKINGS, STANDARD, WHITE, SOLID, 6"	GM	0.044		0.072		0.087		0.097			0.094						0.394		
*	PAINTED PAVEMENT MARKINGS, STANDARD, WHITE, SOLID FOR INTERCHANGE AND URBAN ISLAND, 8"	GM			0.006							0.026						0.032		
*	PAINTED PAVEMENT MARKINGS, STANDARD, WHITE, SOLID FOR CROSSWALK AND ROUNDABOUT, 12"	LF	70		410													480		
*	PAINTED PAVEMENT MARKINGS, STANDARD, WHITE, SOLID FOR DIAGONAL OR CHEVRON, 18"	LF										32						32		
*	PAINTED PAVEMENT MARKINGS, STANDARD, WHITE, SOLID FOR STOP LINE OR CROSSWALK, 24"	LF	17		405							19						441		
*	PAINTED PAVEMENT MARKINGS, STANDARD, WHITE, 2-4 DOTTED GUIDELINE, 6"	GM	0.064		0.113													0.177		
*	PAINTED PAVEMENT MARKINGS, STANDARD, WHITE, 6-10 SKIP, 6"	GM			0.015													0.015		
*	PAINTED PAVEMENT MARKINGS, STANDARD, WHITE, MESSAGE OR SYMBOL	EA	6		10							2						18		
*	PAINTED PAVEMENT MARKINGS, STANDARD, WHITE, ARROWS	EA	6		14							3						23		
*	PAINTED PAVEMENT MARKINGS, STANDARD, YELLOW, SOLID, 6"	GM	0.069		0.130		0.087		0.097			0.086						0.469		
*	PAINTED PAVEMENT MARKINGS, STANDARD, YELLOW, SOLID FOR DIAGONAL OR CHEVRON, 18"	LF										32						32		
*	PAINTED PAVEMENT MARKINGS, STANDARD, YELLOW, SKIP, 6"	GM					0.087		0.097									0.184		
*	PAINTED PAVEMENT MARKINGS, STANDARD, YELLOW, ISLAND NOSE	SF	18		18							4						40		
711-11-123	THERMOPLASTIC, STANDARD, WHITE, SOLID, 12" FOR CROSSWALK AND ROUNDABOUT	LF	70		410													480		
711-11-124	THERMOPLASTIC, STANDARD, WHITE, SOLID, 18" FOR DIAGONALS AND CHEVRONS	LF			30							33						63		
711-11-125	THERMOPLASTIC, STANDARD, WHITE, SOLID, 24" FOR STOP LINE AND CROSSWALK	LF	17		65							19						101		
711-11-141	THERMOPLASTIC, STANDARD, WHITE, 2-4 DOTTED GUIDELINE/ 6-10 GAP EXTENSION, 6"	GM	0.064		0.128							0.060						0.252		
711-11-160	THERMOPLASTIC, STANDARD, WHITE, MESSAGE OR SYMBOL	EA										2						2		
711-11-170	THERMOPLASTIC, STANDARD, WHITE, ARROW	EA	6		14							3						23		
711-11-224	THERMOPLASTIC, STANDARD, YELLOW, SOLID, 18" FOR DIAGONAL OR CHEVRON	LF										32						32		
711-14-125	THERMOPLASTIC, PREFORMED, WHITE, SOLID, 24" FOR CROSSWALK	LF			340													340		
711-14-160	THERMOPLASTIC, PREFORMED, WHITE, SYMBOL (BIKE)	EA	6		10							2						18		
711-16-101	THERMOPLASTIC, STANDARD-OTHER SURFACES, WHITE, SOLID, 6"	GM	0.044		0.072		0.087		0.097			0.094						0.394		
711-16-102	THERMOPLASTIC, STANDARD-OTHER SURFACES, WHITE, SOLID, 8"	GM			0.006							0.026						0.032		
711-16-201	THERMOPLASTIC, STANDARD-OTHER SURFACES, YELLOW, SOLID, 6"	GM	0.069		0.130		0.087		0.097			0.086						0.469		
711-16-231	THERMOPLASTIC, STANDARD-OTHER SURFACES, YELLOW, SKIP, 6", 10-30 SKIP	GM																		
	THERMOPLASTIC, STANDARD-OTHER SURFACES, YELLOW, SKIP, 6", 3-9 SKIP	GM	0.025		0.035		0.087		0.097			0.059						0.303		

* THESE QUANTITIES ARE PAID FOR UNDER PAINTED PAVEMENT MARKINGS (FINAL SURFACE), LUMP SUM - ITEM NO. 710-90. THE QUANTITIES SHOWN ARE FOR ONE APPLICATION; SEE SPECIFICATION 710 FOR THE NUMBER OF APPLICATIONS REQUIRED.

REVISIONS				KISINGER CAMPO & ASSOCIATES CORP. 201 N FRANKLIN ST, SUITE 400, TAMPA, FL 33602 ENGINEER OF RECORD: FATHY ABDALLA, P.E. NO: 63914	CITY OF TAMPA MOBILITY DEPARTMENT			<i>TABULATION OF QUANTITIES</i>	SHEET NO.
DATE	DESCRIPTION	DATE	DESCRIPTION		ROAD NO.	COUNTY	PROJECT DESIGN NO.		
						HILLSBOROUGH	21-C-00022		

THE OFFICIAL RECORD OF THIS SHEET IS THE ELECTRONIC FILE DIGITALLY SIGNED AND SEALED UNDER RULE 61G15-23.004, F.A.C.

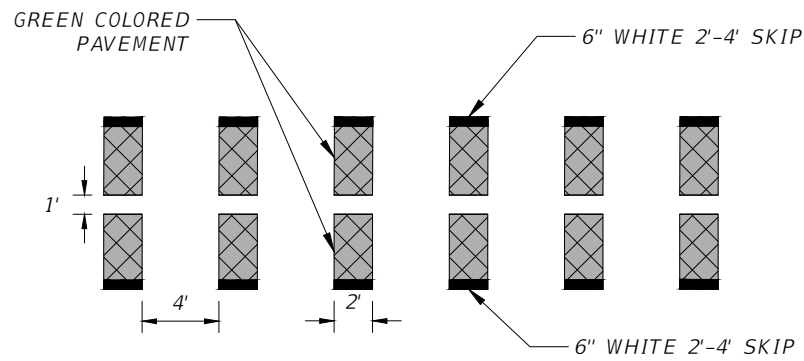

TYPICAL INTERSECTION BIKE CROSSING DETAIL
(PAY ITEM 523-1-3)
(NTS)

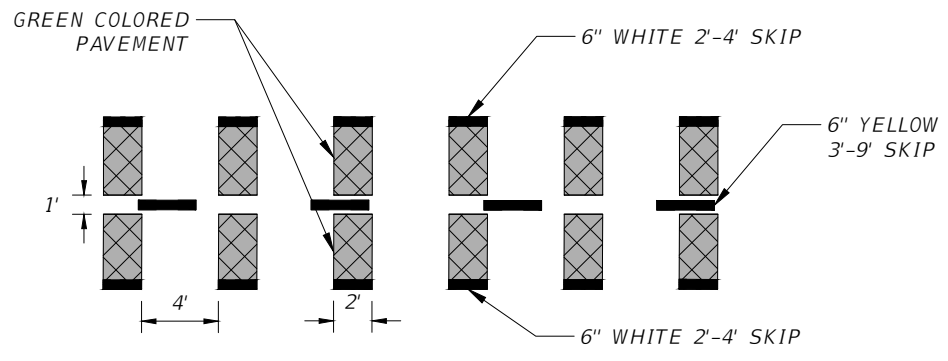

TYPICAL DRIVEWAY BIKE CROSSING DETAIL
(PAY ITEM 523-1-3)
(NTS)

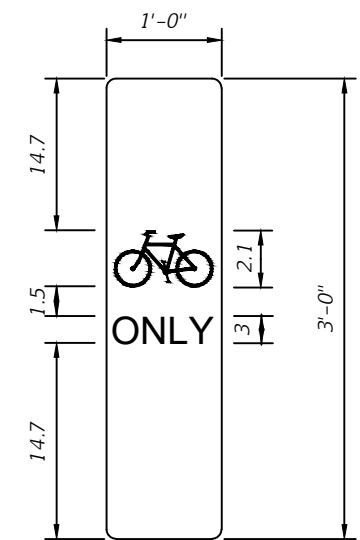

SIGN GM-1
"BIKE ONLY" SYMBOL SIGN DETAIL
(NTS)

FABRICATE SPECIAL 12"X36" "BIKE ONLY" SYMBOL SIGN ON REFLECTING SHEETING AND AFFIX IT TO THE REFLECTIVE SHEETING AREA ON THE FACE OF THE FLEXIBLE VERTICAL PANEL. SIGN PANEL SHALL BE WHITE SIGN WITH BLACK LEGEND.

ALL COSTS ASSOCIATED WITH THE FABRICATION AND INSTALLATION OF THIS SIGN AND MOUNTING SHALL BE INCLUDED IN PAY ITEM 700-1-18.

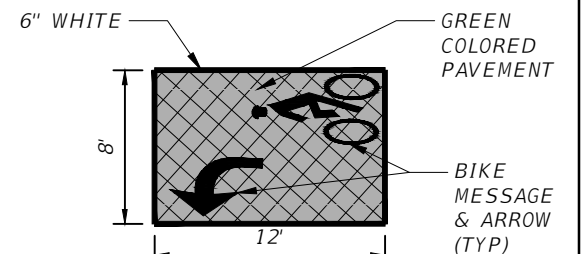

TYPICAL 2-STAGE BIKE BOX DETAIL
(NTS)

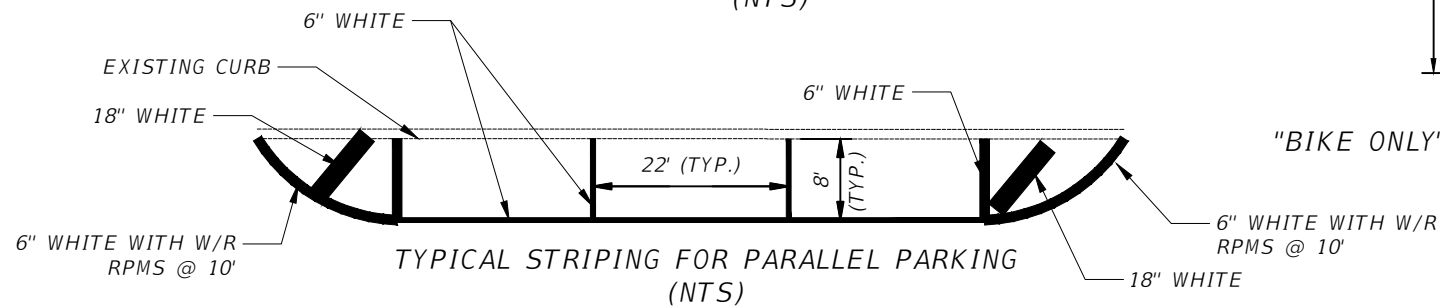

TYPICAL STRIPING FOR PARALLEL PARKING
(NTS)

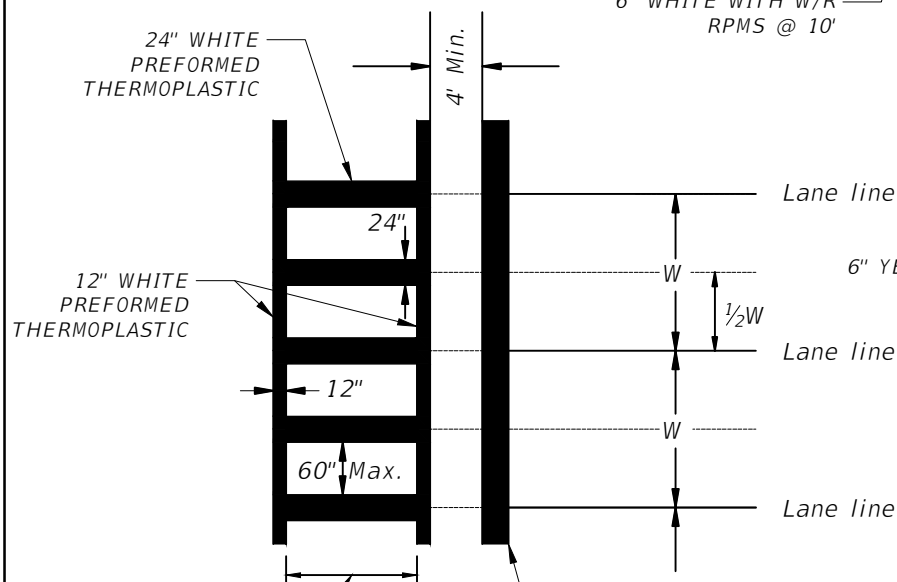

CROSSWALK WIDTH SHALL BE 10' UNLESS OTHERWISE NOTED IN THE PLANS

TYPICAL CROSSWALK DETAIL
(NTS)

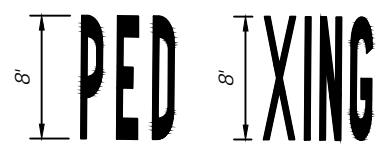

PEDESTRIAN MARKING DETAIL
(NTS)

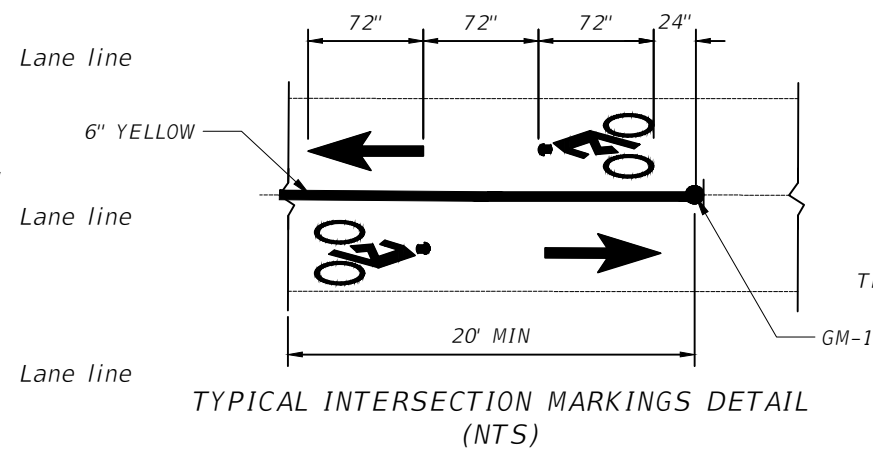

TYPICAL INTERSECTION MARKINGS DETAIL
(NTS)

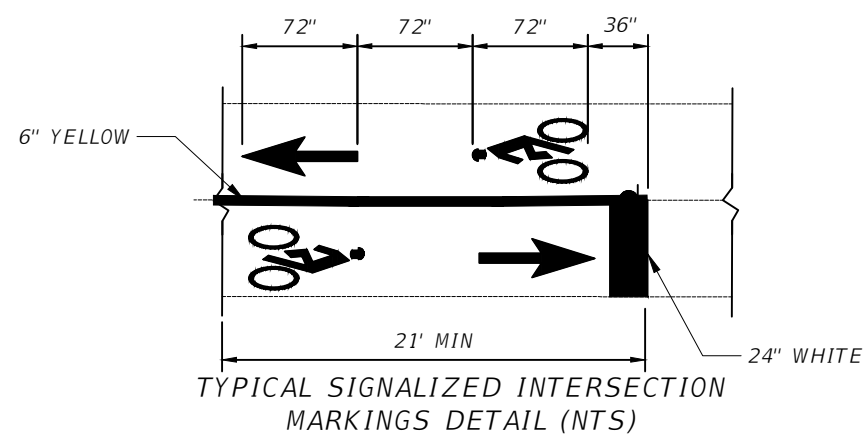

TYPICAL SIGNALIZED INTERSECTION MARKINGS DETAIL (NTS)

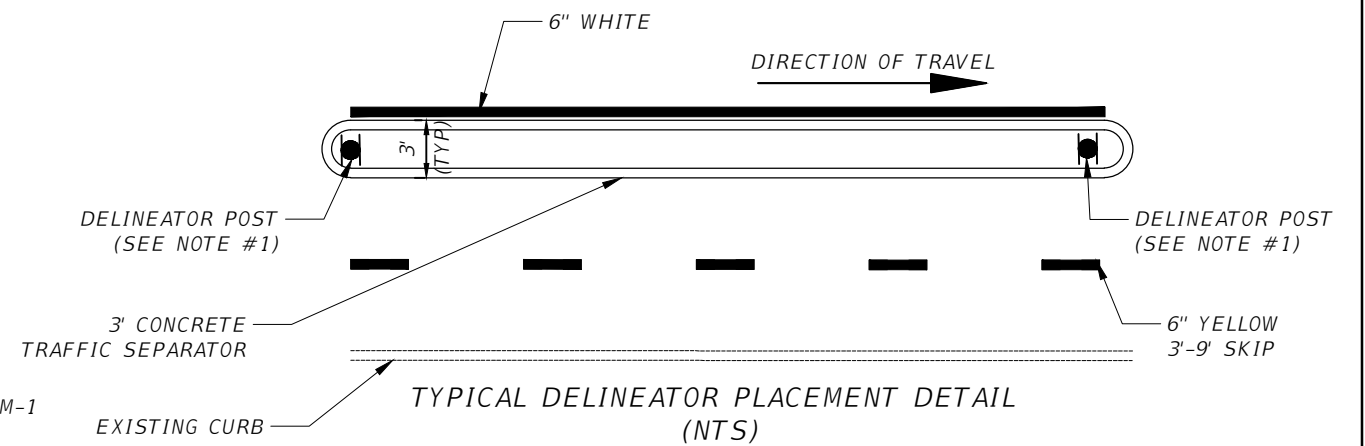

TYPICAL DELINEATOR PLACEMENT DETAIL
(NTS)

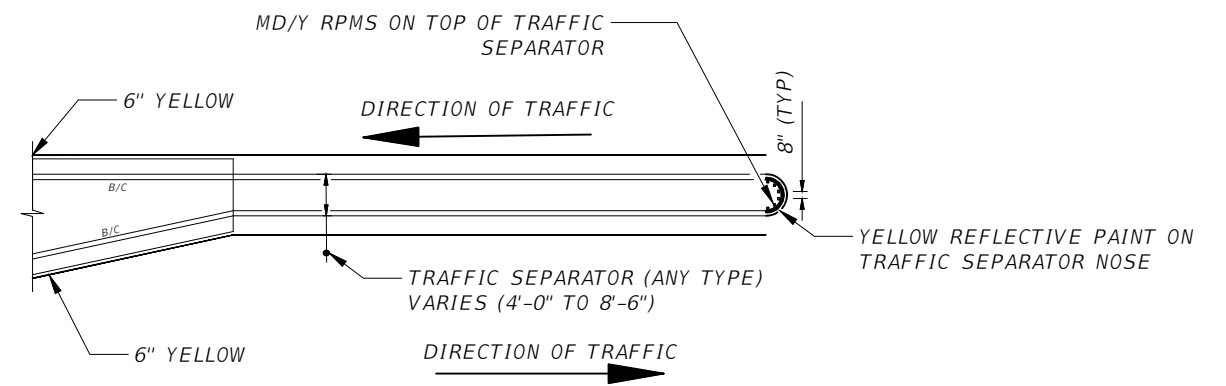

RPM PLACEMENT AT TRAFFIC SEPARATORS
DETAIL (NTS)

REVISIONS			
DATE	DESCRIPTION	DATE	DESCRIPTION

KISINGER CAMPO & ASSOCIATES CORP.
201 N FRANKLIN ST, SUITE 400,
TAMPA, FL 33602
ENGINEER OF RECORD:
FATHY ABDALLA, P.E. NO: 63914

CITY OF TAMPA MOBILITY DEPARTMENT		
ROAD NO.	COUNTY	PROJECT DESIGN NO.
	HILLSBOROUGH	21-C-00022

**SIGNING & PAVEMENT MARKING
DETAILS**

SHEET NO.
S-3

GENERAL NOTES:

1. USE YELLOW RETRO-REFLECTIVE SHEETING ON BOTH SIDES OF THE DELINEATOR. INSTALL THE POST SO THAT THE TOP IS 4' ABOVE THE GRADE AT THE EDGE OF THE PAVEMENT.
2. ALL PEDESTRIAN/BICYCLE WARNING SHALL BE IN ACCORDANCE WITH THE MUTCD, SECT. 1A-12, COLOR CODE "F"-FLUORESCENT YELLOW-GREEN.
3. PAVEMENT MARKINGS ON ASPHALT PAVEMENT SHALL BE STANDARD THERMOPLASTIC EXCEPT FOR BICYCLE MARKINGS AND SPECIAL EMPHASIS CROSSWALKS. USE PREFORMED THERMOPLASTIC FOR BICYCLE MARKINGS AND SPECIAL EMPHASIS CROSSWALKS.
4. UNLESS OTHERWISE NOTED ON PLAN SHEETS, ALL PROPOSED CROSSWALKS ACROSS MAIN STREETS SHALL BE 10' IN WIDTH AND ALL CROSSWALKS ACROSS SIDE STREETS SHALL BE 6' IN WIDTH. MEASUREMENTS SHALL BE FROM INSIDE TO INSIDE OF 12" STRIPES.
5. PAY ITEM FOOT NOTE
710-90 SHALL INCLUDE ALL PAVEMENT MARKINGS APPLICATIONS NEEDED BEFORE APPLYING THE THERMOPLASTIC APPLICATION.
6. ALL BRICK STREETS AND GRANITE CURBS SHALL BE RETAINED AND PRESERVED IN PLACE.

REVISIONS				KISINGER CAMPO & ASSOCIATES CORP. 201 N FRANKLIN ST, SUITE 400, TAMPA, FL 33602 ENGINEER OF RECORD: FATHY ABDALLA, P.E. NO: 63914	CITY OF TAMPA MOBILITY DEPARTMENT			GENERAL NOTES	SHEET NO.
DATE	DESCRIPTION	DATE	DESCRIPTION		ROAD NO.	COUNTY	PROJECT DESIGN NO.		S-4
						HILLSBOROUGH	21-C-00022		

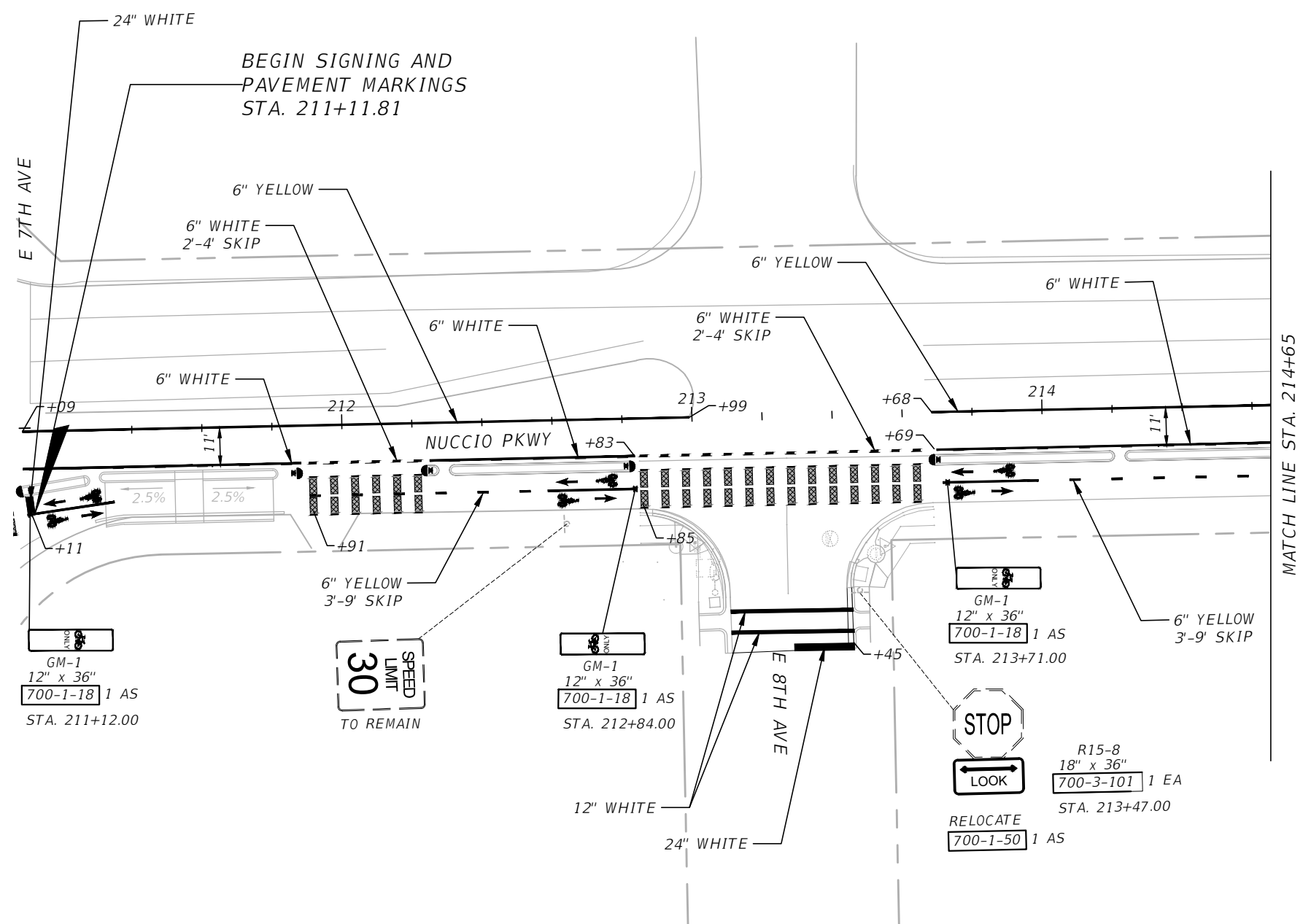
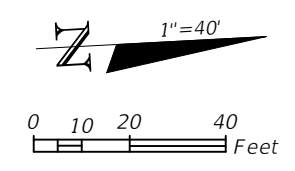

NOTE:
 SEE SHEET S-3 FOR DELINEATOR
 PLACEMENT DETAIL AND TYPICAL
 INTERSECTION MARKINGS DETAIL

705-11-3 5 EA

REVISIONS			
DATE	DESCRIPTION	DATE	DESCRIPTION

KISINGER CAMPO & ASSOCIATES CORP.
 201 N FRANKLIN ST, SUITE 400,
 TAMPA, FL 33602
 ENGINEER OF RECORD:
 FATHY ABDALLA, P.E. NO: 63914

CITY OF TAMPA MOBILITY DEPARTMENT		
ROAD NO.	COUNTY	PROJECT DESIGN NO.
	HILLSBOROUGH	21-C-00022

**SIGNING AND PAVEMENT
 MARKING PLAN (1)**

SHEET NO.
S-5

THE OFFICIAL RECORD OF THIS SHEET IS THE ELECTRONIC FILE DIGITALLY SIGNED AND SEALED UNDER RULE 61G15-23.004, F.A.C.

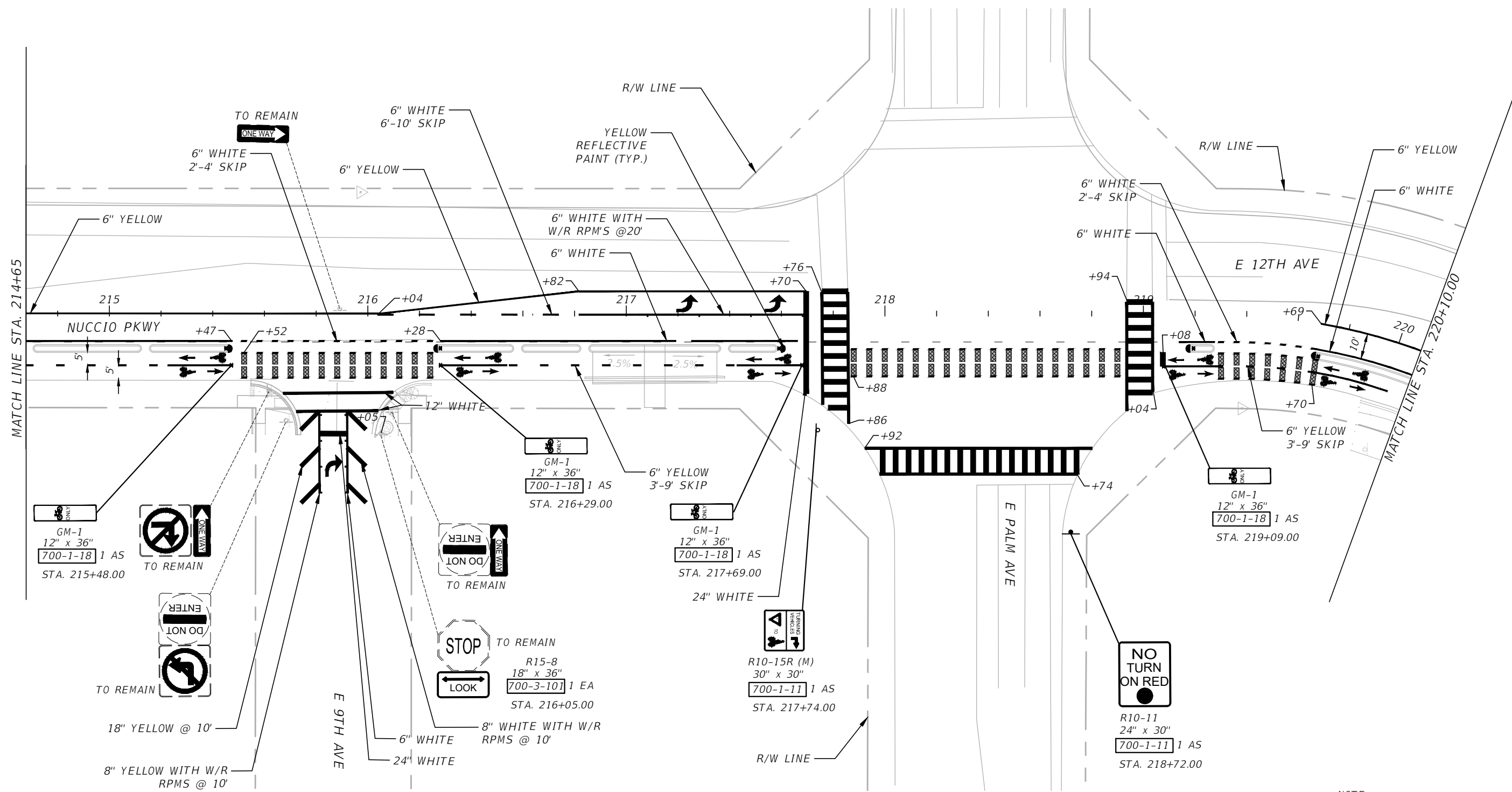
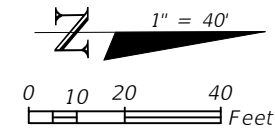

NOTE:
SEE SHEET S-3 FOR DELINEATOR
PLACEMENT DETAIL AND TYPICAL
INTERSECTION MARKINGS DETAIL

705-11-3 5 EA

REVISIONS			
DATE	DESCRIPTION	DATE	DESCRIPTION

KISINGER CAMPO & ASSOCIATES CORP.
201 N FRANKLIN ST, SUITE 400,
TAMPA, FL 33602
ENGINEER OF RECORD:
FATHY ABDALLA, P.E. NO: 63914

CITY OF TAMPA MOBILITY DEPARTMENT		
ROAD NO.	COUNTY	PROJECT DESIGN NO.
	HILLSBOROUGH	21-C-00022

**SIGNING AND PAVEMENT
MARKING PLAN (2)**

SHEET
NO.
S-6

THE OFFICIAL RECORD OF THIS SHEET IS THE ELECTRONIC FILE DIGITALLY SIGNED AND SEALED UNDER RULE 61G15-23.004, F.A.C.

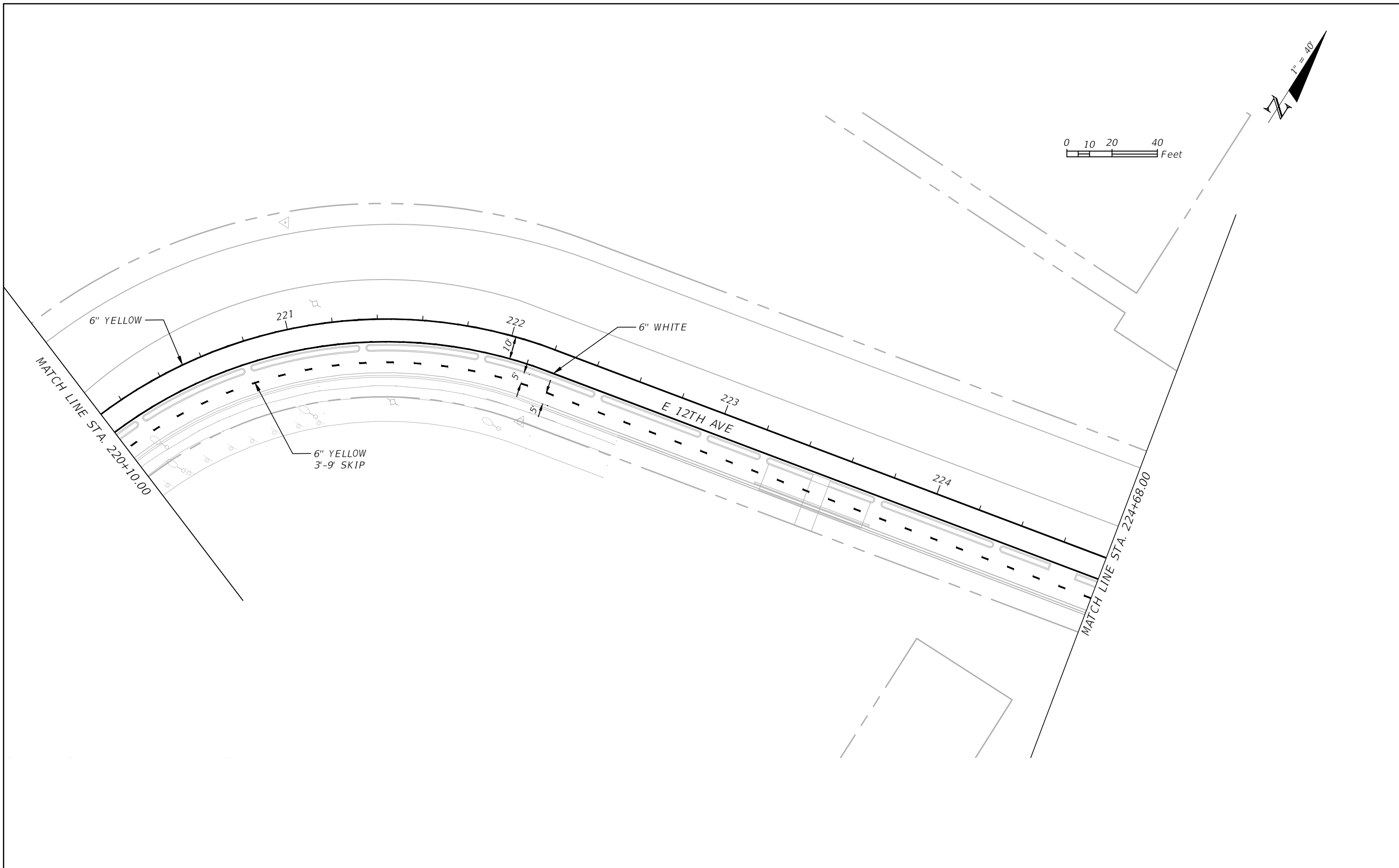

REVISIONS			
DATE	DESCRIPTION	DATE	DESCRIPTION

KISINGER CAMPO & ASSOCIATES CORP.
 201 N FRANKLIN ST, SUITE 400,
 TAMPA, FL 33602
 ENGINEER OF RECORD:
 FATHY ABDALLA, P.E. NO: 63914

CITY OF TAMPA MOBILITY DEPARTMENT		
ROAD NO.	COUNTY	PROJECT DESIGN NO.
	HILLSBOROUGH	21-C-00022

**SIGNING AND PAVEMENT
MARKING PLAN (3)**

SHEET NO.
S-7

THE OFFICIAL RECORD OF THIS SHEET IS THE ELECTRONIC FILE DIGITALLY SIGNED AND SEALED UNDER RULE 61G15-23.004, F.A.C.

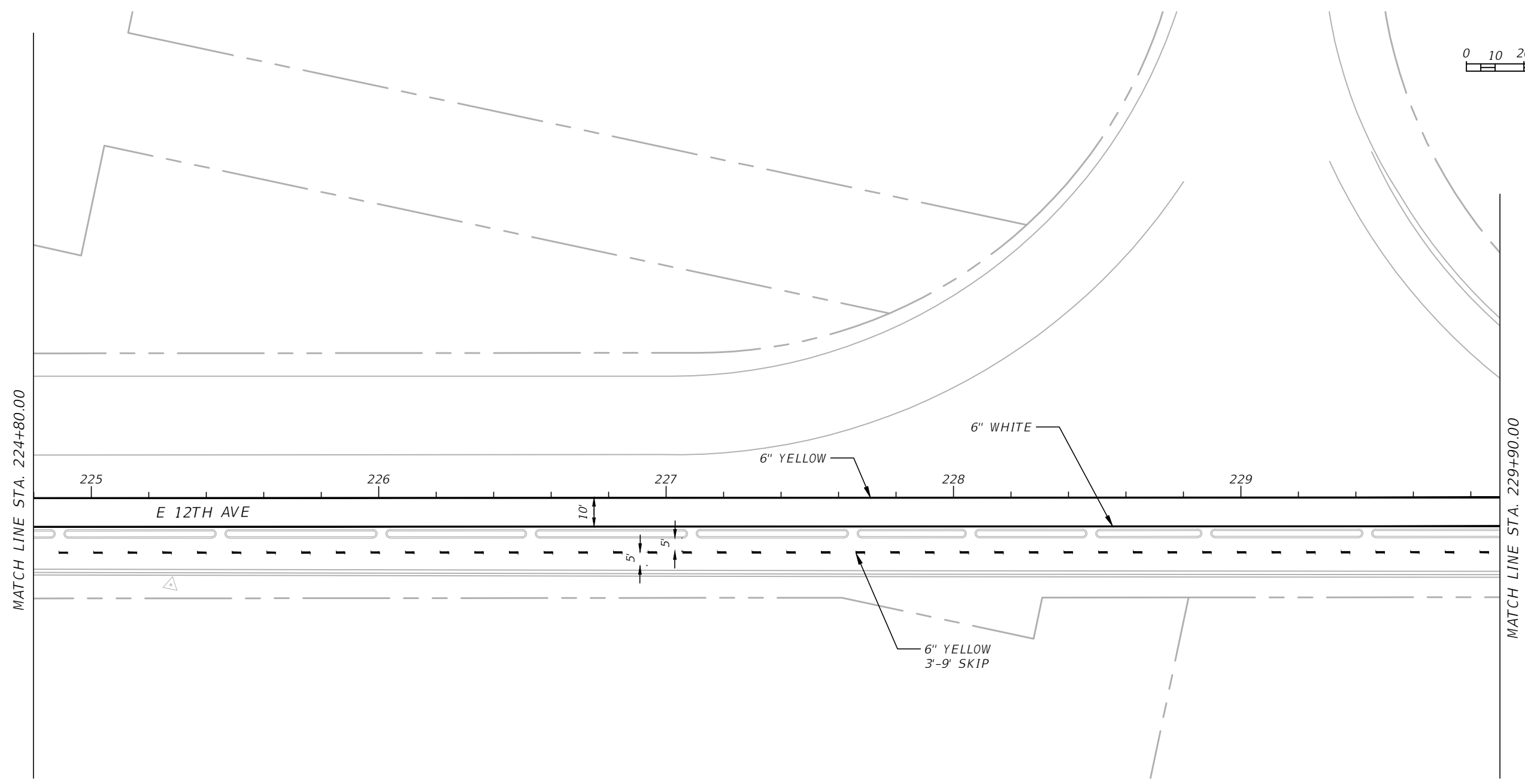
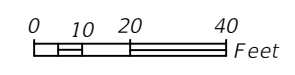
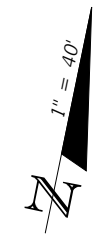

THE OFFICIAL RECORD OF THIS SHEET IS THE ELECTRONIC FILE DIGITALLY SIGNED AND SEALED UNDER RULE 61G15-23.004, F.A.C.

REVISIONS				KISINGER CAMPO & ASSOCIATES CORP. 201 N FRANKLIN ST, SUITE 400, TAMPA, FL 33602 ENGINEER OF RECORD: FATHY ABDALLA, P.E. NO: 63914	CITY OF TAMPA MOBILITY DEPARTMENT			SIGNING AND PAVEMENT MARKING PLAN (4)	SHEET NO.
DATE	DESCRIPTION	DATE	DESCRIPTION		ROAD NO.	COUNTY	PROJECT DESIGN NO.		S-8
					HILLSBOROUGH	21-C-00022			

Liviu Dosan 9/24/2021 10:55:46 AM

g:\2201706 green spine cycle track-cot\Civil\Autocad-current\DSGNSP01 - CITY - DA work_Phase3B.dwg

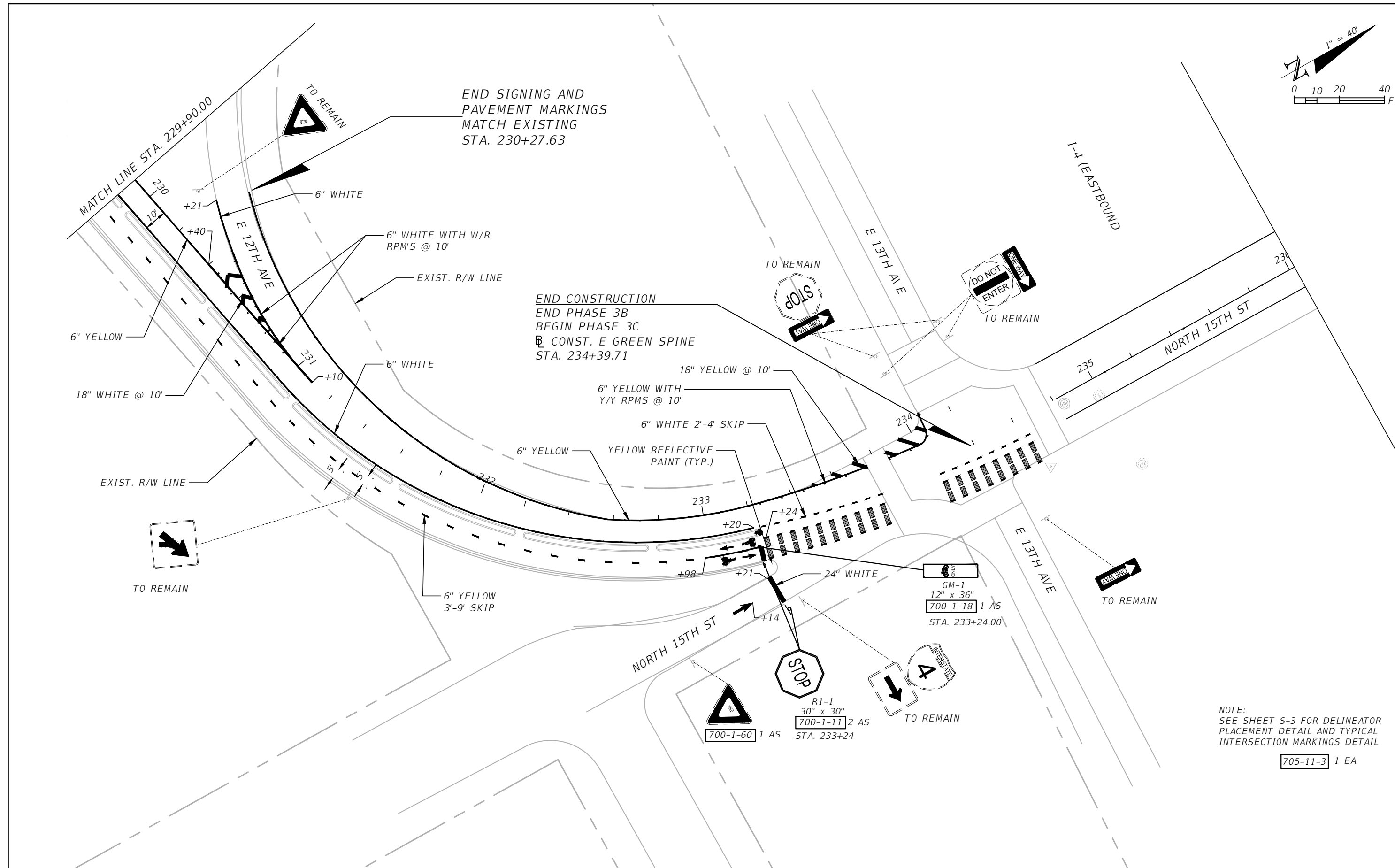
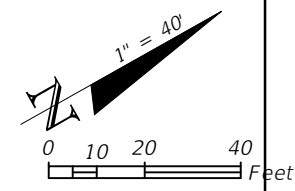

END SIGNING AND PAVEMENT MARKINGS
MATCH EXISTING
STA. 230+27.63

END CONSTRUCTION
END PHASE 3B
BEGIN PHASE 3C
CONST. E GREEN SPINE
STA. 234+39.71

NOTE:
SEE SHEET S-3 FOR DELINEATOR
PLACEMENT DETAIL AND TYPICAL
INTERSECTION MARKINGS DETAIL

705-11-3 1 EA

REVISIONS

DATE	DESCRIPTION	DATE	DESCRIPTION

KISINGER CAMPO & ASSOCIATES CORP.
201 N FRANKLIN ST, SUITE 400,
TAMPA, FL 33602
ENGINEER OF RECORD:
FATHY ABDALLA, P.E. NO: 63914

CITY OF TAMPA MOBILITY DEPARTMENT		
ROAD NO.	COUNTY	PROJECT DESIGN NO.
	HILLSBOROUGH	21-C-00022

**SIGNING AND PAVEMENT
MARKING PLAN (5)**

SHEET NO.
S-9

THE OFFICIAL RECORD OF THIS SHEET IS THE ELECTRONIC FILE DIGITALLY SIGNED AND SEALED UNDER RULE 61G15-23.004, F.A.C.