



**City of Tampa**

*Jane Castor, Mayor*

**Contract Administration**  
**Michael W. Chucran, Director**

306 East Jackson Street, 4N  
Tampa, FL 33602

Office (813) 274-8116

Fax: (813) 274-7368

**ADDENDUM 2**

**Via E-Mail**

**DATE: April 1, 2022**

Contract: 22-C-00006; Belmar Gardens Wastewater Collection System Rehabilitation By CIPP

Bidders on the above referenced project are hereby notified that the following addendum is made to the Contract Documents. BIDS TO BE SUBMITTED SHALL CONFORM TO THIS NOTICE.

Item 1: Replace Proposal page P-2 with the attached Proposal page P-2R.

Item 2: Replace Plan Sheet Nos. 3, 5, 8 and 9 with the attached Plan Sheet Nos. 3, 5, 8 and 9.

All other provisions of the Contract Documents and Specifications not in conflict with this Addendum shall remain in full force and effect. Questions are to be e-mailed to [ContractAdministration@tampagov.net](mailto:ContractAdministration@tampagov.net).

*Jim Greiner*

Jim Greiner, P.E., Contract Management Supervisor

**Belmar Gardens Wastewater Collection System Rehabilitation By CIPP  
Contract; 22-C-00006**

Item No.	Item	Quantity	Unit	Unit Price in Words	Unit Price	Total
100	Contingency	1	LS	one hundred thousand dollars	100,000	100,000
102	Maintenance of Traffic	1	LS	ten thousand dollars	10,000	10,000
0408.2360	Cured in Place Pipe for 8" Dia. Gravity Sewer (.236 inch thick)	21,424	LF			
0410.2950	Cured in Place Pipe for 10" Dia. Gravity Sewer (.295 inch thick)	327	LF			
0416.2950	Cured in Place Pipe for 16" Dia. Gravity Sewer (.295 inch thick)	74	LF			
0601.08	Hydraulic Cleaning & Inspection of 8" Dia. Gravity Sewer	21,424	LF			
0601.10	Hydraulic Cleaning & Inspection of 10" Dia. Gravity Sewer	327	LF			
0601.16	Hydraulic Cleaning & Inspection of 16" Dia. Gravity Sewer	30	LF			
0622	Cleaning & Inspection of Tuberculated Cast Iron or Ductile Iron Sewer, 15" Dia. & greater	44	LF			
0700	Disposal of Debris	21	CY			
2050	Reconnect Service Connections	390	EA			
2051.08	Chemical Grout Unit - chemical grout lateral post liner install - 8-inch gravity pipe diameter	389	LF			
2051.10	Chemical Grout Unit - chemical grout lateral post liner install - 10-inch gravity pipe diameter	1	LF			
4600	Cast Iron Frame and Cover	2	EA			
4800	Manhole Rehabilitation by Coating System min. 250 mils thickness	9,700	SF			
9000	Sewer Bypass with Tanker Truck	10	E.D.			
9050.08	Sewage Bypass Pumping for 8" Dia. Sewer	21,424	LF			
9050.10	Sewage Bypass Pumping for 10" Dia. Sewer	327	LF			
9050.16	Sewage Bypass Pumping for 16" Dia. Sewer	74	LF			
	<b>Total</b>				<b>Total</b>	



**Legend**

- ▲ Addendum - Removed pipe segments from plan sheets
- Proposed Manhole Rehabilitation
- Ex Manhole (no rehabilitation required)
- ▶— Proposed Lining Area
- ▶— Proposed Lining Area
- - - Ex Wastewater (no rehabilitation required)

**Belmar Gardens**  
**City of Tampa Wastewater Department**



Sheet No. **3**

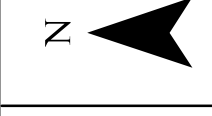

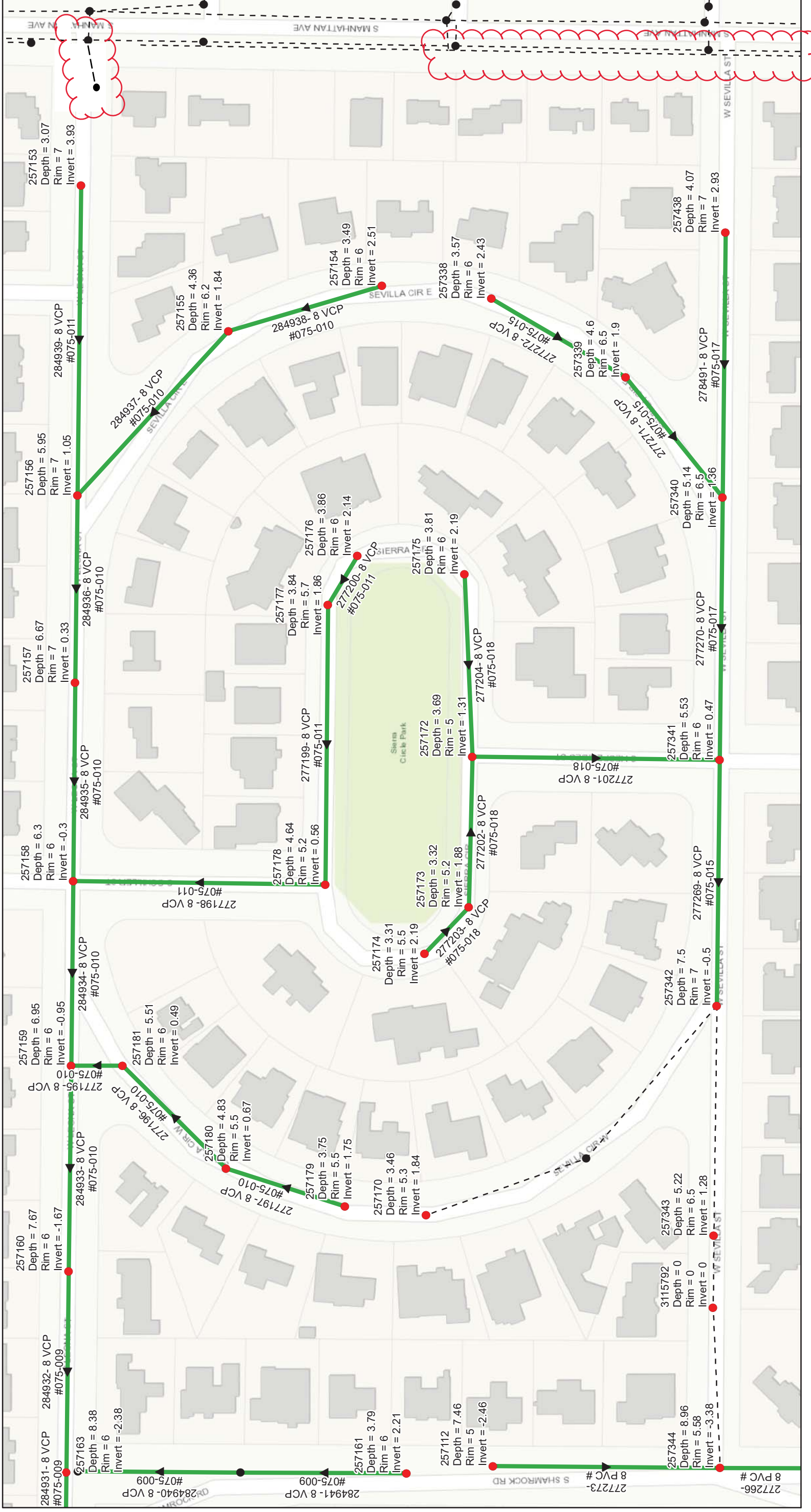

N

Sheet No. **5**

**Belmar Gardens**  
City of Tampa Wastewater Department

**Legend**

- Addendum - Removed pipe segments from plan sheets
- Proposed Manhole Rehabilitation
- Ex Manhole (no rehabilitation required)
- Proposed Lining Area
- Ex Wastewater (no rehabilitation required)

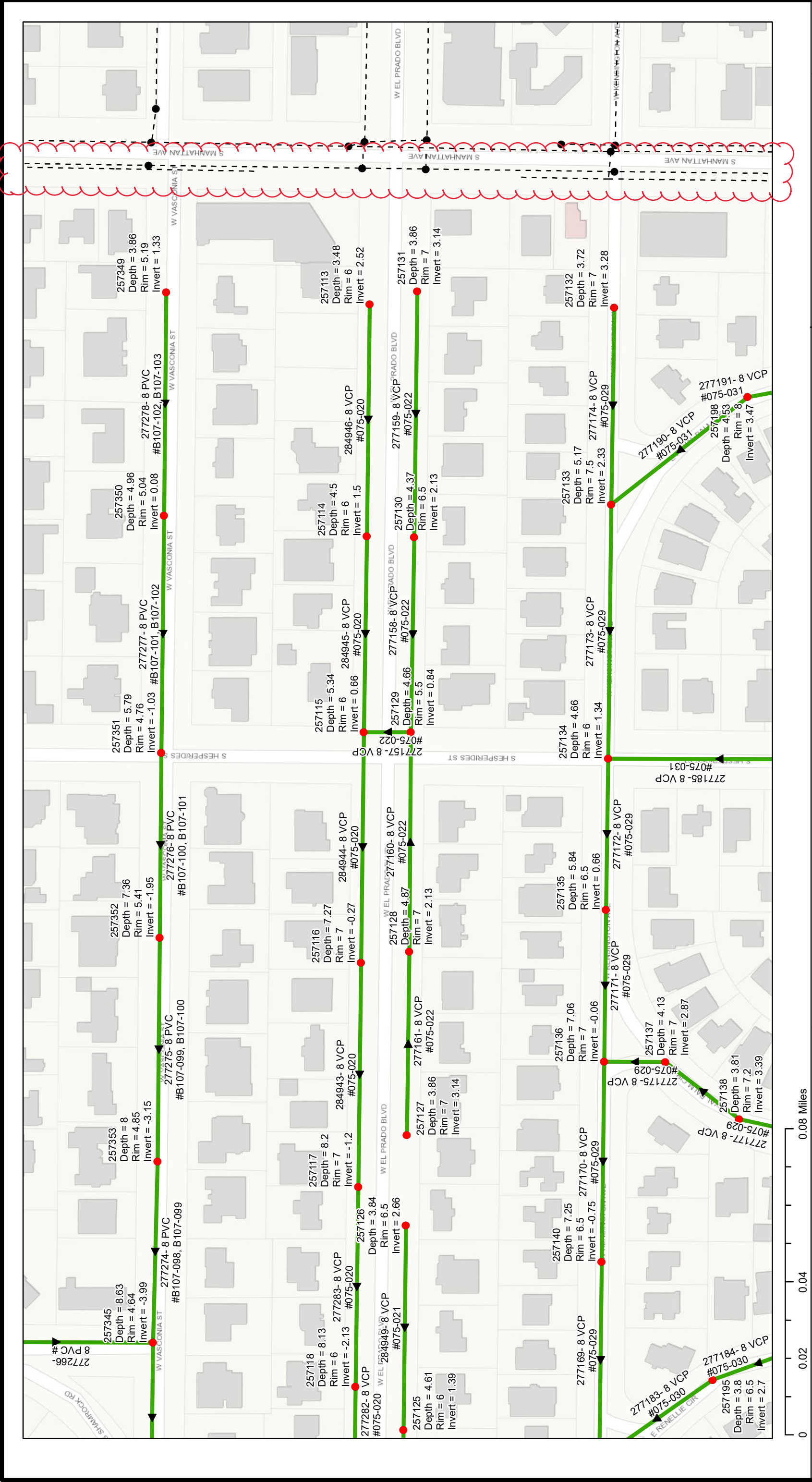

Sheet No. **8**



- Legend**
- ▲ Addendum - Removed pipe segments from plan sheets
  - Proposed Manhole Rehabilitation
  - Ex Manhole (no rehabilitation required)
  - Proposed Lining Area
  - Proposed Manhole Rehabilitation
  - Ex Wastewater (no rehabilitation required)

0 0.02 0.04 0.08 Miles

# Belmar Gardens

## City of Tampa Wastewater Department

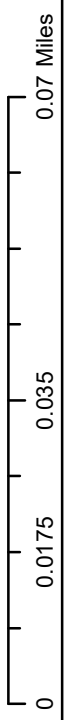
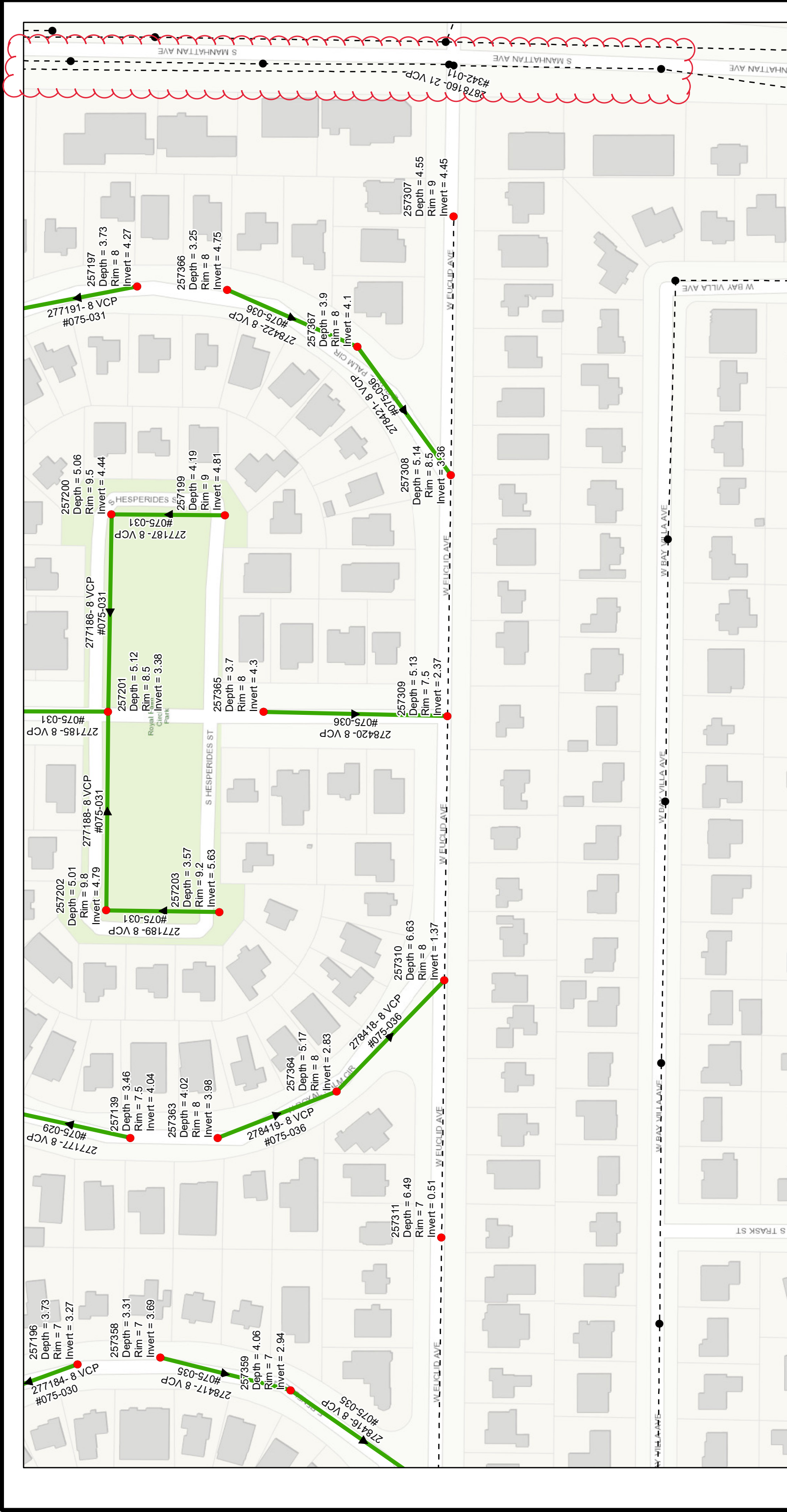

**Legend**

- ▲ Addendum - Removed pipe segments from plan sheets
- Proposed Manhole Rehabilitation
- Ex Manhole (no rehabilitation required)
- Proposed Lining Area
- Ex Wastewater (no rehabilitation required)



Sheet No.

**9**



**Belmar Gardens**  
City of Tampa Wastewater Department