

CITY OF TAMPA MOBILITY DEPARTMENT

CONTRACT PLANS

ROADWAY PLANS

SULPHUR SPRINGS NORTH TAMPA PARK SIDEWALK 8608 N 12TH STREET

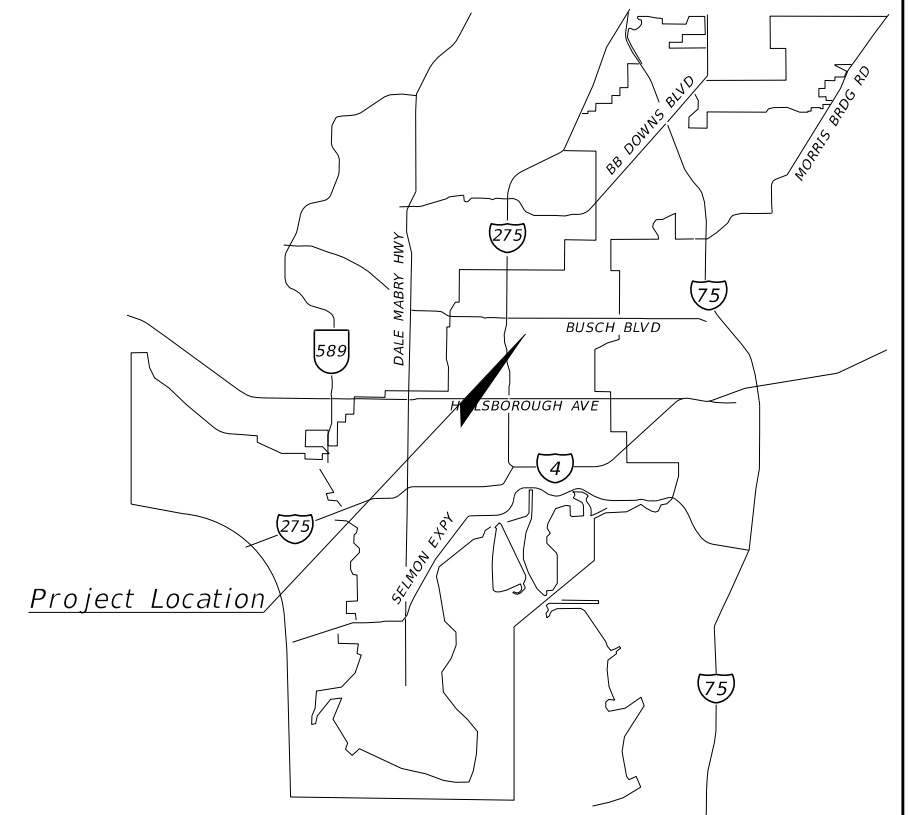

INDEX OF DRAWINGS	
SHEET NO.	SHEET DESCRIPTION
1	KEY SHEET
2	SUMMARY OF PAY ITEMS
3	TYPICAL SECTION
4	GENERAL NOTES
5	SIDEWALK PLAN
6	CROSS SECTIONS
7	SIGNING AND PAVEMENT MARKING PLAN
8	TEMPORARY TRAFFIC CONTROL PLAN

BEGIN PROJECT
STA. 18+80.00
℄ CONST. N 12TH ST.

END PROJECT
STA. 20+90.00
℄ CONST. N 12TH ST.

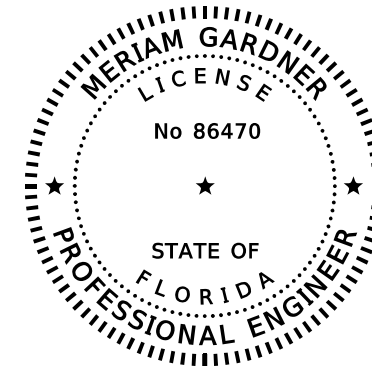
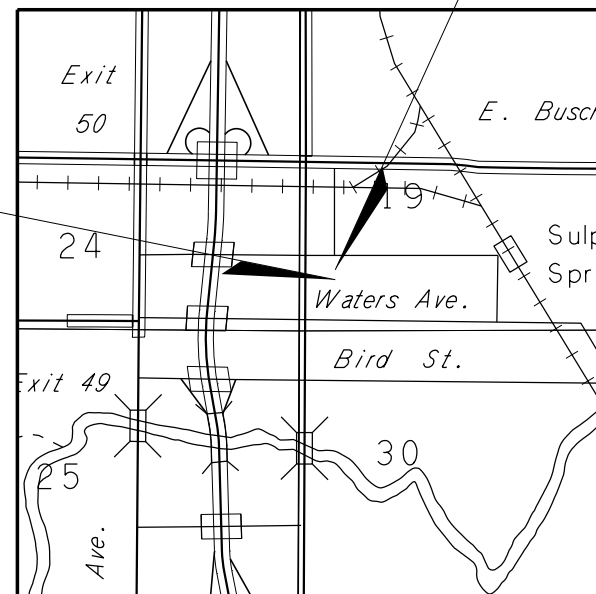

THIS ITEM HAS BEEN DIGITALLY
SIGNED AND SEALED BY:



ON THE DATE ADJACENT TO THE SEAL
PRINTED COPIES OF THIS DOCUMENT ARE
NOT CONSIDERED SIGNED AND SEALED
AND THE SIGNATURE MUST BE VERIFIED
ON ANY ELECTRONIC COPIES.

ROADWAY PLANS
ENGINEER OF RECORD:
MERIAM GARDNER
P.E. NO. 86470
FLORIDA TRANSPORTATION ENGINEERING, INC.
11458 N. 53rd STREET
TAMPA, FLORIDA 33617
CONTRACT NO.: 20-D-47909
VENDOR NO.: F65-0183924

CITY OF TAMPA PROJECT MANAGER
JOLANTA OLBINSKA, P.E.

GOVERNING STANDARDS AND SPECIFICATIONS
FLORIDA DEPARTMENT OF TRANSPORTATION FY
2021-22 DESIGN STANDARDS AND REVISED
INDEX DRAWING AS APPENDED HEREIN, AND
JANUARY 2022 STANDARD SPECIFICATIONS FOR
ROAD AND BRIDGE CONSTRUCTION, AS
AMENDED BY CONTRACT DOCUMENTS AND THE
CITY OF TAMPA.

APPLICABLE IRs: 711-001

CIP NO.	FISCAL YEAR	SHEET NO.
1001179	22	1

THE OFFICIAL RECORD OF THIS SHEET IS THE ELECTRONIC FILE DIGITALLY SIGNED AND SEALED UNDER RULE 61G15-23.004, F.A.C.

SUMMARY OF PAY ITEMS

PAY ITEM NO.	DESCRIPTION	UNIT	QUANTITY
101-1	MOBILIZATION	LS	1
102-1	MAINTENACE OF TRAFFIC	LS	1
102-60	WORK ZONE SIGN	ED	320
102-74-1	CHANNELIZING DEVICE- TYPES I, II, DI, VP, DRUM, OR LCD	ED	620
102-74-6	CHANNELIZING DEVICE- PEDESTRIAN LCD (LONGITUDINAL CHANNELIZING DEVICE)	ED	80
104-10-3	SEDIMENT BARRIER	LF	30
104-18	INLET PROTECTION SYSTEM	EA	4
110-1-1	CLEARING & GRUBBING	LS/AC	1/0.05
110-4-1	REMOVAL OF EXISTING CONCRETE SIDEWALK	SY	26
120-1	REGULAR EXCAVATION	CY	14.1
120-6	EMBANKMENT	CY	6.9
327-70-1	MILLING EXISTING ASPHALT PAVEMENT, 1" AVG DEPTH	SY	371
334-1-03	SUPERPAVE ASPHALTIC CONCRETE TYPE S-3	TN	20.4
520-2-4	TYPE D CONCRETE CURB	LF	88
522-1	CONCRETE SIDEWALK 4" TK	SY	98
522-2	CONCRETE SIDEWALK 6" TK	SY	27
527-2	DETECTABLE WARNINGS (RED)	SF	12
542-70	BUMPER GUARD, CONCRETE	EA	9
570-1-2	PERFORMANCE TURF, SOD	SY	46
700-1-11	SINGLE POST SIGN, F&I, GROUND MOUNT LESS THAN 12 SF	AS	1
700-1-60	SINGLE POST SIGN (REMOVE)	AS	1
711-11-160	THERMOPLASTIC, STD, WHITE, MESSAGE	EA	1
711-11-421	THERMOPLASTIC, STANDARD, BLUE, SOLID, 6"	LF	57
711-16-101	THERMOPLASTIC PAVEMENT MARKINGS, STD.-OTHER SURFACES, WHITE, SOLID, 6"	GM	0.081
1080-21-300	UTILITY FIXTURE, VALVE/METER BOX, INSTALL- BOX FURNISHED BY UTILITY	EA	1
1080-21-500	UTILITY FIXTURE, VALVE/METER BOX, ADJUST	EA	1

REVISIONS				MERIAM GARDNER, P.E. P.E. LICENSE NUMBER 86470 FLORIDA TRANSPORTATION ENGINEERING, INC. 11458 NORTH 53RD STREET TAMPA, FLORIDA 33617	CITY OF TAMPA MOBILITY DEPARTMENT			SUMMARY OF PAY ITEMS	SHEET NO.
DATE	DESCRIPTION	DATE	DESCRIPTION		STREET	COUNTY	FINANCIAL PROJECT ID		
						12"	HILLSBOROUGH		

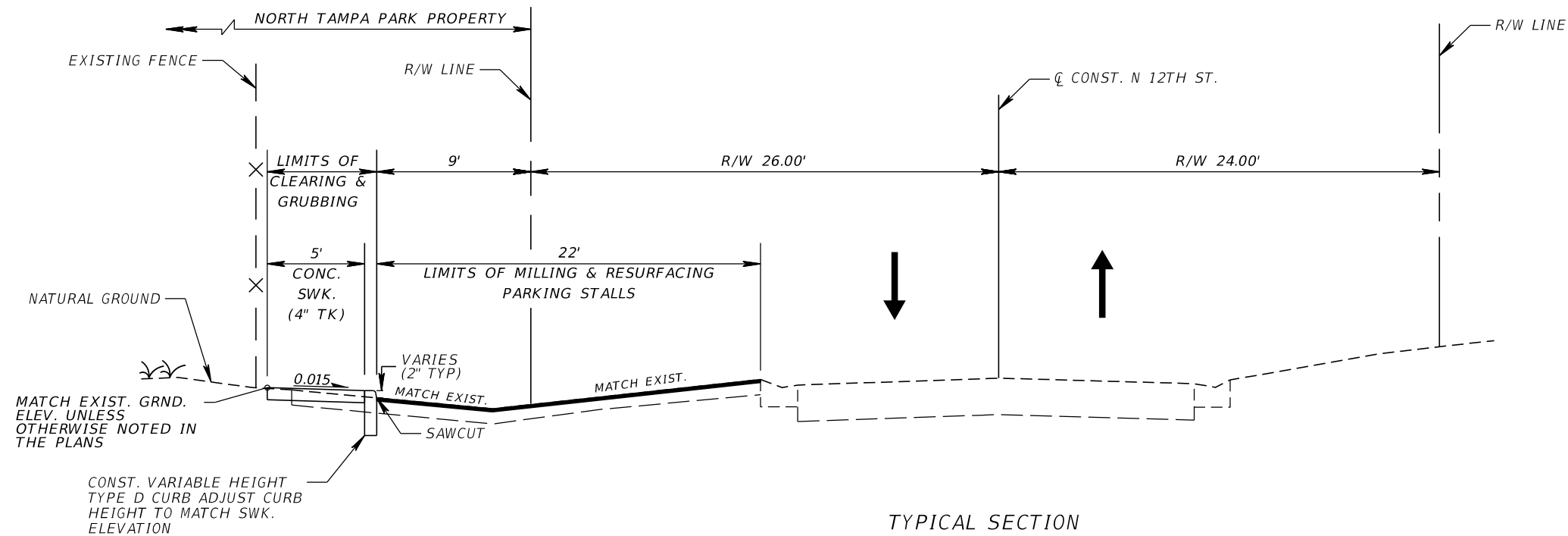

TYPICAL SECTION
STA. 18+80.00 TO STA. 20+90.00

PARKING STALLS

MILL EXIST. ASPHALT PAVEMENT (1" DEPTH
S-3 STRUCTURAL COURSE (1")

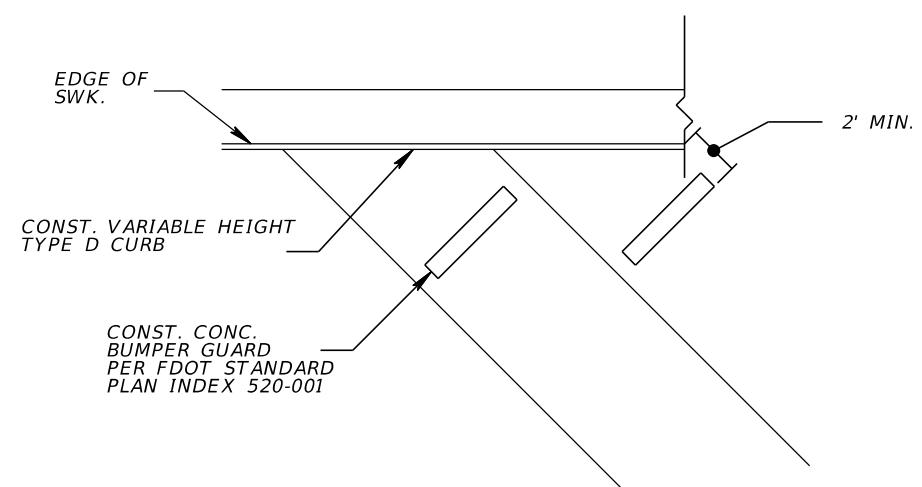

BUMPER GUARD OVERHANG DETAIL

TRAFFIC DATA

DESIGN SPEED = 30 MPH
POSTED SPEED = 25 MPH

REVISIONS				MERIAM GARDNER, P.E. P.E. LICENSE NUMBER 86470 FLORIDA TRANSPORTATION ENGINEERING, INC. 11458 NORTH 53RD STREET TAMPA, FLORIDA 33617	CITY OF TAMPA MOBILITY DEPARTMENT			SHEET NO. 3
DATE	DESCRIPTION	DATE	DESCRIPTION		STREET	COUNTY	FINANCIAL PROJECT ID	
				12"	HILLSBOROUGH		TYPICAL SECTION	

GENERAL NOTES

1. BENCHMARK ELEVATIONS SHOWN ON THE PLANS ARE NORTH AMERICAN VERTICAL DATUM OF 1988 (NAVD 88).
2. PROJECT IS BASED ON THE STATE PLANE COORDINATE SYSTEM, FLORIDA WEST ZONE, NAD 1983/2011 HORIZONTAL DATUM.
3. SURVEY INFORMATION WAS OBTAINED FROM A LICENSED FLORIDA PROFESSIONAL SURVEYOR AND MAPPER AND UTILIZED AS SUPPORTING DATA IN THE PRODUCTION OF DESIGN PLANS AND FOR CONSTRUCTION ON SUBJECT PROJECT. THE PROFESSIONAL SURVEYOR AND MAPPER OF RECORD IS:

 BEN R. HOMOLA, P.S.M.
 P.S.M NO: 3950
 AIM ENGINEERING AND SURVEYING INC.
 3802 CORPOREX PARK DR, TAMPA, FL 33619
4. THE BOUNDARY SURVEY WAS OBTAINED FROM A LICENSED FLORIDA PROFESSIONAL SURVEYOR AND MAPPER AND UTILIZED AS SUPPORTING DATA IN THE PRODUCTION OF DESIGN PLANS AND FOR CONSTRUCTION ON SUBJECT PROJECT. THE PROFESSIONAL SURVEYOR AND MAPPER OF RECORD IS:

 CLEARANCE WADE, III, P.S.M.
 P.S.M. NO: 4383
 CITY OF TAMPA MOBILITY DEPARTMENT SURVEY SECTION
 3808 E 26TH AVE, TAMPA, FL, 33605
5. ANY EXISTING SIGN TO REMAIN THAT IS DISTURBED DURING CONSTRUCTION SHALL BE RESET TO CURRENT STANDARDS FOR HEIGHT, OFFSET, AND METHOD OF INSTALLATION.
6. DETECTABLE WARNINGS TO BE COLOR RED.
7. WATER METER BOX COVER TO BE FURNISHED BY THE CITY OF TAMPA. COORDINATE WITH CITY OF TAMPA INSPECTOR.
8. THE EXISTING UTILITIES ARE TO REMIAN IN PLACE UNLESS OTHERWISE SHOWN IN THE PLANS.
9. THE CONTRACTOR SHALL NOTIFY UTILITY OWNERS OF ANY EXCAVATION OR DEMOLITION ACTIVITY THROUGH SUNSHINE ONE-CALL OF FLORIDA INC. (1-800-432-4770) AND SHALL ALSO NOTIFY THOSE UTILITY OWNERS/AGENCIES LISTED WITHIN OR IMPACTED BY THESE PLANS, NOT LESS THAN TWO (2) FULL BUSINESS DAYS IN ADVANCE OF THE BEGINNING OF CONSTRUCTION ON THE JOB SITE.

<u>COMPANY</u>	<u>CONTACT</u>	<u>PHONE NUMBER</u>
UTILITY AGENCY OWNERS: CHARTER (SPECTRUM)	SCOTT CREASY	(727) 329-2817
CITY OF TAMPA WATER DEPT	KIMANI THOMAS	(813) 274-7391
CITY OF TAMPA WASTEWATER DEPT	DARRELL HILL	(813) 274-8081
CROWN CASTLE	MICHAEL GARRISON	(407) 341-5350
FRONTIER	RANDALL JAMES	(813) 892-9692
TAMPA ELECTRIC	HEATHER LOVETT	(813) 275-3433
TAMPA PEOPLES GAS	JAMES HAMILTON	(813) 275-3732

BENCHMARKS

503 SMND CITY OF TAMPA T. & S.S. SURVEY CONTROL 18+42.49 / 19.34' (LT.), C CONST. N 12TH ST. Y: 1343062.183 X: 511844.063 EL. 32.78'	504 SMND CITY OF TAMPA T. & S.S. SURVEY CONTROL Y: 1343405.904 X: 511852.837 EL. 36.00'
--	--

LEGEND

- B/L = SURVEY BASELINE
- POT = POINT ON TANGENT
- SMND = SET MAGNETIC NAIL AND DISK
- SIRC = SET IRON ROD AND CAP
- STA. = SURVEY BASELINE STATION
- BM = BENCHMARKS

REVISIONS				MერიAM GARDNER, P.E. P.E. LICENSE NUMBER 86470 FLORIDA TRANSPORTATION ENGINEERING, INC. 11458 NORTH 53RD STREET TAMPA, FLORIDA 33617	CITY OF TAMPA MOBILITY DEPARTMENT			GENERAL NOTES	SHEET NO.
DATE	DESCRIPTION	DATE	DESCRIPTION		STREET	COUNTY	FINANCIAL PROJECT ID		
					12"	HILLSBOROUGH			

NORTH TAMPA PARK
8608 N 12TH STREET

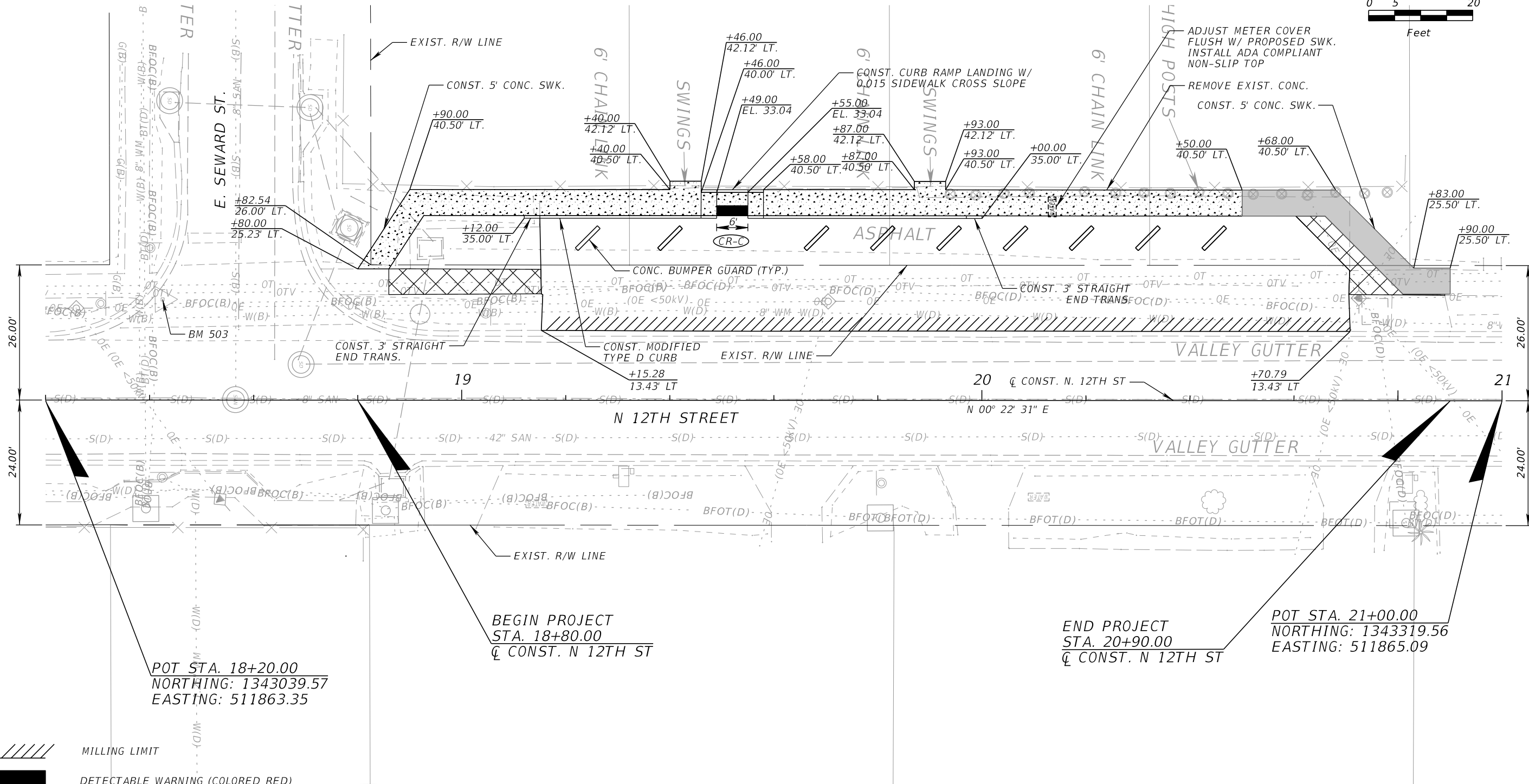
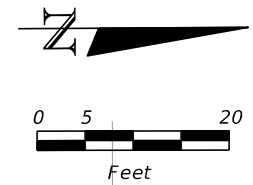

POT STA. 18+20.00
NORTHING: 1343039.57
EASTING: 511863.35

BEGIN PROJECT
STA. 18+80.00
Q̄ CONST. N 12TH ST

END PROJECT
STA. 20+90.00
Q̄ CONST. N 12TH ST

POT STA. 21+00.00
NORTHING: 1343319.56
EASTING: 511865.09

- MILLING LIMIT
- DETECTABLE WARNING (COLORED RED)
- REMOVE EXIST. ASPHALT OR CONC.
REGRADE AND SOD
- 4" THICK CONC. SIDEWALK
- 6" THICK CONC. SIDEWALK

REVISIONS				MERIAM GARDNER, P.E. P.E. LICENSE NUMBER 86470 FLORIDA TRANSPORTATION ENGINEERING, INC. 11458 NORTH 53RD STREET TAMPA, FLORIDA 33617	CITY OF TAMPA MOBILITY DEPARTMENT			SHEET NO. 5
DATE	DESCRIPTION	DATE	DESCRIPTION		STREET	COUNTY	FINANCIAL PROJECT ID	
				12"	HILLSBOROUGH		SIDEWALK PLAN	

THE OFFICIAL RECORD OF THIS SHEET IS THE ELECTRONIC FILE DIGITALLY SIGNED AND SEALED UNDER RULE 61G15-23.004, F.A.C.

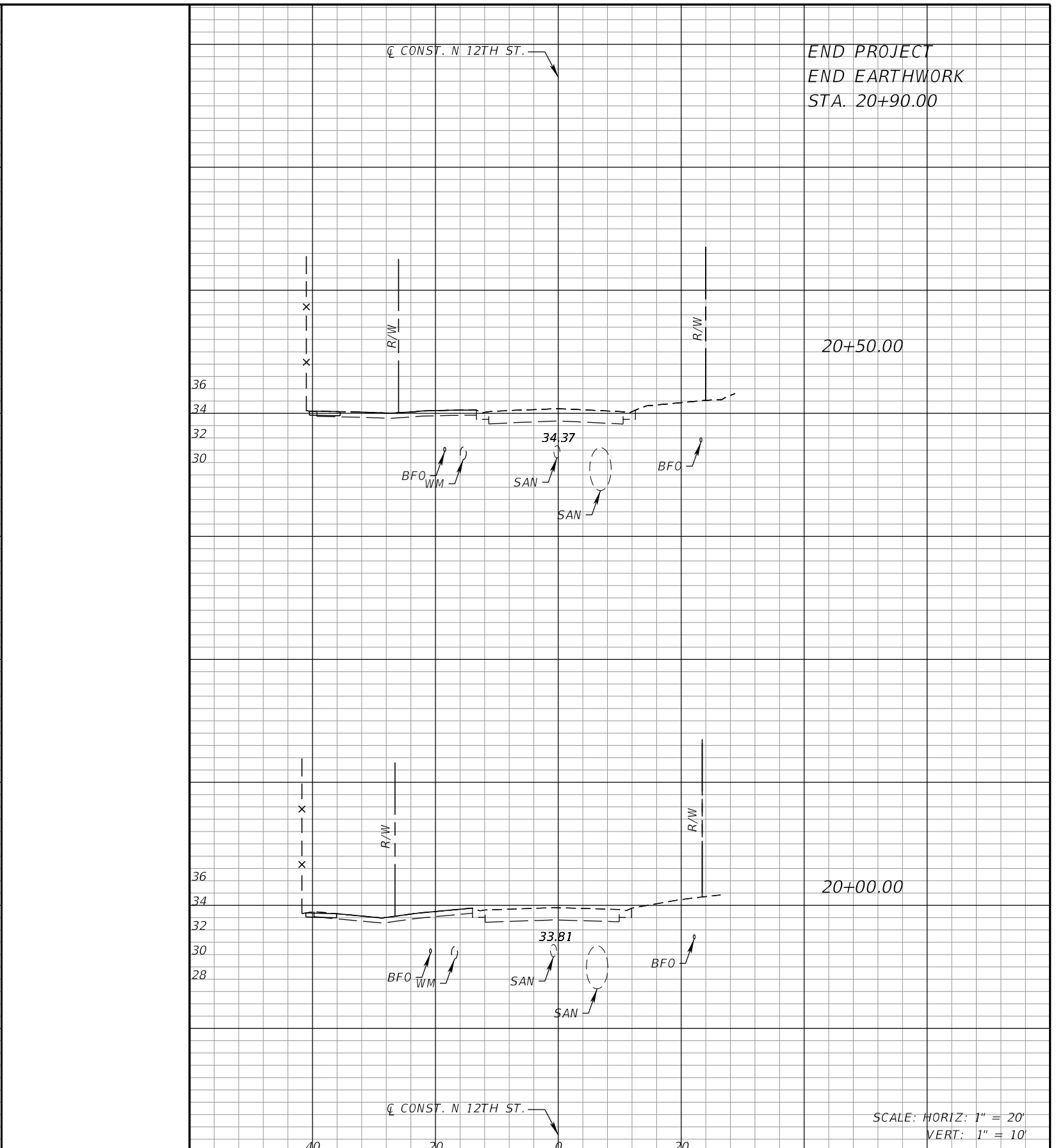
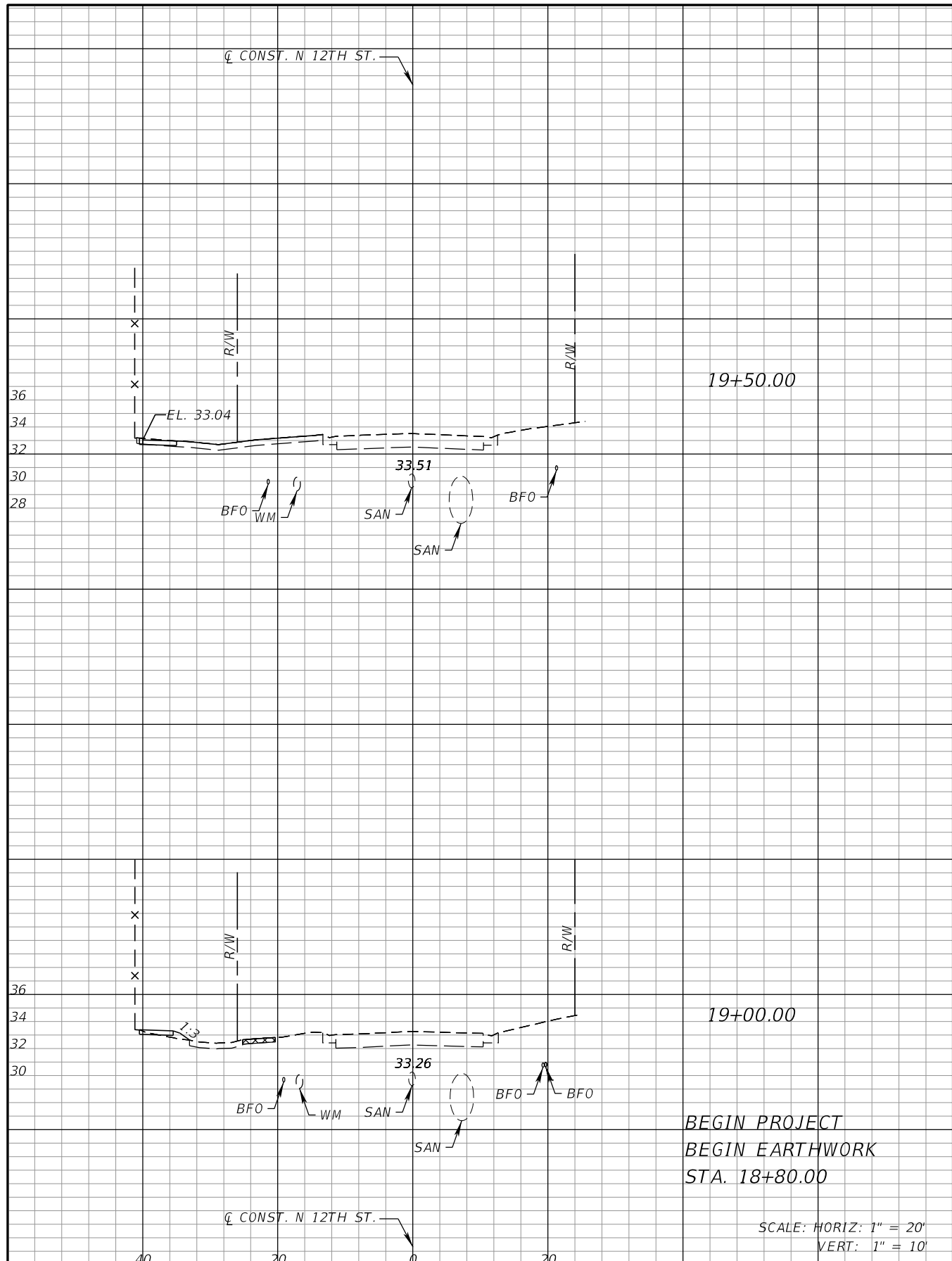

No.	DATE	REVISIONS
3		
2		
1		

Florida Transportation Engineering, Inc.
 11458 N. 53rd Street
 Tampa, FL 33617
 Phone: (813) 989-0729
 Meriam Gardner, P.E., No. 86470

DES: CC
 DRN: MG
 CKD:
 DATE:

CITY of TAMPA
 Department of Transportation
 and Stormwater Services

CROSS SECTIONS

W.O.
 SHEET
 6
 OF 8

THE OFFICIAL RECORD OF THIS SHEET IS THE ELECTRONIC FILE DIGITALLY SIGNED AND SEALED UNDER RULE 61G15-23.004, F.A.C.

NORTH TAMPA PARK
8608 N 12TH STREET

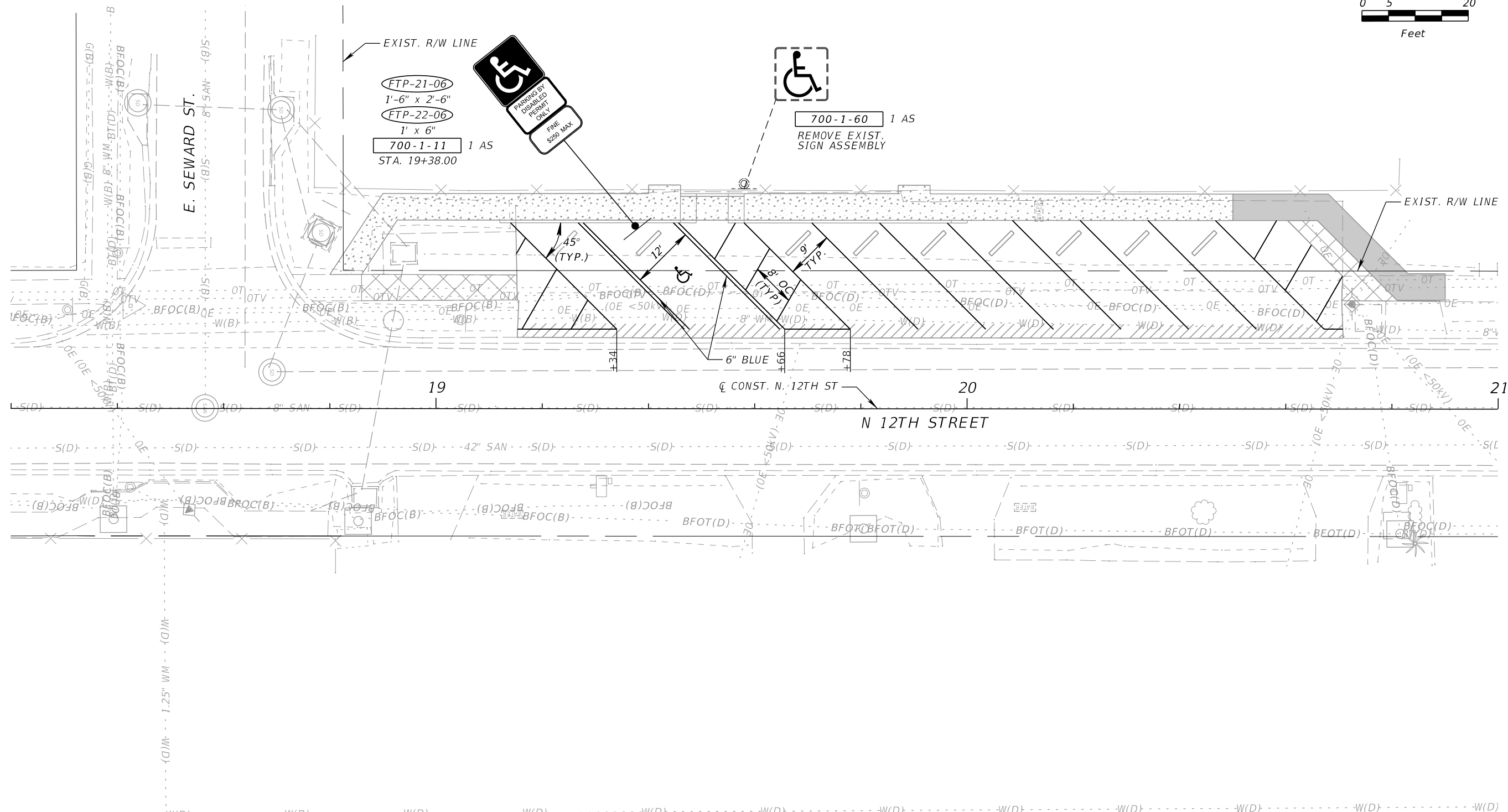
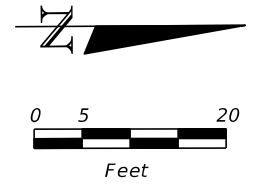

NOTES:

1. UNLESS OTHERWISE NOTED, PAVEMENT MARKINGS ARE 6" WHITE.
2. CONST. PAVEMENT MARKINGS FOR PARKING IN ACCORDANCE WITH FDOT STANDARD PLAN INDEX 711-001.

REVISIONS				MERIAM GARDNER, P.E. P.E. LICENSE NUMBER 86470 FLORIDA TRANSPORTATION ENGINEERING, INC. 11458 NORTH 53RD STREET TAMPA, FLORIDA 33617	CITY OF TAMPA MOBILITY DEPARTMENT			SIGNING AND PAVEMENT MARKING PLAN	SHEET NO.
DATE	DESCRIPTION	DATE	DESCRIPTION		STREET	COUNTY	FINANCIAL PROJECT ID		7
				12"	HILLSBOROUGH				

THE OFFICIAL RECORD OF THIS SHEET IS THE ELECTRONIC FILE DIGITALLY SIGNED AND SEALED UNDER RULE 61G15-23.004, F.A.C.

TRAFFIC CONTROL NOTES

- AS APPROVED BY THE ENGINEER, A SINGLE LANE CLOSURE MAY BE PERMITTED FOR THE PURPOSE OF SIDEWALK AND PARKING IMPROVEMENTS ON WEEKENDS ONLY OR DURING NON-SCHOOL HOURS. UTILIZE FDOT STANDARD PLAN INDEX 102-603.

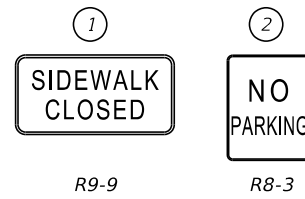

PHASING NOTES

PHASE I:

- INSTALL ADVANCE WARNING SIGNS.
- CONSTRUCT SIDEWALK AND CURB IMPROVEMENTS UTILIZING FDOT STANDARD PLAN INDEX 102-601 AND 102-660.

PHASE II:

- MILL AND RESURFACE PARKING AREA UTILIZING FDOT STANDARD PLAN INDEX 102-601 AND 102-602.
- PLACE FINAL PAVEMENT MARKINGS, SIGNS, AND REMAINING IMPROVEMENTS UTILIZING FDOT STANDARD PLAN INDEX 102-601 AND 102-602.

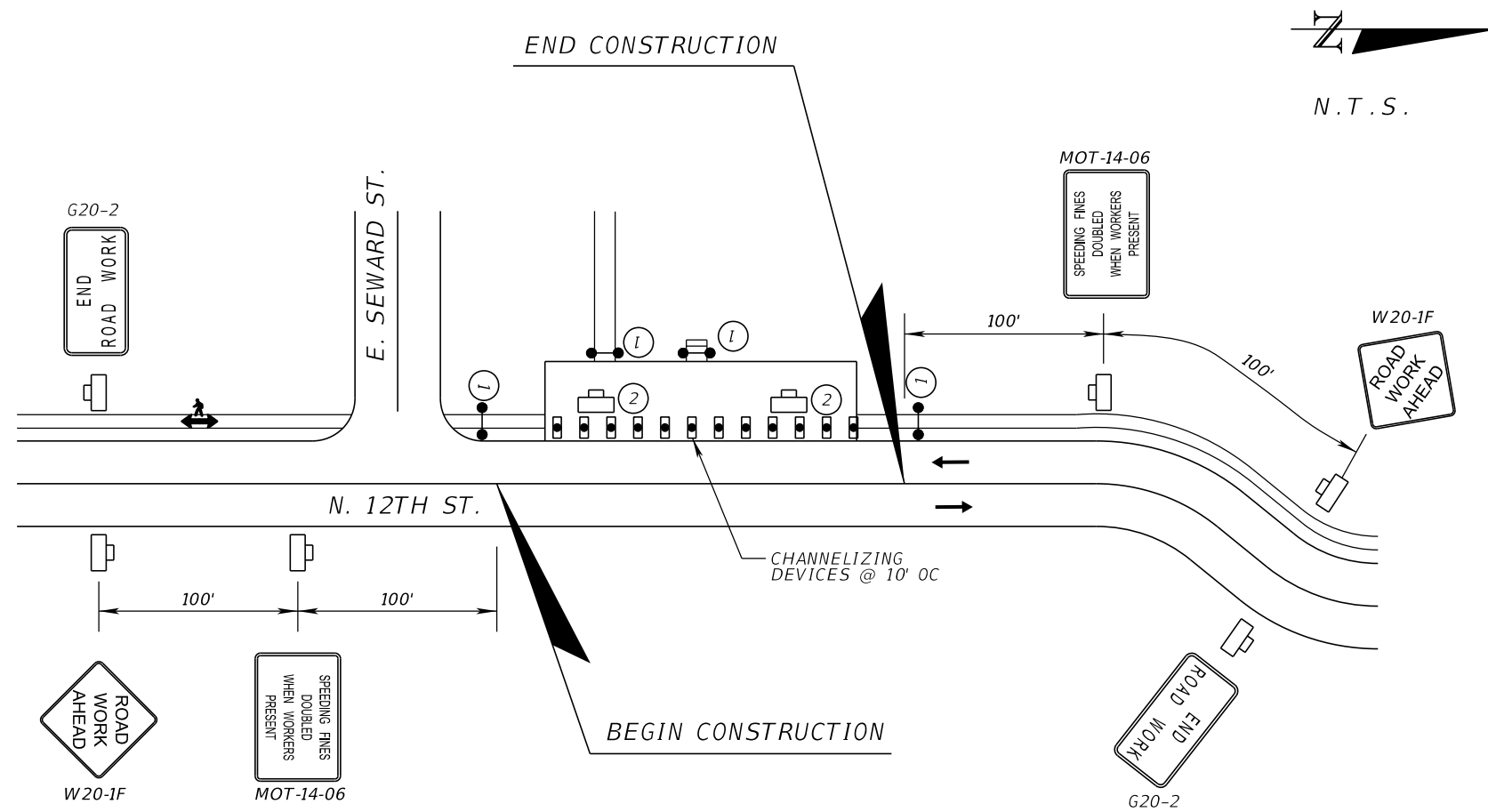

ADVANCE WARNING SIGN DIAGRAM

LEGEND

- WORK ZONE SIGN
- CHANNELIZING DEVICE
- PEDESTRIAN LONGITUDINAL CHANNELIZING DEVICE

REVISIONS				MERIAM GARDNER, P.E. P.E. LICENSE NUMBER 86470 FLORIDA TRANSPORTATION ENGINEERING, INC. 11458 NORTH 53RD STREET TAMPA, FLORIDA 33617	CITY OF TAMPA MOBILITY DEPARTMENT			TEMPORARY TRAFFIC CONTROL PLAN	SHEET NO. 8
DATE	DESCRIPTION	DATE	DESCRIPTION		STREET	COUNTY	FINANCIAL PROJECT ID		
				12 th	HILLSBOROUGH				