

STATE OF FLORIDA DEPARTMENT OF TRANSPORTATION
**TYPE 1 CATEGORICAL EXCLUSION
CHECKLIST**

650-050-12
ENVIRONMENTAL MANAGEMENT
06/17

Financial Management No. 449008-5-54-01

FAP No. Not Available

CE Number: (c) (3) or (d) ___

Title: TAMPA MULTI-MODAL NETWORK & SAFETY IMPROVEMENTS BUILD - PHASE 5

Work Mix: URBAN CORRIDOR IMPROVEMENTS

District: FDOT District 7

County: Hillsborough County

Project Description:

The City of Tampa is proposing the development of the Multi-Modal Network and Safety Improvement Project (West River District) as part of a Better Utilizing Investments to Leverage Development (BUILD) direct recipient grant awarded by Federal Highway Administration (FHWA). The project as proposed will complete the City of Tampa's remaining segments of a 12.2-mile pedestrian and bicycle facility through important multi-modal and transportation safety network improvements and create a continuous transportation route along the Hillsborough River. The multi-modal path will expand connections and provide a variety of safe mobility options for pedestrians and bicyclists between several neighborhoods and employment centers. The project proposes safer and expanded alternative transportation paths by including new pavement, guardrails, lighting, landscaping, living shorelines, and repair/replacement of seawalls as needed.

The City of Tampa Multi-Modal Network and Safety Improvement Project (West River District) consists of six phase segments of independent utility. The information included within this environmental checklist is for Phase 5: Columbus Drive from Rome Ave to North Boulevard.

The City of Tampa has presented to numerous organizations and neighborhoods as part of the community and stakeholder outreach for the West River District BUILD grant project over the last 10+ years. The planning and public involvement process began with The InVision Tampa "Tampa Center City Plan: Connecting Our Neighborhoods and Our River for Our Future".

The InVision Tampa planning team hosted a series of community knowledge exchanges and meetings, neighborhood charettes, one-on-one dialogues, I-town hall meetings, and online and social channels for greater outreach to ensure input from various audiences including traditionally marginalized communities. The most important community issues and topics that were identified included the Hillsborough River and waterfront, Center City neighborhoods, Tampa's Downtown Core, livable streets and community linkages, and transit.

Note: The items below consider the requirements described in 23 CFR § 771.117 (c) and (d) for listed Categorical Exclusions (CEs). The constraints of 23 CFR § 771.117(e) are addressed in this form for CEs identified as 23 CFR § 771.117 (c) (26), (27) and (28) or (d) list projects.

- This action **will not** induce significant impacts to planned growth or land use for the area; travel patterns; involve significant air or water quality impacts; or cause substantial controversy on environmental grounds.

Verified

1. Right of Way (ROW)

Within existing ROW

Comments:

Initial ROW Certification with Exceptions, based on the City Concept Plans, has been submitted to FHWA. The

STATE OF FLORIDA DEPARTMENT OF TRANSPORTATION
**TYPE 1 CATEGORICAL EXCLUSION
CHECKLIST**

650-050-12
ENVIRONMENTAL MANAGEMENT
06/17

final ROW Certification will be submitted for review and approval during the design.

[\[4 - 449008-5-54-01 Segment 5_SIGNED ROW Cert\]](#)

2. **Wetland impacts that would require a permit from the U.S. Army Corps of Engineers (USACE) under the Clean Water Act, Section 404, 33 U.S.C. § 1344 and/or section 10 of the Rivers and Harbors Act:**
No Wetland(s) Present/ No Impacts
Comments:
N/A
3. **Bridge permits required from the United States Coast Guard (USCG):**
No Waterway Crossing
Comments:
N/A
4. **The project involves a floodplain encroachment other than functionally dependent uses (e.g., bridges, wetlands) or actions that facilitate open space use (e.g., recreational trails, bicycle and pedestrian paths):**
Functionally Dependent Use or Facilitate Open Space Use
Comments:
N/A
- 5a. **Does the project involve a Wild and Scenic River or Study River ?**
No, the project does not involve a river designated as a Wild and Scenic, or Study River
Comments:
N/A
- 5b. **Will the action involve a river on the Nationwide Rivers Inventory (NRI)?**
No, the project will not involve a river on the NRI
Comments:
N/A
6. **Section 7 of the Endangered Species Act (ESA) of 1973, as amended, or Magnuson-Stevens Fishery Conservation and Management Act (MSFCMA):**
ESA listed species and/or Essential Fish Habitat (EFH) present
[X] Used key, no consultation required
Names of Species:
Eastern indigo snake
[X] Determination of No Effect
Names of Species:
Florida grasshopper sparrow, Wood stork, Florida scrub-jay, Audubon's Crested Caracara, Rufa Red Knot, Eastern Black Rail, Piping Plover, Florida golden aster, Florida bonamia, Pigmy fringe-tree.
Comments:
One Natural Resource Evaluation Report (NRE) was completed for all phases of the project (Phases 1 - 6) and was submitted to FHWA on October 11, 2022. It is anticipated that the project (specifically within Phase 5) will have no effect on the following federally protected species: Florida grasshopper sparrow, Wood stork, Florida scrub-jay,

STATE OF FLORIDA DEPARTMENT OF TRANSPORTATION
**TYPE 1 CATEGORICAL EXCLUSION
CHECKLIST**

650-050-12
ENVIRONMENTAL MANAGEMENT
06/17

Audubon's Crested Caracara, Rufa Red Knot, Eastern Black Rail, Piping Plover, Florida golden aster, Florida bonamia, and Pigmy fringe-tree.

It is also anticipated that the project may affect, not likely to adversely affect the following federally protected species following commitments outlined within the NRE: Eastern indigo snake.

Commitments outlined within the NRE include the following.

- The most recent version of the USFWS *Standard Protection Measures for the Eastern Indigo Snake*, will be implemented to assure that the Eastern indigo snake will not be adversely impacted by the project.
- Water quality impacts from construction will be avoided and minimized through the implementation of Best Management Practices (BMPs) including, but not limited to, construction phasing, sediment barriers, floating turbidity curtains, silt fences, and other techniques identified by the regulatory agencies during permitting.

7. Will the action impact any properties protected by Section 4(f) pursuant to 23 CFR § 774?

No potential Section 4(f) properties present

Comments:
N/A

8. Historic and/or Archaeological Resources protected under Section 106 of the National Historic Preservation Act

Determination of "No Adverse Effect"

Comments:

One Cultural Resource Assessment Survey (CRAS) was completed for all phases of the project (Phases 1 - 6). It was determined that the project will have no adverse effect on historic properties that are listed in or eligible for listing in the NRHP. The project will also not have an adverse effect on any resources within the APE that have insufficient information to determine NRHP eligibility. FDOT sent the CRAS to SHPO on June 7th, 2022 and SHPO concurred with these findings on June 15th, 2022.

[\[1 - West River District CRAS SHPO Concurrence\]](#)

9. Noise considerations

The project does not require a Noise Analysis

Comments:
N/A

10. Contamination Considerations

The project was evaluated.

Comments:

One Contamination Screening Evaluation Report (CSER) was completed for all phases of the project (Phases 1 - 6). Within Phase 5, two sites were rated as having a "Low" potential for contamination impact.

STATE OF FLORIDA DEPARTMENT OF TRANSPORTATION
**TYPE 1 CATEGORICAL EXCLUSION
CHECKLIST**

650-050-12
ENVIRONMENTAL MANAGEMENT
06/17

Prior to the start of construction, the current status of all sites identified during this evaluation will be updated by reviewing the regulatory databases. All sites that currently have active USTs and/or ASTs will be re-evaluated prior to any land acquisition.

[\[2 - West River District Technical Memorandum CSER May 2022_Final\]](#)

11. Planning Consistency

This Project was reviewed for fiscal constraint and determined to have committed, available or reasonably available funds for the implementation of all the phase(s) of the Project within the time period anticipated for completion of the Project. [23 CFR Part 450]

FHWA fully obligated BUILD funds for this project in July 2022. In accordance with the Grant Agreement, the remaining funds (local match) have been committed from the City. Therefore the project has been fully funded for construction. The project is also included in the TIP and is attached to the Type 1 CEs. The project is not currently within the LRTP.

[\[3 - TIP\]](#)

12. Project Commitment Record

[\[5 - PCR Phase 5\]](#)

STATE OF FLORIDA DEPARTMENT OF TRANSPORTATION
**TYPE 1 CATEGORICAL EXCLUSION
CHECKLIST**

650-050-12
ENVIRONMENTAL MANAGEMENT
06/17

The following is a list of any supporting activities (e.g., field reviews, as appropriate, etc.), reports, or technical studies that were prepared and are included in the project file that were necessary to support the conclusions reached on the checklist:

- 1 - West River District CRAS SHPO Concurrence [44900855401-CE1-D7-West_River_District_CRAS_SHPO_Concurrence-2022-0909.pdf](#)
- 2 - West River District Technical Memorandum CSER May 2022_Final [44900855401-CE1-D7-West_River_District_Technical_Memorandum_CSER_May_2022_Final-2022-0602.pdf](#)
- 3 - TIP [44900855401-CE1-D7-TIP-2022-1116.pdf](#)
- 4 - 449008-5-54-01 Segment 5_SIGNED ROW Cert [44900855401-CE1-D7-449008-5-54-01_Segment_5_SIGNED_ROW_Cert-2022-1116.pdf](#)
- 5 - PCR Phase 5 [44900855401-CE1-D7-PCR_Phase_5-2022-1202.pdf](#)

Based on the information presented in this document and the associated documents provided by the grantee or their designee, and based on FHWA's past experience with similar actions, FHWA has determined that actions described herein do not have a significant effect on the human or natural environment.

Signed: _____

For: Jamie Christian, PE
Division Administrator
FHWA Florida Division

Cultural Resources Assessment Survey (CRAS) SHPO Concurrence Letter



Florida Department of Transportation

RON DESANTIS
GOVERNOR

11201 North McKinley Drive
Tampa, FL 33612

JARED W. PERDUE, P.E.
SECRETARY

June 7, 2022

Timothy A. Parsons, Ph.D., Director
State Historic Preservation Officer
Florida Division of Historical Resources
500 South Bronough Street
Tallahassee, FL 32399-0250

Attention: Alyssa McManus, Transportation Compliance Review Program

**Re: Cultural Resource Assessment Survey (CRAS) for Tampa Multi-modal Network and Safety Improvements (West River District)
Financial Management No. (FMN): 449008-1 through 449008-6
Federal Aid Project No.: Not Listed**

Dear Dr. Parsons:

The City of Tampa, in coordination with Florida Department of Transportation (FDOT), District Seven, is planning the Tampa Multi-modal Network and Safety Improvements, West River District, project in Hillsborough County, Florida. The project is federally funded via a Direct Recipient BUILD Grant. The proposed project will complete the remaining segments of a 12.2-mile pedestrian and bicycle transportation route. The multi-modal path will include new pavement, guard rails, lighting, landscaping, and seawall repair or new seawall installation. All improvements are to be contained within existing right-of-way (ROW) and easements. Time extensions to two expiring existing easements are being finalized with the University of Tampa and the Tampa Hillsborough Expressway Authority.

Enclosed is one copy of the CRAS (June 2022) that was prepared for the above referenced project, two (2) Florida Master Site File (FMSF) forms (8HI11519 and 8HI15273), a Survey Log Sheet, and a CD containing an electronic version of these files.

On behalf of the City of Tampa, HNTB prepared a CRAS for the project. The purpose of the CRAS was to identify the presence of resources listed in or considered eligible for listing in the National Register of Historic Places (NRHP) according to the criteria set forth in 36 CFR 60.4 and if applicable, to apply the Criteria of Adverse Effect, as set forth in 36 CFR 800.5(a)(1) to the project. Principal Investigators meet the *Secretary of the Interior's Professional Qualification Standards* (48 FR 44716).

For the proposed West River Multi-Modal Network and Safety Improvements project the Area of Potential Effects (APE) for the archaeological survey included approximately 1.35 miles of

undeveloped corridor. The width of the survey area varied but in general, a single centrally located transect was required to provide systematic coverage of the APE. Due to the nature of the proposed project and its minimal potential direct and indirect effects to historic resources, the APE for historic resources survey was confined to the existing ROW for the approximately 1.35 miles of proposed multi-modal path.

The archaeological survey identified one new Archaeological Occurrence (AO-1). Archaeological Occurrence-1 (AO1) may contain intact buried deposits since artifacts were recovered below the disturbed Stratum I soils. As an Archaeological Occurrence, this resource was not recorded as a site and is therefore not evaluated for NRHP-eligibility. The location of a portion of previously identified site 8HI86 was revisited, but the portion within the APE is currently built environment, and no evidence of the site was identified.

Background research and the architectural field survey resulted in the identification and evaluation of three NRHP listed resources, one of which is also a locally designated resource; two previously determined eligible historic bridges; and one previously recorded linear resource. The listed resources are the Michigan Avenue Bridge (8HI00672), the Lafayette Street Bridge (8HI00640), and the overlapping NRHP and locally designated Hyde Park Historic Districts (8HI01050). The two previously determined eligible historic bridges are the Platt Street Bridge (8HI0862) and the Brorein Street Bridge (8HI11540). The previously recorded linear resource is the former Atlantic Coast Line Railroad (8HI11519). In addition, one new historic linear resource was identified, Abandoned Rail Segment (8HI5273). The portion of 8HI11519 within the APE has insufficient information to determine NRHP eligibility. The portion of 8HI15273 is considered ineligible for listing in the NRHP.

As a result of background research and the field survey, the project will have no adverse effect on historic properties that are listed in or eligible for listing in the NRHP. The property will also not have an adverse effect on the portion of 8HI11519 within the APE that has insufficient information to determine NRHP eligibility.

I am requesting your concurrence with our evaluation that the **Tampa Multi-modal Network and Safety Improvements (West River District)** project will result in a finding of *no adverse effect*.

This information is being provided in accordance with the provisions of the National Historic Preservation Act of 1966 (as amended), which are implemented by the procedures contained in 36 CFR, Part 800, as well as in accordance with the provisions contained in the revised Chapter 267, *Florida Statutes*.

The environmental review, consultation, and other actions required by applicable Federal environmental laws for this project are being, or have been, carried out by the FDOT pursuant to 23 U.S.C. § 327 and a Memorandum of Understanding dated December 14, 2016, and executed by the Federal Highway Administration (FHWA) and FDOT.

Timothy A. Parsons, Ph.D., Director
Tampa Multimodal Network and Safety Improvements
Hillsborough County, Florida
FMN.: 449008-1 through 449008-6
June 7, 2022
Page 3 of 4

If you have any questions, or if I may be of assistance, please contact me at (813) 975-6637
or crystal.geiger@dot.state.fl.us.

Sincerely,



Crystal Geiger
Environmental Specialist III
Cultural Resource Coordinator

Enclosures

cc: Robin Rhinesmith, FDOT
Sarah K. Guagnini, Atkins
Nina Mabileau, City of Tampa

Deena Woodward, FDOT OEM
Phillip Quirk, HNTB

The State Historic Preservation Officer finds the attached Cultural Resource Assessment Survey (CRAS) complete and sufficient and concurs / does not concur with the recommendations and findings in this letter for SHPO / FDHR Project File Number 2022-3633. Or, the SHPO finds the attached document contains insufficient information.

In accordance with the Programmatic Agreement among the FHWA, ACHP, FDHR, SHPO, and FDOT Regarding Implementation of the Federal-Aid Highway Program in Florida, if providing concurrence with a finding of No Historic Properties Affected for a project as a whole, or to No Adverse Effect on a specific historic property, SHPO shall proceed with a *de minimis* Section 4(f) finding at its discretion for the use of land from the historic property.

SHPO Comments:

Kelly L. Chase
DSHPO

Digitally signed by Kelly L. Chase, DSHPO
DN: cn=Kelly L. Chase, DSHPO, o, ou,
email=kelly.chase@dos.myflorida.com, c=US
Date: 2022.06.15 09:18:01 -0400

6.15.2022

Timothy A. Parsons, Ph.D., Director
Florida Division of Historical Resources

Date

*Contamination Screening Evaluation Report (CSER) Technical Memorandum
(Provided under separate cover)*

*Hillsborough County Transportation Planning Organization (TPO) Transportation
Improvement Program (TIP) Funding Documentation*

**City of Tampa
5 Year TIP
Hillsborough County, District 7**

City of Tampa

Item Number: **T1001593** Description: West Davis Bridge
 Project Length: Extra Description: This project provides for the replacement of an existing bridge at West Davis Boulevard.
 Type of Work: Bridge replacement
 NON-SIS

Fund	<2023	2023	2024	2025	2026	2027	>2027	All Years
- Managed by City of Tampa								
	\$0	\$0	\$440,000	\$440,000	\$440,000	\$0	\$0	\$1,320,000
Totals:	\$0	\$0	\$440,000	\$440,000	\$440,000	\$0	\$0	\$1,320,000
Item T1001593 Totals:	\$0	\$0	\$440,000	\$440,000	\$440,000	\$0	\$0	\$1,320,000

Item Number: **T1002096** Description: BUILD
 Project Length: Extra Description: This project provides for construction of multi-use paths along the west side of Hillsborough River (btw Platt St and Rome Ave) and through Ridgewood Park, and complete street and safety improvements on Platt St, Rome Ave, and Columbus Dr.).
 Type of Work: Trails and multi use path
 NON-SIS

Fund	<2023	2023	2024	2025	2026	2027	>2027	All Years
- Managed by City of Tampa								
	\$24,885,000	\$1,900,000	\$1,900,000	\$1,315,000	\$0	\$0	\$0	\$30,000,000
Totals:	\$24,885,000	\$1,900,000	\$1,900,000	\$1,315,000	\$0	\$0	\$0	\$30,000,000
Item T1002096 Totals:	\$24,885,000	\$1,900,000	\$1,900,000	\$1,315,000	\$0	\$0	\$0	\$30,000,000

City of Tampa Right of Way (ROW) Certificate

INITIAL DESIGN BUILD CERTIFICATION WITH EXCEPTION(S)

R/W ITEM/SEGMENT NO.: _____
CONSTRUCTION ITEM/SEGMENT NO.: 449008-5-54-01
F.A.P. NO. (Construction): _____
COUNTY: Hillsborough
LETTING DATE: _____

MANAGING DISTRICT: _____
STATE ROAD: N/A (Not Applicable)
DESCRIPTION: TAMPA MULTI-MODAL NETWORK
AND SAFETY IMPROVEMENTS BUILD - SEGMENT 5

The undersigned hereby certifies as follows:

This is an initial Design Build certification with exception(s). Additional right of way may be required for this project. All right of way to be acquired for this project shall be acquired in compliance with applicable state and federal law. Title to all property and easements needed for the above construction project is vested in the state or local government. The City has obtained sufficient authority to construct and maintain the proposed improvements on property and easements owned by state or local governments.
Further:

Acquisition

- Right of way was not acquired for this project.
- Right of way was acquired for this project in compliance with applicable state and federal law.

Relocation

- No persons or businesses were required to move or move personal property from the project right of way.
- All persons and businesses that were required to move or move personal property from the project right of way have been provided relocation assistance in compliance with applicable state and federal law.

Demolition

- No structures or improvements, including encroachments, required removal from the project right of way.
- All structures and/or improvements, including encroachments, have been removed from the project right of way in compliance with applicable state and federal law, or will be included in the construction contract.

Asbestos Abatement

- No structures or improvements requiring asbestos abatement were located on the project right of way.
- Asbestos abatement of buildings and/or structures, including those to be removed by the construction contractor, has been completed in compliance with applicable state and federal law, or will be included in the construction contract.

Submitted by Local Agency: *Janet Ross Samuels* *Danni Jorgenson* 8/11/2022
Title: City Right-of-Way & Mapping/ City Transportation Engineering Manager Date:
Coordinator

CITY OF TAMPA
INITIAL DESIGN BUILD CERTIFICATION WITH EXCEPTION(S)

Exception(s) to the above statements and time frame(s) for the exception(s) to be cleared or removed are described as follows:

- 1.) Hillsborough County has jurisdiction for the W. Columbus Drive roadway, historic bridge and right-of-way.
Hillsborough County has reviewed the City's Concept Plans. Hillsborough County will also review the proposed design or conformance with the design criteria, prior to construction activity.

- 2.) The throats of intersecting side streets are included in this rights-of-way certification.

- 3.) Demolition may include replacement of existing curb and/or driveways.

Certified by FHWA: _____
Title: FHWA Division ROW Manager Date:

FHWA's Comments:



SCALE: 1" = 400'
 REVISED: 11/02/21
 BY: bl

CITY OF
 TAMPA, FLORIDA

R/W ATLAS

SEC. 11-T29S-R18E

ATLAS NO.
 G-11

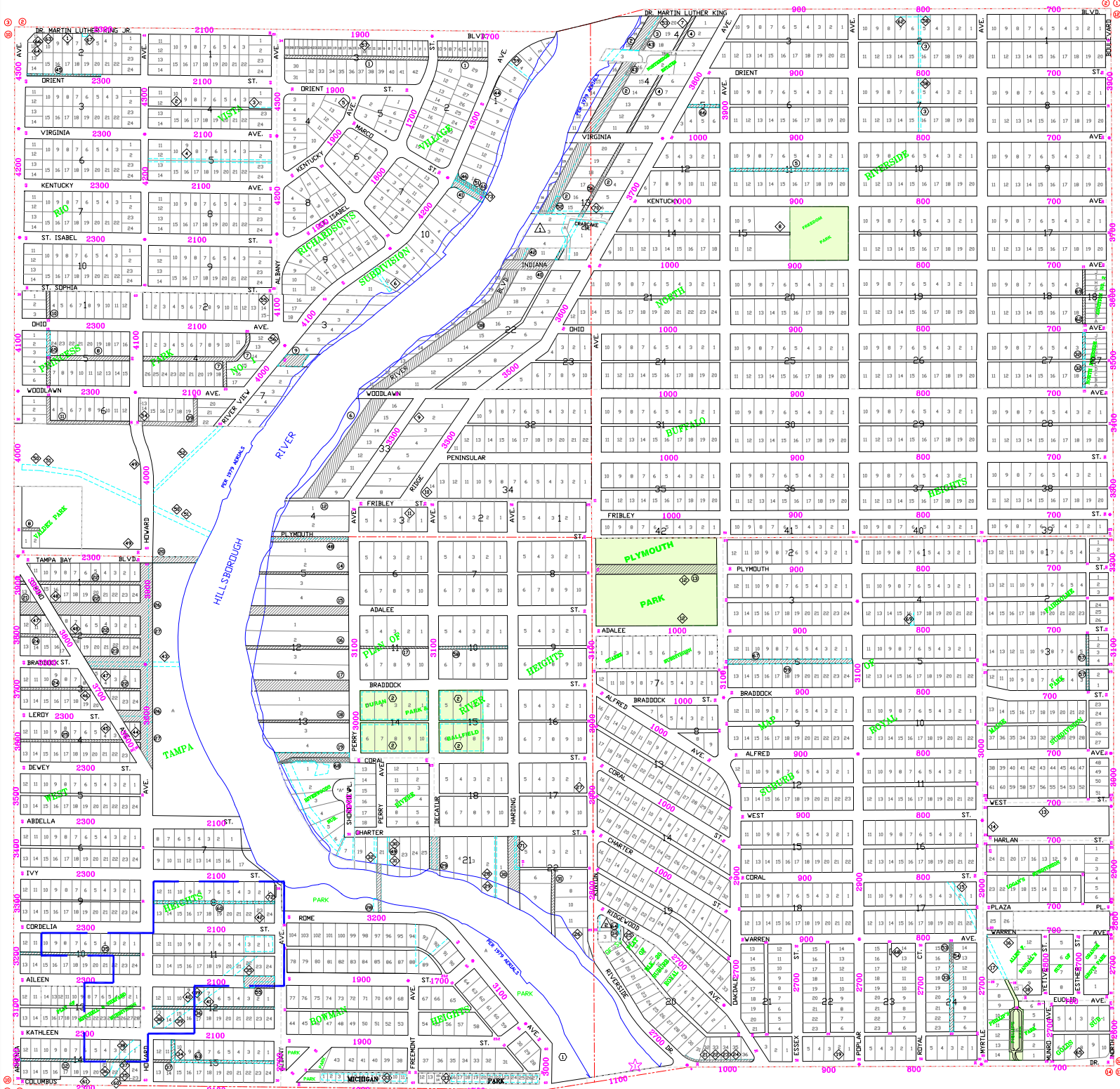

LAND USE REFERENCES

◇ VACATING OF R/W & EASEMENT

1. Ord. 17124
2. Ord. 17125
3. Ord. 17126
4. Ord. 17127
5. Ord. 17128
6. Ord. 17129
7. Ord. 17130
8. Ord. 17131
9. Ord. 17132
10. Ord. 17133
11. Ord. 17134
12. Ord. 17135
13. Ord. 17136
14. Ord. 17137
15. Ord. 17138
16. Ord. 17139
17. Ord. 17140
18. Ord. 17141
19. Ord. 17142
20. Ord. 17143
21. Ord. 17144
22. Ord. 17145
23. Ord. 17146
24. Ord. 17147
25. Ord. 17148
26. Ord. 17149
27. Ord. 17150
28. Ord. 17151
29. Ord. 17152
30. Ord. 17153
31. Ord. 17154
32. Ord. 17155
33. Ord. 17156
34. Ord. 17157
35. Ord. 17158
36. Ord. 17159
37. Ord. 17160
38. Ord. 17161
39. Ord. 17162
40. Ord. 17163
41. Ord. 17164
42. Ord. 17165
43. Ord. 17166
44. Ord. 17167
45. Ord. 17168
46. Ord. 17169
47. Ord. 17170
48. Ord. 17171
49. Ord. 17172
50. Ord. 17173
51. Ord. 17174
52. Ord. 17175
53. Ord. 17176
54. Ord. 17177
55. Ord. 17178
56. Ord. 17179
57. Ord. 17180
58. Ord. 17181
59. Ord. 17182
60. Ord. 17183
61. Ord. 17184
62. Ord. 17185
63. Ord. 17186
64. Ord. 17187
65. Ord. 17188
66. Ord. 17189
67. Ord. 17190
68. Ord. 17191
69. Ord. 17192
70. Ord. 17193
71. Ord. 17194
72. Ord. 17195
73. Ord. 17196
74. Ord. 17197
75. Ord. 17198
76. Ord. 17199
77. Ord. 17200
78. Ord. 17201
79. Ord. 17202
80. Ord. 17203
81. Ord. 17204
82. Ord. 17205
83. Ord. 17206
84. Ord. 17207
85. Ord. 17208
86. Ord. 17209
87. Ord. 17210
88. Ord. 17211
89. Ord. 17212
90. Ord. 17213
91. Ord. 17214
92. Ord. 17215
93. Ord. 17216
94. Ord. 17217
95. Ord. 17218
96. Ord. 17219
97. Ord. 17220
98. Ord. 17221
99. Ord. 17222
100. Ord. 17223

◇ ACQUISITIONS OF R/W & EASEMENT

1. Ord. 17224
2. Ord. 17225
3. Ord. 17226
4. Ord. 17227
5. Ord. 17228
6. Ord. 17229
7. Ord. 17230
8. Ord. 17231
9. Ord. 17232
10. Ord. 17233
11. Ord. 17234
12. Ord. 17235
13. Ord. 17236
14. Ord. 17237
15. Ord. 17238
16. Ord. 17239
17. Ord. 17240
18. Ord. 17241
19. Ord. 17242
20. Ord. 17243
21. Ord. 17244
22. Ord. 17245
23. Ord. 17246
24. Ord. 17247
25. Ord. 17248
26. Ord. 17249
27. Ord. 17250
28. Ord. 17251
29. Ord. 17252
30. Ord. 17253
31. Ord. 17254
32. Ord. 17255
33. Ord. 17256
34. Ord. 17257
35. Ord. 17258
36. Ord. 17259
37. Ord. 17260
38. Ord. 17261
39. Ord. 17262
40. Ord. 17263
41. Ord. 17264
42. Ord. 17265
43. Ord. 17266
44. Ord. 17267
45. Ord. 17268
46. Ord. 17269
47. Ord. 17270
48. Ord. 17271
49. Ord. 17272
50. Ord. 17273
51. Ord. 17274
52. Ord. 17275
53. Ord. 17276
54. Ord. 17277
55. Ord. 17278
56. Ord. 17279
57. Ord. 17280
58. Ord. 17281
59. Ord. 17282
60. Ord. 17283
61. Ord. 17284
62. Ord. 17285
63. Ord. 17286
64. Ord. 17287
65. Ord. 17288
66. Ord. 17289
67. Ord. 17290
68. Ord. 17291
69. Ord. 17292
70. Ord. 17293
71. Ord. 17294
72. Ord. 17295
73. Ord. 17296
74. Ord. 17297
75. Ord. 17298
76. Ord. 17299
77. Ord. 17300
78. Ord. 17301
79. Ord. 17302
80. Ord. 17303
81. Ord. 17304
82. Ord. 17305
83. Ord. 17306
84. Ord. 17307
85. Ord. 17308
86. Ord. 17309
87. Ord. 17310
88. Ord. 17311
89. Ord. 17312
90. Ord. 17313
91. Ord. 17314
92. Ord. 17315
93. Ord. 17316
94. Ord. 17317
95. Ord. 17318
96. Ord. 17319
97. Ord. 17320
98. Ord. 17321
99. Ord. 17322
100. Ord. 17323

◇ CITY PROPERTIES

1. Ord. 17324
2. Ord. 17325
3. Ord. 17326
4. Ord. 17327
5. Ord. 17328
6. Ord. 17329
7. Ord. 17330
8. Ord. 17331
9. Ord. 17332
10. Ord. 17333
11. Ord. 17334
12. Ord. 17335
13. Ord. 17336
14. Ord. 17337
15. Ord. 17338
16. Ord. 17339
17. Ord. 17340
18. Ord. 17341
19. Ord. 17342
20. Ord. 17343
21. Ord. 17344
22. Ord. 17345
23. Ord. 17346
24. Ord. 17347
25. Ord. 17348
26. Ord. 17349
27. Ord. 17350
28. Ord. 17351
29. Ord. 17352
30. Ord. 17353
31. Ord. 17354
32. Ord. 17355
33. Ord. 17356
34. Ord. 17357
35. Ord. 17358
36. Ord. 17359
37. Ord. 17360
38. Ord. 17361
39. Ord. 17362
40. Ord. 17363
41. Ord. 17364
42. Ord. 17365
43. Ord. 17366
44. Ord. 17367
45. Ord. 17368
46. Ord. 17369
47. Ord. 17370
48. Ord. 17371
49. Ord. 17372
50. Ord. 17373
51. Ord. 17374
52. Ord. 17375
53. Ord. 17376
54. Ord. 17377
55. Ord. 17378
56. Ord. 17379
57. Ord. 17380
58. Ord. 17381
59. Ord. 17382
60. Ord. 17383
61. Ord. 17384
62. Ord. 17385
63. Ord. 17386
64. Ord. 17387
65. Ord. 17388
66. Ord. 17389
67. Ord. 17390
68. Ord. 17391
69. Ord. 17392
70. Ord. 17393
71. Ord. 17394
72. Ord. 17395
73. Ord. 17396
74. Ord. 17397
75. Ord. 17398
76. Ord. 17399
77. Ord. 17400
78. Ord. 17401
79. Ord. 17402
80. Ord. 17403
81. Ord. 17404
82. Ord. 17405
83. Ord. 17406
84. Ord. 17407
85. Ord. 17408
86. Ord. 17409
87. Ord. 17410
88. Ord. 17411
89. Ord. 17412
90. Ord. 17413
91. Ord. 17414
92. Ord. 17415
93. Ord. 17416
94. Ord. 17417
95. Ord. 17418
96. Ord. 17419
97. Ord. 17420
98. Ord. 17421
99. Ord. 17422
100. Ord. 17423

◇ SMALL SUBDIVISIONS

1. Ord. 17424
2. Ord. 17425
3. Ord. 17426
4. Ord. 17427
5. Ord. 17428
6. Ord. 17429
7. Ord. 17430
8. Ord. 17431
9. Ord. 17432
10. Ord. 17433
11. Ord. 17434
12. Ord. 17435
13. Ord. 17436
14. Ord. 17437
15. Ord. 17438
16. Ord. 17439
17. Ord. 17440
18. Ord. 17441
19. Ord. 17442
20. Ord. 17443
21. Ord. 17444
22. Ord. 17445
23. Ord. 17446
24. Ord. 17447
25. Ord. 17448
26. Ord. 17449
27. Ord. 17450
28. Ord. 17451
29. Ord. 17452
30. Ord. 17453
31. Ord. 17454
32. Ord. 17455
33. Ord. 17456
34. Ord. 17457
35. Ord. 17458
36. Ord. 17459
37. Ord. 17460
38. Ord. 17461
39. Ord. 17462
40. Ord. 17463
41. Ord. 17464
42. Ord. 17465
43. Ord. 17466
44. Ord. 17467
45. Ord. 17468
46. Ord. 17469
47. Ord. 17470
48. Ord. 17471
49. Ord. 17472
50. Ord. 17473
51. Ord. 17474
52. Ord. 17475
53. Ord. 17476
54. Ord. 17477
55. Ord. 17478
56. Ord. 17479
57. Ord. 17480
58. Ord. 17481
59. Ord. 17482
60. Ord. 17483
61. Ord. 17484
62. Ord. 17485
63. Ord. 17486
64. Ord. 17487
65. Ord. 17488
66. Ord. 17489
67. Ord. 17490
68. Ord. 17491
69. Ord. 17492
70. Ord. 17493
71. Ord. 17494
72. Ord. 17495
73. Ord. 17496
74. Ord. 17497
75. Ord. 17498
76. Ord. 17499
77. Ord. 17500
78. Ord. 17501
79. Ord. 17502
80. Ord. 17503
81. Ord. 17504
82. Ord. 17505
83. Ord. 17506
84. Ord. 17507
85. Ord. 17508
86. Ord. 17509
87. Ord. 17510
88. Ord. 17511
89. Ord. 17512
90. Ord. 17513
91. Ord. 17514
92. Ord. 17515
93. Ord. 17516
94. Ord. 17517
95. Ord. 17518
96. Ord. 17519
97. Ord. 17520
98. Ord. 17521
99. Ord. 17522
100. Ord. 17523

NOTE:

IT IS INTENDED THAT THE ACCURACY OF THIS MAP COMPLY WITH U.S. NATIONAL MAP ACCURACY STANDARDS. HOWEVER, THE CITY MAKES NO WARRANTY, EXPRESSED OR IMPLIED, AS TO THE ACCURACY OF THE DETAILS SHOWN ON THIS MAP OR OF THE REPRODUCTION THEREOF.

ORIGINAL MAPS ARE THE PROPERTY OF THE CITY OF TAMPA AND ARE NOT FOR REPRODUCTION IN PART OR ENTIRETY IN ANY FORM BY OTHERS UNLESS SPECIFICALLY AUTHORIZED BY THE CITY.

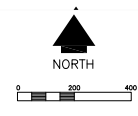



LAND USE REFERENCES

VACUATIONS OF R/W & EASEMENT

1. Ord. 4487-A
2. Ord. 4501-A
3. Ord. 4502-A
4. Ord. 4503-A
5. Ord. 4504-A
6. Ord. 4505-A
7. Ord. 4506-A
8. Ord. 4507-A
9. Ord. 4508-A
10. Ord. 4509-A
11. Ord. 4510-A
12. Ord. 4511-A
13. Ord. 4512-A
14. Ord. 4513-A
15. Ord. 4514-A
16. Ord. 4515-A
17. Ord. 4516-A
18. Ord. 4517-A
19. Ord. 4518-A
20. Ord. 4519-A
21. Ord. 4520-A
22. Ord. 4521-A
23. Ord. 4522-A
24. Ord. 4523-A
25. Ord. 4524-A
26. Ord. 4525-A
27. Ord. 4526-A
28. Ord. 4527-A
29. Ord. 4528-A
30. Ord. 4529-A
31. Ord. 4530-A
32. Ord. 4531-A
33. Ord. 4532-A
34. Ord. 4533-A
35. Ord. 4534-A
36. Ord. 4535-A
37. Ord. 4536-A
38. Ord. 4537-A
39. Ord. 4538-A
40. Ord. 4539-A
41. Ord. 4540-A
42. Ord. 4541-A
43. Ord. 4542-A
44. Ord. 4543-A
45. Ord. 4544-A
46. Ord. 4545-A
47. Ord. 4546-A
48. Ord. 4547-A
49. Ord. 4548-A
50. Ord. 4549-A
51. Ord. 4550-A
52. Ord. 4551-A
53. Ord. 4552-A
54. Ord. 4553-A
55. Ord. 4554-A
56. Ord. 4555-A
57. Ord. 4556-A
58. Ord. 4557-A
59. Ord. 4558-A
60. Ord. 4559-A
61. Ord. 4560-A
62. Ord. 4561-A
63. Ord. 4562-A
64. Ord. 4563-A
65. Ord. 4564-A
66. Ord. 4565-A
67. Ord. 4566-A
68. Ord. 4567-A
69. Ord. 4568-A
70. Ord. 4569-A
71. Ord. 4570-A
72. Ord. 4571-A
73. Ord. 4572-A
74. Ord. 4573-A
75. Ord. 4574-A
76. Ord. 4575-A
77. Ord. 4576-A
78. Ord. 4577-A
79. Ord. 4578-A
80. Ord. 4579-A
81. Ord. 4580-A
82. Ord. 4581-A
83. Ord. 4582-A
84. Ord. 4583-A
85. Ord. 4584-A
86. Ord. 4585-A
87. Ord. 4586-A
88. Ord. 4587-A
89. Ord. 4588-A
90. Ord. 4589-A
91. Ord. 4590-A
92. Ord. 4591-A
93. Ord. 4592-A
94. Ord. 4593-A
95. Ord. 4594-A
96. Ord. 4595-A
97. Ord. 4596-A
98. Ord. 4597-A
99. Ord. 4598-A
100. Ord. 4599-A
101. Ord. 4600-A

ACQUISITIONS OF R/W & EASEMENT

1. Ord. 4601-A
2. Ord. 4602-A
3. Ord. 4603-A
4. Ord. 4604-A
5. Ord. 4605-A
6. Ord. 4606-A
7. Ord. 4607-A
8. Ord. 4608-A
9. Ord. 4609-A
10. Ord. 4610-A
11. Ord. 4611-A
12. Ord. 4612-A
13. Ord. 4613-A
14. Ord. 4614-A
15. Ord. 4615-A
16. Ord. 4616-A
17. Ord. 4617-A
18. Ord. 4618-A
19. Ord. 4619-A
20. Ord. 4620-A
21. Ord. 4621-A
22. Ord. 4622-A
23. Ord. 4623-A
24. Ord. 4624-A
25. Ord. 4625-A
26. Ord. 4626-A
27. Ord. 4627-A
28. Ord. 4628-A
29. Ord. 4629-A
30. Ord. 4630-A
31. Ord. 4631-A
32. Ord. 4632-A
33. Ord. 4633-A
34. Ord. 4634-A
35. Ord. 4635-A
36. Ord. 4636-A
37. Ord. 4637-A
38. Ord. 4638-A
39. Ord. 4639-A
40. Ord. 4640-A
41. Ord. 4641-A
42. Ord. 4642-A
43. Ord. 4643-A
44. Ord. 4644-A
45. Ord. 4645-A
46. Ord. 4646-A
47. Ord. 4647-A
48. Ord. 4648-A
49. Ord. 4649-A
50. Ord. 4650-A
51. Ord. 4651-A
52. Ord. 4652-A
53. Ord. 4653-A
54. Ord. 4654-A
55. Ord. 4655-A
56. Ord. 4656-A
57. Ord. 4657-A
58. Ord. 4658-A
59. Ord. 4659-A
60. Ord. 4660-A
61. Ord. 4661-A
62. Ord. 4662-A
63. Ord. 4663-A
64. Ord. 4664-A
65. Ord. 4665-A
66. Ord. 4666-A
67. Ord. 4667-A
68. Ord. 4668-A
69. Ord. 4669-A
70. Ord. 4670-A
71. Ord. 4671-A
72. Ord. 4672-A
73. Ord. 4673-A
74. Ord. 4674-A
75. Ord. 4675-A
76. Ord. 4676-A
77. Ord. 4677-A
78. Ord. 4678-A
79. Ord. 4679-A
80. Ord. 4680-A
81. Ord. 4681-A
82. Ord. 4682-A
83. Ord. 4683-A
84. Ord. 4684-A
85. Ord. 4685-A
86. Ord. 4686-A
87. Ord. 4687-A
88. Ord. 4688-A
89. Ord. 4689-A
90. Ord. 4690-A
91. Ord. 4691-A
92. Ord. 4692-A
93. Ord. 4693-A
94. Ord. 4694-A
95. Ord. 4695-A
96. Ord. 4696-A
97. Ord. 4697-A
98. Ord. 4698-A
99. Ord. 4699-A
100. Ord. 4700-A

CITY PROPERTIES

1. Ord. 4701-A
2. Ord. 4702-A
3. Ord. 4703-A
4. Ord. 4704-A
5. Ord. 4705-A
6. Ord. 4706-A
7. Ord. 4707-A
8. Ord. 4708-A
9. Ord. 4709-A
10. Ord. 4710-A
11. Ord. 4711-A
12. Ord. 4712-A
13. Ord. 4713-A
14. Ord. 4714-A
15. Ord. 4715-A
16. Ord. 4716-A
17. Ord. 4717-A
18. Ord. 4718-A
19. Ord. 4719-A
20. Ord. 4720-A
21. Ord. 4721-A
22. Ord. 4722-A
23. Ord. 4723-A
24. Ord. 4724-A
25. Ord. 4725-A
26. Ord. 4726-A
27. Ord. 4727-A
28. Ord. 4728-A
29. Ord. 4729-A
30. Ord. 4730-A
31. Ord. 4731-A
32. Ord. 4732-A
33. Ord. 4733-A
34. Ord. 4734-A
35. Ord. 4735-A
36. Ord. 4736-A
37. Ord. 4737-A
38. Ord. 4738-A
39. Ord. 4739-A
40. Ord. 4740-A
41. Ord. 4741-A
42. Ord. 4742-A
43. Ord. 4743-A
44. Ord. 4744-A
45. Ord. 4745-A
46. Ord. 4746-A
47. Ord. 4747-A
48. Ord. 4748-A
49. Ord. 4749-A
50. Ord. 4750-A
51. Ord. 4751-A
52. Ord. 4752-A
53. Ord. 4753-A
54. Ord. 4754-A
55. Ord. 4755-A
56. Ord. 4756-A
57. Ord. 4757-A
58. Ord. 4758-A
59. Ord. 4759-A
60. Ord. 4760-A
61. Ord. 4761-A
62. Ord. 4762-A
63. Ord. 4763-A
64. Ord. 4764-A
65. Ord. 4765-A
66. Ord. 4766-A
67. Ord. 4767-A
68. Ord. 4768-A
69. Ord. 4769-A
70. Ord. 4770-A
71. Ord. 4771-A
72. Ord. 4772-A
73. Ord. 4773-A
74. Ord. 4774-A
75. Ord. 4775-A
76. Ord. 4776-A
77. Ord. 4777-A
78. Ord. 4778-A
79. Ord. 4779-A
80. Ord. 4780-A
81. Ord. 4781-A
82. Ord. 4782-A
83. Ord. 4783-A
84. Ord. 4784-A
85. Ord. 4785-A
86. Ord. 4786-A
87. Ord. 4787-A
88. Ord. 4788-A
89. Ord. 4789-A
90. Ord. 4790-A
91. Ord. 4791-A
92. Ord. 4792-A
93. Ord. 4793-A
94. Ord. 4794-A
95. Ord. 4795-A
96. Ord. 4796-A
97. Ord. 4797-A
98. Ord. 4798-A
99. Ord. 4799-A
100. Ord. 4800-A

SMALL SUBDIVISIONS

1. Ord. 4801-A
2. Ord. 4802-A
3. Ord. 4803-A
4. Ord. 4804-A
5. Ord. 4805-A
6. Ord. 4806-A
7. Ord. 4807-A
8. Ord. 4808-A
9. Ord. 4809-A
10. Ord. 4810-A
11. Ord. 4811-A
12. Ord. 4812-A
13. Ord. 4813-A
14. Ord. 4814-A
15. Ord. 4815-A
16. Ord. 4816-A
17. Ord. 4817-A
18. Ord. 4818-A
19. Ord. 4819-A
20. Ord. 4820-A
21. Ord. 4821-A
22. Ord. 4822-A
23. Ord. 4823-A
24. Ord. 4824-A
25. Ord. 4825-A
26. Ord. 4826-A
27. Ord. 4827-A
28. Ord. 4828-A
29. Ord. 4829-A
30. Ord. 4830-A
31. Ord. 4831-A
32. Ord. 4832-A
33. Ord. 4833-A
34. Ord. 4834-A
35. Ord. 4835-A
36. Ord. 4836-A
37. Ord. 4837-A
38. Ord. 4838-A
39. Ord. 4839-A
40. Ord. 4840-A
41. Ord. 4841-A
42. Ord. 4842-A
43. Ord. 4843-A
44. Ord. 4844-A
45. Ord. 4845-A
46. Ord. 4846-A
47. Ord. 4847-A
48. Ord. 4848-A
49. Ord. 4849-A
50. Ord. 4850-A
51. Ord. 4851-A
52. Ord. 4852-A
53. Ord. 4853-A
54. Ord. 4854-A
55. Ord. 4855-A
56. Ord. 4856-A
57. Ord. 4857-A
58. Ord. 4858-A
59. Ord. 4859-A
60. Ord. 4860-A
61. Ord. 4861-A
62. Ord. 4862-A
63. Ord. 4863-A
64. Ord. 4864-A
65. Ord. 4865-A
66. Ord. 4866-A
67. Ord. 4867-A
68. Ord. 4868-A
69. Ord. 4869-A
70. Ord. 4870-A
71. Ord. 4871-A
72. Ord. 4872-A
73. Ord. 4873-A
74. Ord. 4874-A
75. Ord. 4875-A
76. Ord. 4876-A
77. Ord. 4877-A
78. Ord. 4878-A
79. Ord. 4879-A
80. Ord. 4880-A
81. Ord. 4881-A
82. Ord. 4882-A
83. Ord. 4883-A
84. Ord. 4884-A
85. Ord. 4885-A
86. Ord. 4886-A
87. Ord. 4887-A
88. Ord. 4888-A
89. Ord. 4889-A
90. Ord. 4890-A
91. Ord. 4891-A
92. Ord. 4892-A
93. Ord. 4893-A
94. Ord. 4894-A
95. Ord. 4895-A
96. Ord. 4896-A
97. Ord. 4897-A
98. Ord. 4898-A
99. Ord. 4899-A
100. Ord. 4900-A

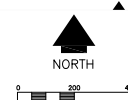

NOTE:
 IT IS INTENDED THAT THE ACCURACY OF THIS MAP COMPLY WITH U.S. NATIONAL MAP ACCURACY STANDARDS. HOWEVER, THE CITY MAKES NO WARRANTY, EXPRESSED OR IMPLIED, AS TO THE ACCURACY OF THE DETAILS SHOWN ON THIS MAP OR OF THE REPRODUCTION THEREOF.
 ORIGINAL MAPS ARE THE PROPERTY OF THE CITY OF TAMPA AND ARE NOT FOR REPRODUCTION IN PART OR ENTIRETY IN ANY FORM BY OTHERS UNLESS SPECIFICALLY AUTHORIZED BY THE CITY.

Local Historic District National Historic District

 CITY OF TAMPA, FLORIDA
 R/W ATLAS
 SEC. 12-T29S-R18E
 ATLAS NO. G-12

SCALE: 1" = 400'
 REVISED: 6/29/22
 BY: BL



SCALE: 1" = 400'
 REVISED: 8/9/22
 BY: BL

CITY OF
 TAMPA, FLORIDA

R/W ATLAS

SEC. 14-T29S-R18E

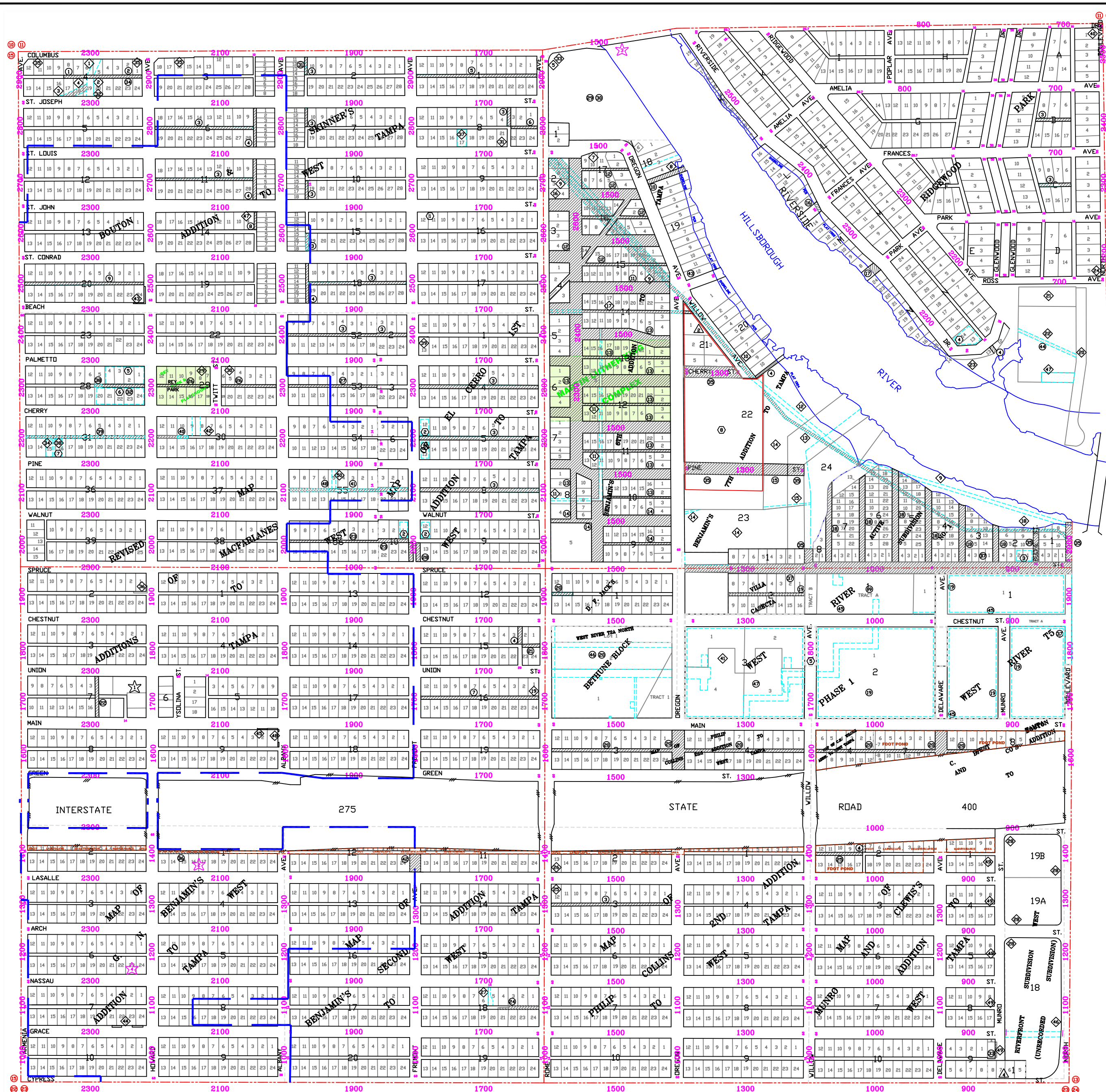

LAND USE REFERENCES

- VACATINGS OF R/W & EASEMENT
1. Ord. 2786-A
 2. Ord. 2787-A
 3. Ord. 2812-A
 4. Ord. 2813-A
 5. Ord. 2814-A
 6. Ord. 2815-A
 7. Ord. 2816-A
 8. Ord. 2817-A
 9. Ord. 2818-A
 10. Ord. 2819-A
 11. Ord. 2820-A
 12. Ord. 2821-A
 13. Ord. 2822-A
 14. Ord. 2823-A
 15. Ord. 2824-A
 16. Ord. 2825-A
 17. Ord. 2826-A
 18. Ord. 2827-A
 19. Ord. 2828-A
 20. Ord. 2829-A
 21. Ord. 2830-A
 22. Ord. 2831-A
 23. Ord. 2832-A
 24. Ord. 2833-A
 25. Ord. 2834-A
 26. Ord. 2835-A
 27. Ord. 2836-A
 28. Ord. 2837-A
 29. Ord. 2838-A
 30. Ord. 2839-A
 31. Ord. 2840-A
 32. Ord. 2841-A
 33. Ord. 2842-A
 34. Ord. 2843-A
 35. Ord. 2844-A
 36. Ord. 2845-A
 37. Ord. 2846-A
 38. Ord. 2847-A
 39. Ord. 2848-A
 40. Ord. 2849-A
 41. Ord. 2850-A
 42. Ord. 2851-A
 43. Ord. 2852-A
 44. Ord. 2853-A
 45. Ord. 2854-A
 46. Ord. 2855-A
 47. Ord. 2856-A
 48. Ord. 2857-A
 49. Ord. 2858-A
 50. Ord. 2859-A
 51. Ord. 2860-A
 52. Ord. 2861-A
 53. Ord. 2862-A
 54. Ord. 2863-A
 55. Ord. 2864-A
 56. Ord. 2865-A
 57. Ord. 2866-A
 58. Ord. 2867-A
 59. Ord. 2868-A
 60. Ord. 2869-A
 61. Ord. 2870-A
 62. Ord. 2871-A
 63. Ord. 2872-A
 64. Ord. 2873-A
 65. Ord. 2874-A
 66. Ord. 2875-A
 67. Ord. 2876-A
 68. Ord. 2877-A
 69. Ord. 2878-A
 70. Ord. 2879-A
 71. Ord. 2880-A
 72. Ord. 2881-A
 73. Ord. 2882-A
 74. Ord. 2883-A
 75. Ord. 2884-A
 76. Ord. 2885-A
 77. Ord. 2886-A
 78. Ord. 2887-A
 79. Ord. 2888-A
 80. Ord. 2889-A
 81. Ord. 2890-A
 82. Ord. 2891-A
 83. Ord. 2892-A
 84. Ord. 2893-A
 85. Ord. 2894-A
 86. Ord. 2895-A
 87. Ord. 2896-A
 88. Ord. 2897-A
 89. Ord. 2898-A
 90. Ord. 2899-A
 91. Ord. 2900-A

◇ ACQUISITIONS OF R/W & EASEMENT

1. Ord. 2007-177
2. Ord. 2007-178
3. Ord. 2007-179
4. Ord. 2007-180
5. Ord. 2007-181
6. Ord. 2007-182
7. Ord. 2007-183
8. Ord. 2007-184
9. Ord. 2007-185
10. Ord. 2007-186
11. Ord. 2007-187
12. Ord. 2007-188
13. Ord. 2007-189
14. Ord. 2007-190
15. Ord. 2007-191
16. Ord. 2007-192
17. Ord. 2007-193
18. Ord. 2007-194
19. Ord. 2007-195
20. Ord. 2007-196
21. Ord. 2007-197
22. Ord. 2007-198
23. Ord. 2007-199
24. Ord. 2007-200
25. Ord. 2007-201
26. Ord. 2007-202
27. Ord. 2007-203
28. Ord. 2007-204
29. Ord. 2007-205
30. Ord. 2007-206
31. Ord. 2007-207
32. Ord. 2007-208
33. Ord. 2007-209
34. Ord. 2007-210
35. Ord. 2007-211
36. Ord. 2007-212
37. Ord. 2007-213
38. Ord. 2007-214
39. Ord. 2007-215
40. Ord. 2007-216
41. Ord. 2007-217
42. Ord. 2007-218
43. Ord. 2007-219
44. Ord. 2007-220
45. Ord. 2007-221
46. Ord. 2007-222
47. Ord. 2007-223
48. Ord. 2007-224
49. Ord. 2007-225
50. Ord. 2007-226
51. Ord. 2007-227
52. Ord. 2007-228
53. Ord. 2007-229
54. Ord. 2007-230
55. Ord. 2007-231
56. Ord. 2007-232
57. Ord. 2007-233
58. Ord. 2007-234
59. Ord. 2007-235
60. Ord. 2007-236
61. Ord. 2007-237
62. Ord. 2007-238
63. Ord. 2007-239
64. Ord. 2007-240
65. Ord. 2007-241
66. Ord. 2007-242
67. Ord. 2007-243
68. Ord. 2007-244
69. Ord. 2007-245
70. Ord. 2007-246
71. Ord. 2007-247
72. Ord. 2007-248
73. Ord. 2007-249
74. Ord. 2007-250
75. Ord. 2007-251
76. Ord. 2007-252
77. Ord. 2007-253
78. Ord. 2007-254
79. Ord. 2007-255
80. Ord. 2007-256
81. Ord. 2007-257
82. Ord. 2007-258
83. Ord. 2007-259
84. Ord. 2007-260
85. Ord. 2007-261
86. Ord. 2007-262
87. Ord. 2007-263
88. Ord. 2007-264
89. Ord. 2007-265
90. Ord. 2007-266
91. Ord. 2007-267
92. Ord. 2007-268
93. Ord. 2007-269
94. Ord. 2007-270
95. Ord. 2007-271
96. Ord. 2007-272
97. Ord. 2007-273
98. Ord. 2007-274
99. Ord. 2007-275
100. Ord. 2007-276
101. Ord. 2007-277
102. Ord. 2007-278
103. Ord. 2007-279
104. Ord. 2007-280
105. Ord. 2007-281
106. Ord. 2007-282
107. Ord. 2007-283
108. Ord. 2007-284
109. Ord. 2007-285
110. Ord. 2007-286
111. Ord. 2007-287
112. Ord. 2007-288
113. Ord. 2007-289
114. Ord. 2007-290
115. Ord. 2007-291
116. Ord. 2007-292
117. Ord. 2007-293
118. Ord. 2007-294
119. Ord. 2007-295
120. Ord. 2007-296
121. Ord. 2007-297
122. Ord. 2007-298
123. Ord. 2007-299
124. Ord. 2007-300

○ CITY PROPERTIES

1. Ord. 1619-048
2. Ord. 1619-049
3. Ord. 1619-050
4. Ord. 1619-051
5. Ord. 1619-052
6. Ord. 1619-053
7. Ord. 1619-054
8. Ord. 1619-055
9. Ord. 1619-056
10. Ord. 1619-057
11. Ord. 1619-058
12. Ord. 1619-059
13. Ord. 1619-060
14. Ord. 1619-061
15. Ord. 1619-062
16. Ord. 1619-063
17. Ord. 1619-064
18. Ord. 1619-065
19. Ord. 1619-066
20. Ord. 1619-067
21. Ord. 1619-068
22. Ord. 1619-069
23. Ord. 1619-070
24. Ord. 1619-071
25. Ord. 1619-072
26. Ord. 1619-073
27. Ord. 1619-074
28. Ord. 1619-075
29. Ord. 1619-076
30. Ord. 1619-077
31. Ord. 1619-078
32. Ord. 1619-079
33. Ord. 1619-080
34. Ord. 1619-081
35. Ord. 1619-082
36. Ord. 1619-083
37. Ord. 1619-084
38. Ord. 1619-085
39. Ord. 1619-086
40. Ord. 1619-087
41. Ord. 1619-088
42. Ord. 1619-089
43. Ord. 1619-090
44. Ord. 2007-152
45. Ord. 2007-153
46. Ord. 2007-154
47. Ord. 2007-155
48. Ord. 2007-156
49. Ord. 2007-157
50. Ord. 2007-158
51. Ord. 2007-159
52. Ord. 2007-160
53. Ord. 2007-161
54. Ord. 2007-162
55. Ord. 2007-163
56. Ord. 2007-164
57. Ord. 2007-165
58. Ord. 2007-166
59. Ord. 2007-167
60. Ord. 2007-168
61. Ord. 2007-169
62. Ord. 2007-170
63. Ord. 2007-171
64. Ord. 2007-172
65. Ord. 2007-173
66. Ord. 2007-174
67. Ord. 2007-175
68. Ord. 2007-176
69. Ord. 2007-177
70. Ord. 2007-178
71. Ord. 2007-179
72. Ord. 2007-180
73. Ord. 2007-181
74. Ord. 2007-182
75. Ord. 2007-183
76. Ord. 2007-184
77. Ord. 2007-185
78. Ord. 2007-186
79. Ord. 2007-187
80. Ord. 2007-188
81. Ord. 2007-189
82. Ord. 2007-190
83. Ord. 2007-191
84. Ord. 2007-192
85. Ord. 2007-193
86. Ord. 2007-194
87. Ord. 2007-195
88. Ord. 2007-196
89. Ord. 2007-197
90. Ord. 2007-198
91. Ord. 2007-199
92. Ord. 2007-200
93. Ord. 2007-201
94. Ord. 2007-202
95. Ord. 2007-203
96. Ord. 2007-204
97. Ord. 2007-205
98. Ord. 2007-206
99. Ord. 2007-207
100. Ord. 2007-208
101. Ord. 2007-209
102. Ord. 2007-210
103. Ord. 2007-211
104. Ord. 2007-212
105. Ord. 2007-213
106. Ord. 2007-214
107. Ord. 2007-215
108. Ord. 2007-216
109. Ord. 2007-217
110. Ord. 2007-218
111. Ord. 2007-219
112. Ord. 2007-220
113. Ord. 2007-221
114. Ord. 2007-222
115. Ord. 2007-223
116. Ord. 2007-224
117. Ord. 2007-225
118. Ord. 2007-226
119. Ord. 2007-227
120. Ord. 2007-228
121. Ord. 2007-229
122. Ord. 2007-230
123. Ord. 2007-231
124. Ord. 2007-232
125. Ord. 2007-233
126. Ord. 2007-234
127. Ord. 2007-235
128. Ord. 2007-236
129. Ord. 2007-237
130. Ord. 2007-238
131. Ord. 2007-239
132. Ord. 2007-240
133. Ord. 2007-241
134. Ord. 2007-242
135. Ord. 2007-243
136. Ord. 2007-244
137. Ord. 2007-245
138. Ord. 2007-246
139. Ord. 2007-247
140. Ord. 2007-248
141. Ord. 2007-249
142. Ord. 2007-250
143. Ord. 2007-251
144. Ord. 2007-252
145. Ord. 2007-253
146. Ord. 2007-254
147. Ord. 2007-255
148. Ord. 2007-256
149. Ord. 2007-257
150. Ord. 2007-258
151. Ord. 2007-259
152. Ord. 2007-260
153. Ord. 2007-261
154. Ord. 2007-262
155. Ord. 2007-263
156. Ord. 2007-264
157. Ord. 2007-265
158. Ord. 2007-266
159. Ord. 2007-267
160. Ord. 2007-268
161. Ord. 2007-269
162. Ord. 2007-270
163. Ord. 2007-271
164. Ord. 2007-272
165. Ord. 2007-273
166. Ord. 2007-274
167. Ord. 2007-275
168. Ord. 2007-276
169. Ord. 2007-277
170. Ord. 2007-278
171. Ord. 2007-279
172. Ord. 2007-280
173. Ord. 2007-281
174. Ord. 2007-282
175. Ord. 2007-283
176. Ord. 2007-284
177. Ord. 2007-285
178. Ord. 2007-286
179. Ord. 2007-287
180. Ord. 2007-288
181. Ord. 2007-289
182. Ord. 2007-290
183. Ord. 2007-291
184. Ord. 2007-292
185. Ord. 2007-293
186. Ord. 2007-294
187. Ord. 2007-295
188. Ord. 2007-296
189. Ord. 2007-297
190. Ord. 2007-298
191. Ord. 2007-299
192. Ord. 2007-300

△ SMALL SUBDIVISIONS

1. DR. G. GOLDSTEIN'S
2. A SUBDIVISION OF BLOCK 21 OF BENJAMIN'S 7TH ADDITION TO TAMPA
3. J.W. CARROLL'S SUBDIVISION
4. PART OF KINKLE'S SUBDIVISION TO WEST TAMPA
5. VILLA CABRERA & MAP OF DR. BOUTON AND CO'S ADDN TO W. TAMPA

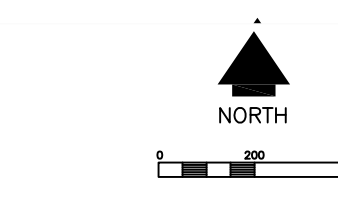

NOTE:
 IT IS INTENDED THAT THE ACCURACY OF THIS MAP COMPLY WITH U.S. NATIONAL MAP ACCURACY STANDARDS. HOWEVER, THE CITY MAKES NO WARRANTY, EXPRESSED OR IMPLIED, AS TO THE ACCURACY OF THE DETAILS SHOWN ON THIS MAP OR OF THE REPRODUCTION THEREOF.
 ORIGINAL MAPS ARE THE PROPERTY OF THE CITY OF TAMPA AND ARE NOT FOR REPRODUCTION IN PART OR ENTIRETY IN ANY FORM BY OTHERS UNLESS SPECIFICALLY AUTHORIZED BY THE CITY.



SCALE: 1" = 400'
 REVISED: 8/18/22
 bl

CITY OF
 TAMPA, FLORIDA
 R/W ATLAS

SEC. 13-T29S-R18E

R/W ATLAS



LAND USE REFERENCES

- VACATIONS OF R/W & EASEMENT**
- 1. Ord. 3174-A
 - 2. Ord. 1472-A
 - 3. Ord. 3097-A
 - 4. Ord. 98-52
 - 5. Ord. 77-6
 - 6. Ord. 05-18
 - 7. Ord. 05-19
 - 8. Ord. 05-20
 - 9. Ord. 05-21
 - 10. Ord. 05-22
 - 11. Ord. 05-23
 - 12. Ord. 05-24
 - 13. Ord. 05-25
 - 14. Ord. 05-26
 - 15. Ord. 05-27
 - 16. Ord. 05-28
 - 17. Ord. 05-29
 - 18. Ord. 05-30
 - 19. Ord. 05-31
 - 20. Ord. 05-32
 - 21. Ord. 05-33
 - 22. Ord. 05-34
 - 23. Ord. 05-35
 - 24. Ord. 05-36
 - 25. Ord. 05-37
 - 26. Ord. 05-38
 - 27. Ord. 05-39
 - 28. Ord. 05-40
 - 29. Ord. 05-41
 - 30. Ord. 05-42
 - 31. Ord. 05-43
 - 32. Ord. 05-44
 - 33. Ord. 05-45
 - 34. Ord. 05-46
 - 35. Ord. 05-47
 - 36. Ord. 05-48
 - 37. Ord. 05-49
 - 38. Ord. 05-50
 - 39. Ord. 05-51
 - 40. Ord. 05-52
 - 41. Ord. 05-53
 - 42. Ord. 05-54
 - 43. Ord. 95-2152
 - 44. Ord. 95-2153
 - 45. Ord. 2010-01
 - 46. Ord. 2010-02
 - 47. Ord. 2010-03
 - 48. Ord. 2010-04
 - 49. Ord. 2010-05
 - 50. Ord. 2010-06
 - 51. Ord. 2010-07
 - 52. Ord. 2010-08
 - 53. Ord. 2010-09
 - 54. Ord. 2010-10
 - 55. Ord. 2010-11
 - 56. Ord. 2010-12
 - 57. Ord. 2011-01
 - 58. Ord. 2011-02
 - 59. Ord. 2011-03
 - 60. Ord. 2011-04
 - 61. Ord. 2011-05
 - 62. Ord. 2011-06
 - 63. Ord. 2011-07
 - 64. Ord. 2011-08
 - 65. Ord. 2011-09
 - 66. Ord. 2011-10
 - 67. Ord. 2011-11
 - 68. Ord. 2011-12
 - 69. Ord. 2012-01
 - 70. Ord. 2012-02
 - 71. Ord. 2012-03
 - 72. Ord. 2012-04
 - 73. Ord. 2012-05
 - 74. Ord. 2012-06
 - 75. Ord. 2012-07
 - 76. Ord. 2012-08
 - 77. Ord. 2012-09
 - 78. Ord. 2012-10
 - 79. Ord. 2012-11
 - 80. Ord. 2012-12
 - 81. Ord. 2013-01
 - 82. Ord. 2013-02
 - 83. Ord. 2013-03
 - 84. Ord. 2013-04
 - 85. Ord. 2013-05
 - 86. Ord. 2013-06
 - 87. Ord. 2013-07
 - 88. Ord. 2013-08
 - 89. Ord. 2013-09
 - 90. Ord. 2013-10
 - 91. Ord. 2013-11
 - 92. Ord. 2013-12
 - 93. Ord. 2014-01
 - 94. Ord. 2014-02
 - 95. Ord. 2014-03
 - 96. Ord. 2014-04
 - 97. Ord. 2014-05
 - 98. Ord. 2014-06
 - 99. Ord. 2014-07
 - 100. Ord. 2014-08

ACQUISITIONS OF R/W & EASEMENT

- 1. Ord. 2745-A
- 2. Ord. 3098-A
- 3. Ord. 3102-A
- 4. Ord. 3106-A
- 5. Ord. 3110-A
- 6. Ord. 3114-A
- 7. Ord. 3118-A
- 8. Ord. 3122-A
- 9. Ord. 3126-A
- 10. Ord. 3130-A
- 11. Ord. 3134-A
- 12. Ord. 3138-A
- 13. Ord. 3142-A
- 14. Ord. 3146-A
- 15. Ord. 3150-A
- 16. Ord. 3154-A
- 17. Ord. 3158-A
- 18. Ord. 3162-A
- 19. Ord. 3166-A
- 20. Ord. 3170-A
- 21. Ord. 3174-A
- 22. Ord. 3178-A
- 23. Ord. 3182-A
- 24. Ord. 3186-A
- 25. Ord. 3190-A
- 26. Ord. 3194-A
- 27. Ord. 3198-A
- 28. Ord. 3202-A
- 29. Ord. 3206-A
- 30. Ord. 3210-A
- 31. Ord. 3214-A
- 32. Ord. 3218-A
- 33. Ord. 3222-A
- 34. Ord. 3226-A
- 35. Ord. 3230-A
- 36. Ord. 3234-A
- 37. Ord. 3238-A
- 38. Ord. 3242-A
- 39. Ord. 3246-A
- 40. Ord. 3250-A
- 41. Ord. 3254-A
- 42. Ord. 3258-A
- 43. Ord. 3262-A
- 44. Ord. 3266-A
- 45. Ord. 3270-A
- 46. Ord. 3274-A
- 47. Ord. 3278-A
- 48. Ord. 3282-A
- 49. Ord. 3286-A
- 50. Ord. 3290-A
- 51. Ord. 3294-A
- 52. Ord. 3298-A
- 53. Ord. 3302-A
- 54. Ord. 3306-A
- 55. Ord. 3310-A
- 56. Ord. 3314-A
- 57. Ord. 3318-A
- 58. Ord. 3322-A
- 59. Ord. 3326-A
- 60. Ord. 3330-A
- 61. Ord. 3334-A
- 62. Ord. 3338-A
- 63. Ord. 3342-A
- 64. Ord. 3346-A
- 65. Ord. 3350-A
- 66. Ord. 3354-A
- 67. Ord. 3358-A
- 68. Ord. 3362-A
- 69. Ord. 3366-A
- 70. Ord. 3370-A
- 71. Ord. 3374-A
- 72. Ord. 3378-A
- 73. Ord. 3382-A
- 74. Ord. 3386-A
- 75. Ord. 3390-A
- 76. Ord. 3394-A
- 77. Ord. 3398-A
- 78. Ord. 3402-A
- 79. Ord. 3406-A
- 80. Ord. 3410-A
- 81. Ord. 3414-A
- 82. Ord. 3418-A
- 83. Ord. 3422-A
- 84. Ord. 3426-A
- 85. Ord. 3430-A
- 86. Ord. 3434-A
- 87. Ord. 3438-A
- 88. Ord. 3442-A
- 89. Ord. 3446-A
- 90. Ord. 3450-A
- 91. Ord. 3454-A
- 92. Ord. 3458-A
- 93. Ord. 3462-A
- 94. Ord. 3466-A
- 95. Ord. 3470-A
- 96. Ord. 3474-A
- 97. Ord. 3478-A
- 98. Ord. 3482-A
- 99. Ord. 3486-A
- 100. Ord. 3490-A

CITY PROPERTIES

- 1. Ord. 8697-D
- 2. Ord. 8701-D
- 3. Ord. 8705-D
- 4. Ord. 8709-D
- 5. Ord. 8713-D
- 6. Ord. 8717-D
- 7. Ord. 8721-D
- 8. Ord. 8725-D
- 9. Ord. 8729-D
- 10. Ord. 8733-D
- 11. Ord. 8737-D
- 12. Ord. 8741-D
- 13. Ord. 8745-D
- 14. Ord. 8749-D
- 15. Ord. 8753-D
- 16. Ord. 8757-D
- 17. Ord. 8761-D
- 18. Ord. 8765-D
- 19. Ord. 8769-D
- 20. Ord. 8773-D
- 21. Ord. 8777-D
- 22. Ord. 8781-D
- 23. Ord. 8785-D
- 24. Ord. 8789-D
- 25. Ord. 8793-D
- 26. Ord. 8797-D
- 27. Ord. 8801-D
- 28. Ord. 8805-D
- 29. Ord. 8809-D
- 30. Ord. 8813-D
- 31. Ord. 8817-D
- 32. Ord. 8821-D
- 33. Ord. 8825-D
- 34. Ord. 8829-D
- 35. Ord. 8833-D
- 36. Ord. 8837-D
- 37. Ord. 8841-D
- 38. Ord. 8845-D
- 39. Ord. 8849-D
- 40. Ord. 8853-D
- 41. Ord. 8857-D
- 42. Ord. 8861-D
- 43. Ord. 8865-D
- 44. Ord. 8869-D
- 45. Ord. 8873-D
- 46. Ord. 8877-D
- 47. Ord. 8881-D
- 48. Ord. 8885-D
- 49. Ord. 8889-D
- 50. Ord. 8893-D
- 51. Ord. 8897-D
- 52. Ord. 8901-D
- 53. Ord. 8905-D
- 54. Ord. 8909-D
- 55. Ord. 8913-D
- 56. Ord. 8917-D
- 57. Ord. 8921-D
- 58. Ord. 8925-D
- 59. Ord. 8929-D
- 60. Ord. 8933-D
- 61. Ord. 8937-D
- 62. Ord. 8941-D
- 63. Ord. 8945-D
- 64. Ord. 8949-D
- 65. Ord. 8953-D
- 66. Ord. 8957-D
- 67. Ord. 8961-D
- 68. Ord. 8965-D
- 69. Ord. 8969-D
- 70. Ord. 8973-D
- 71. Ord. 8977-D
- 72. Ord. 8981-D
- 73. Ord. 8985-D
- 74. Ord. 8989-D
- 75. Ord. 8993-D
- 76. Ord. 8997-D
- 77. Ord. 9001-D
- 78. Ord. 9005-D
- 79. Ord. 9009-D
- 80. Ord. 9013-D
- 81. Ord. 9017-D
- 82. Ord. 9021-D
- 83. Ord. 9025-D
- 84. Ord. 9029-D
- 85. Ord. 9033-D
- 86. Ord. 9037-D
- 87. Ord. 9041-D
- 88. Ord. 9045-D
- 89. Ord. 9049-D
- 90. Ord. 9053-D
- 91. Ord. 9057-D
- 92. Ord. 9061-D
- 93. Ord. 9065-D
- 94. Ord. 9069-D
- 95. Ord. 9073-D
- 96. Ord. 9077-D
- 97. Ord. 9081-D
- 98. Ord. 9085-D
- 99. Ord. 9089-D
- 100. Ord. 9093-D

SMALL SUBDIVISIONS

- 1. H.L. MITCHELL'S SUBDIVISION
- 2. SUBDIVISION OF LOTS 4 AND 5 OF BLOCK 7 OF BEAZ ADDITION TO GILBERT'S SUBDIVISION
- 3. D.L. FRANKLIN'S SUBDIVISION
- 4. JAMES S. WALKER'S SUBDIVISION
- 5. PLAN OF NEWCOMB'S SUBDIVISION
- 6. AND STREET EXTENSION SUBDIVISION
- 7. B.M. D. WALKER'S SUBDIVISION
- 8. DOMESTIC'S SUBDIVISION
- 9. PLAN OF WALKER'S SUBDIVISION
- 10. PLAN OF B.M. D. WALKER'S SUBDIVISION
- 11. MAP OF B.M. D. WALKER'S ADDITION TO FT. BROOK
- 12. ENCLOSURE NO. 18
- 13. FRANKLIN STREET CITY LOTS
- 14. ENCLOSURE NO. 18
- 15. HEIGHTS OF TAMPA
- 16. DALL SUBDIVISION
- 17. DALL SUBDIVISION
- 18. WEST RIVER 12

NOTE:
 IT IS INTENDED THAT THE ACCURACY OF THIS MAP COMPLY WITH U.S. NATIONAL MAP ACCURACY STANDARDS. HOWEVER, THE CITY MAKES NO WARRANTY, EXPRESSED OR IMPLIED, AS TO THE ACCURACY OF THE DETAILS SHOWN ON THIS MAP OR OF THE REPRODUCTION THEREOF.
 ORIGINAL MAPS ARE THE PROPERTY OF THE CITY OF TAMPA AND ARE NOT FOR REPRODUCTION IN PART OR ENTIRETY IN ANY FORM BY OTHERS UNLESS SPECIFICALLY AUTHORIZED BY THE CITY.

----- National Historic District

Project Commitment Record

